

3.4.7. GE ADÃO

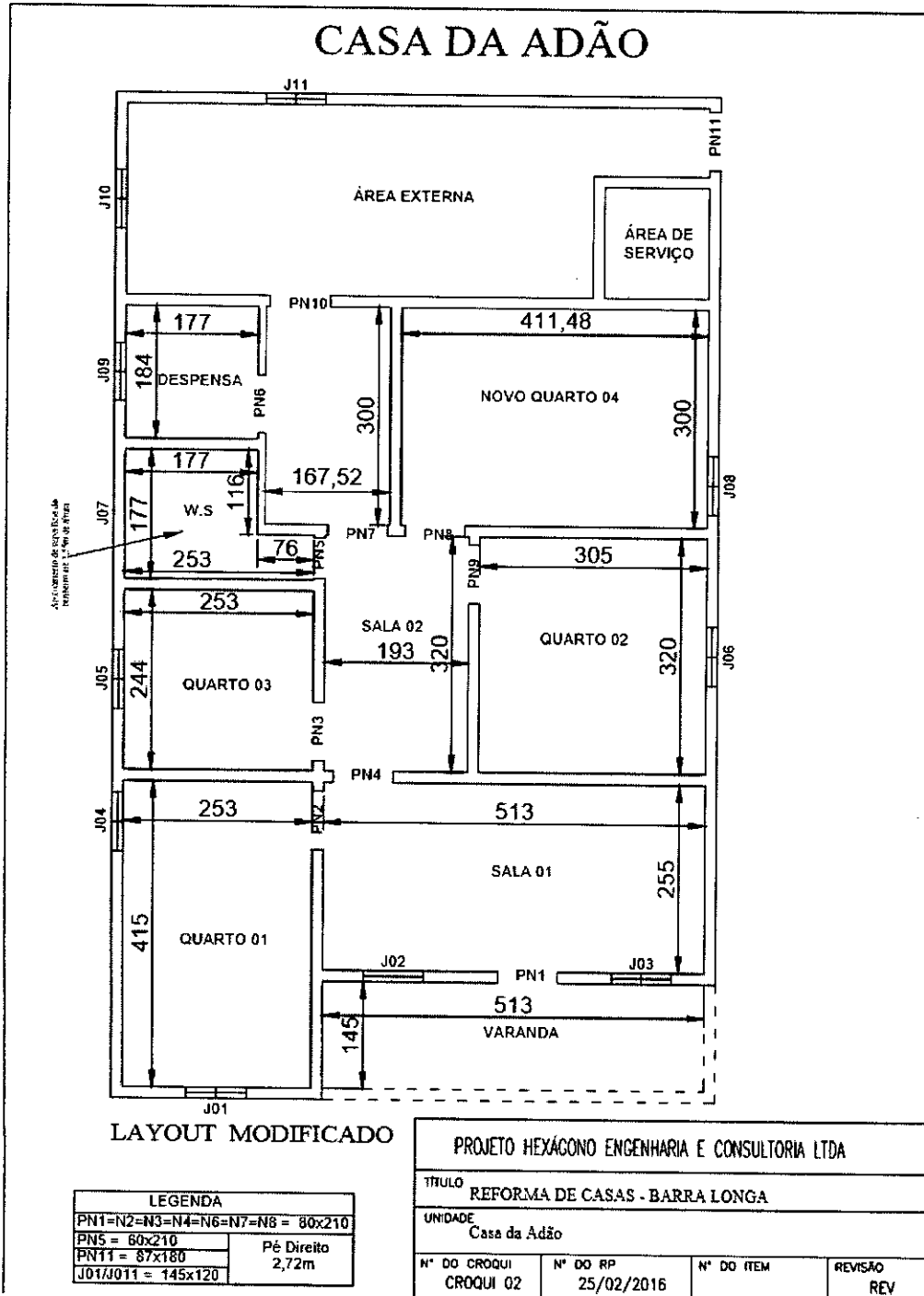

EM BRANCO

3.4.8. GE CRISTIANO

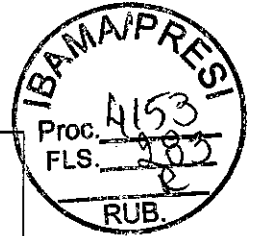
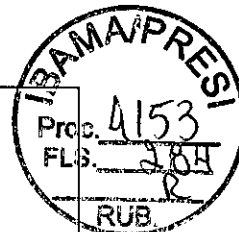

Casa do Cristiano

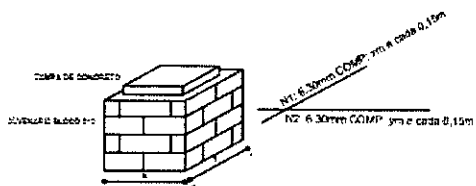
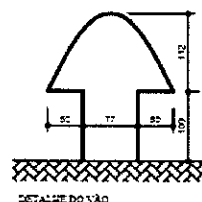
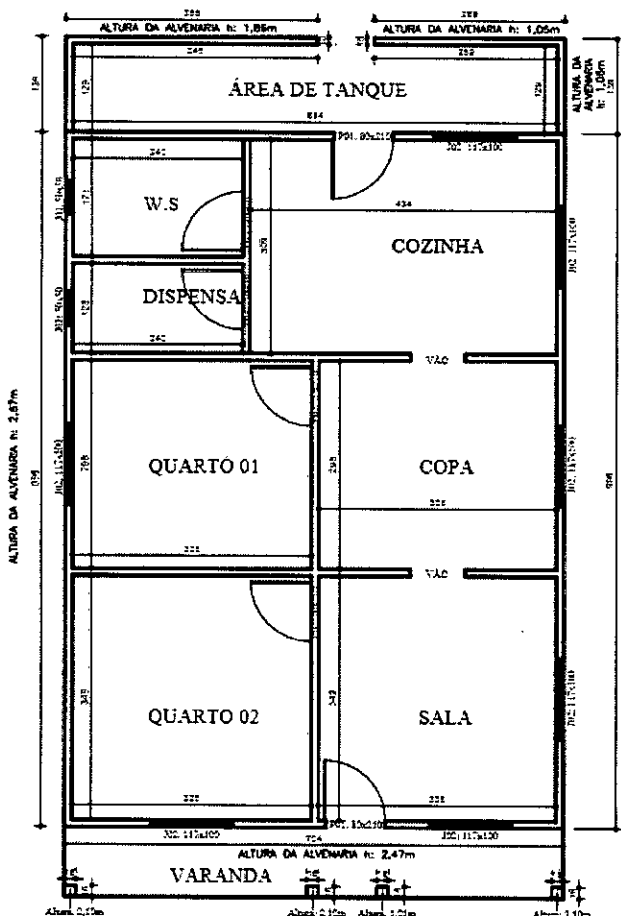

PROJETO HEXÁGONO ENGENHARIA E CONSULTORIA LTDA			
TÍTULO REFORMA DE CASAS - BARRA LONGA			
UNIDADE Casa do Cristiano			
Nº DO CROQUI CROQUI 01	Nº DO RP	Nº DO ITEM	REVISÃO REV

MEMBRANCO

MEMBRANCO

EM BRANCO

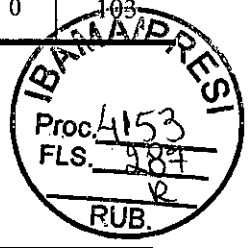

3.4.11. GE JOÃO PAULO

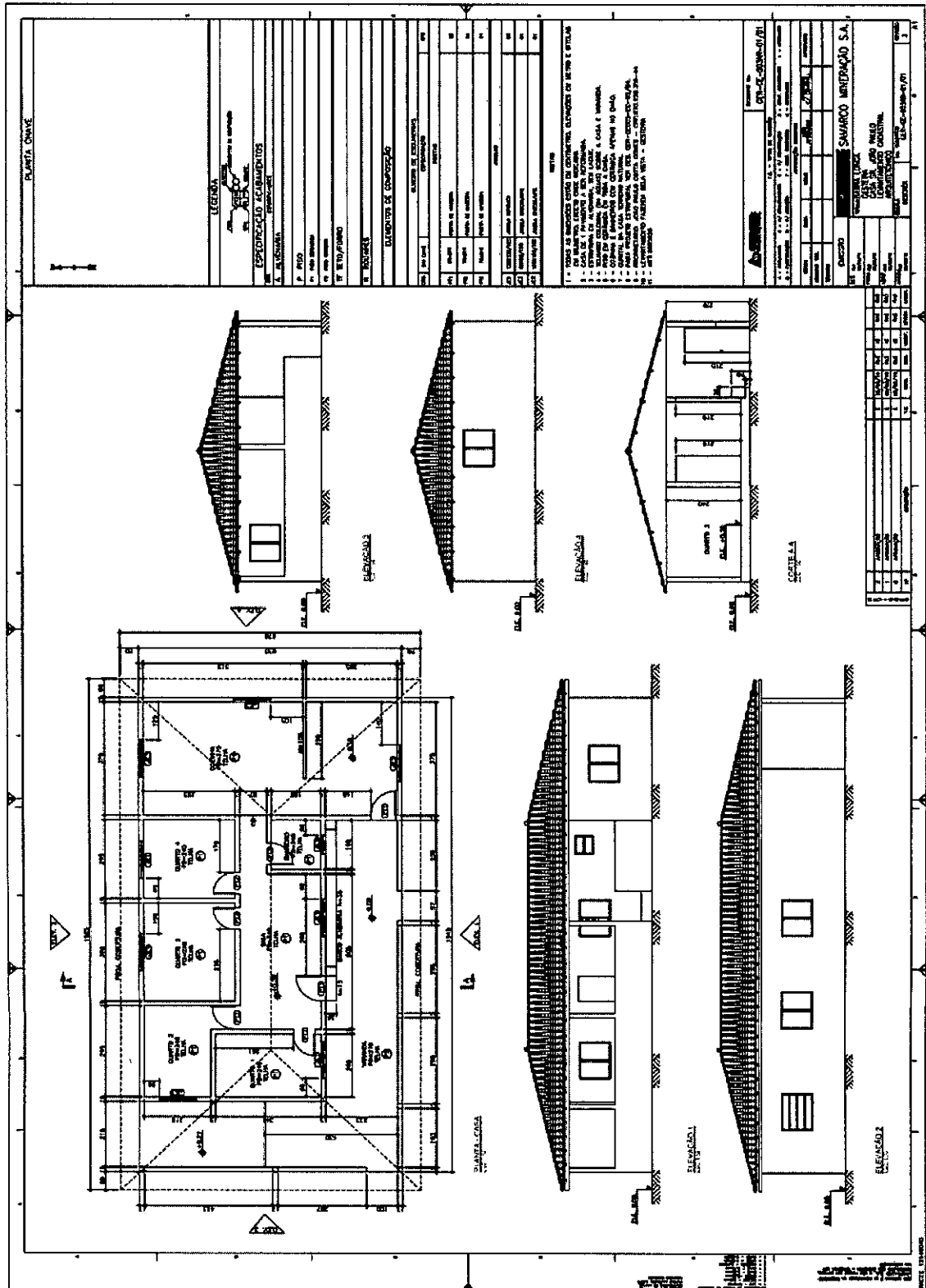

EMBRANCO

4. OBRAS PÚBLICAS

4.1. PRAÇA MANOEL LINO MOL E ALAMEDA

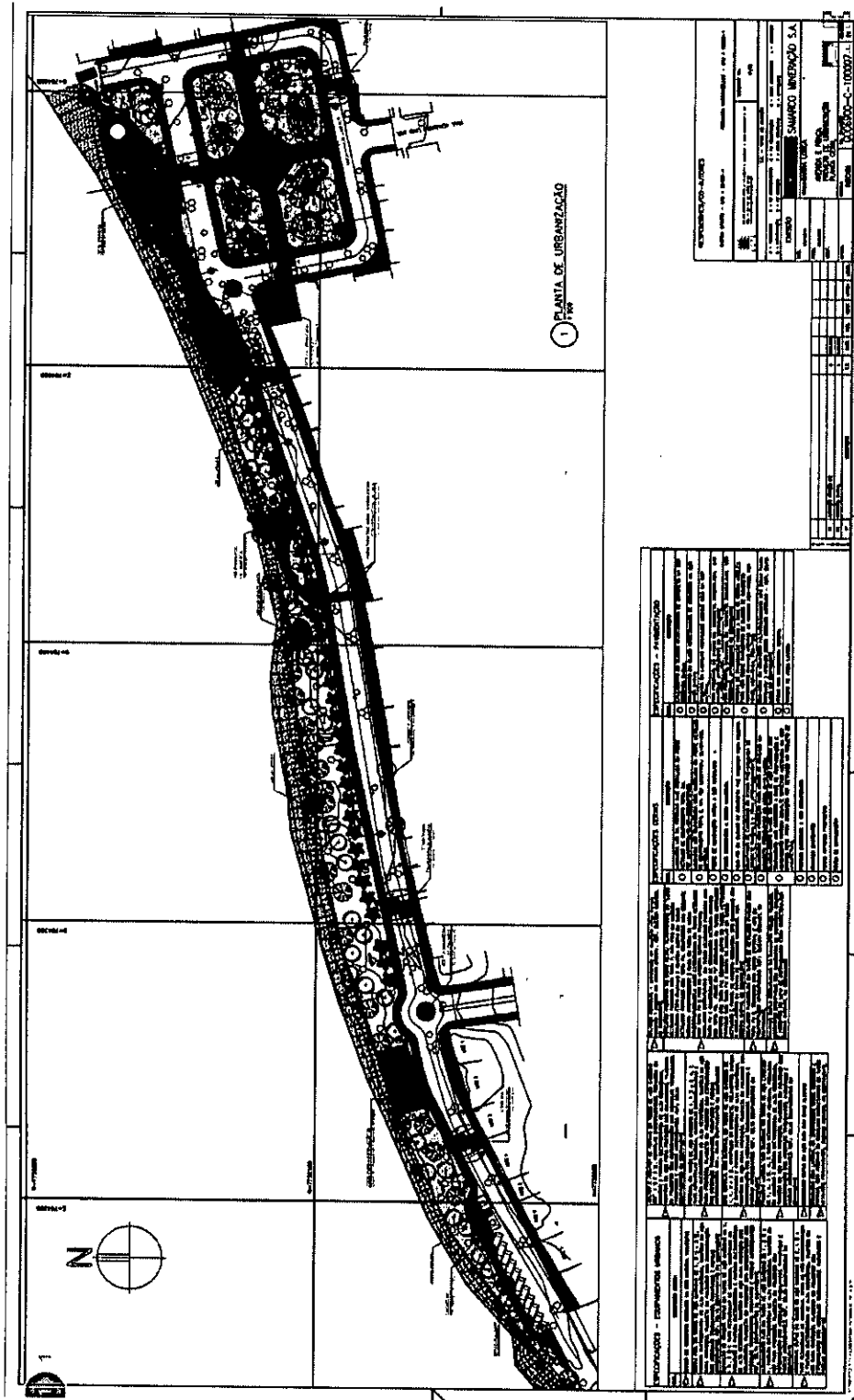
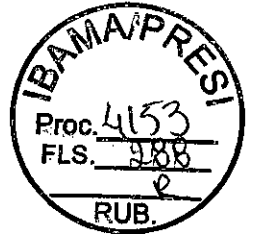

MEMBRANCO

4.2. CAMPO DE FUTEBOL BARRA LONGA

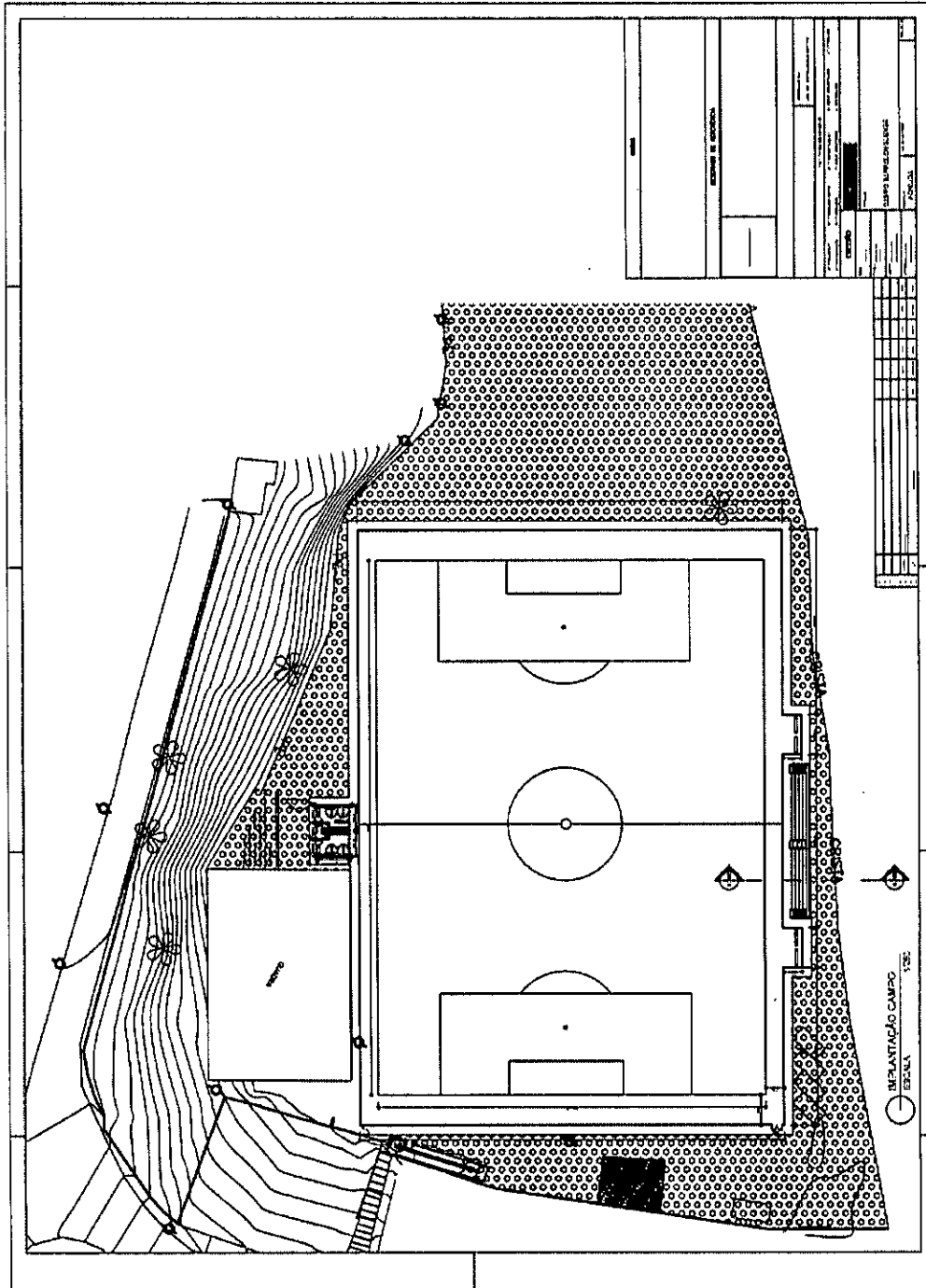
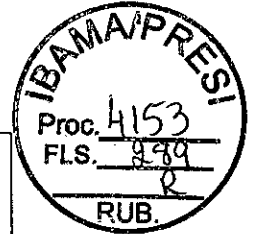

MEMBRANCO

EMBRANCO

4.4. PONTE 3

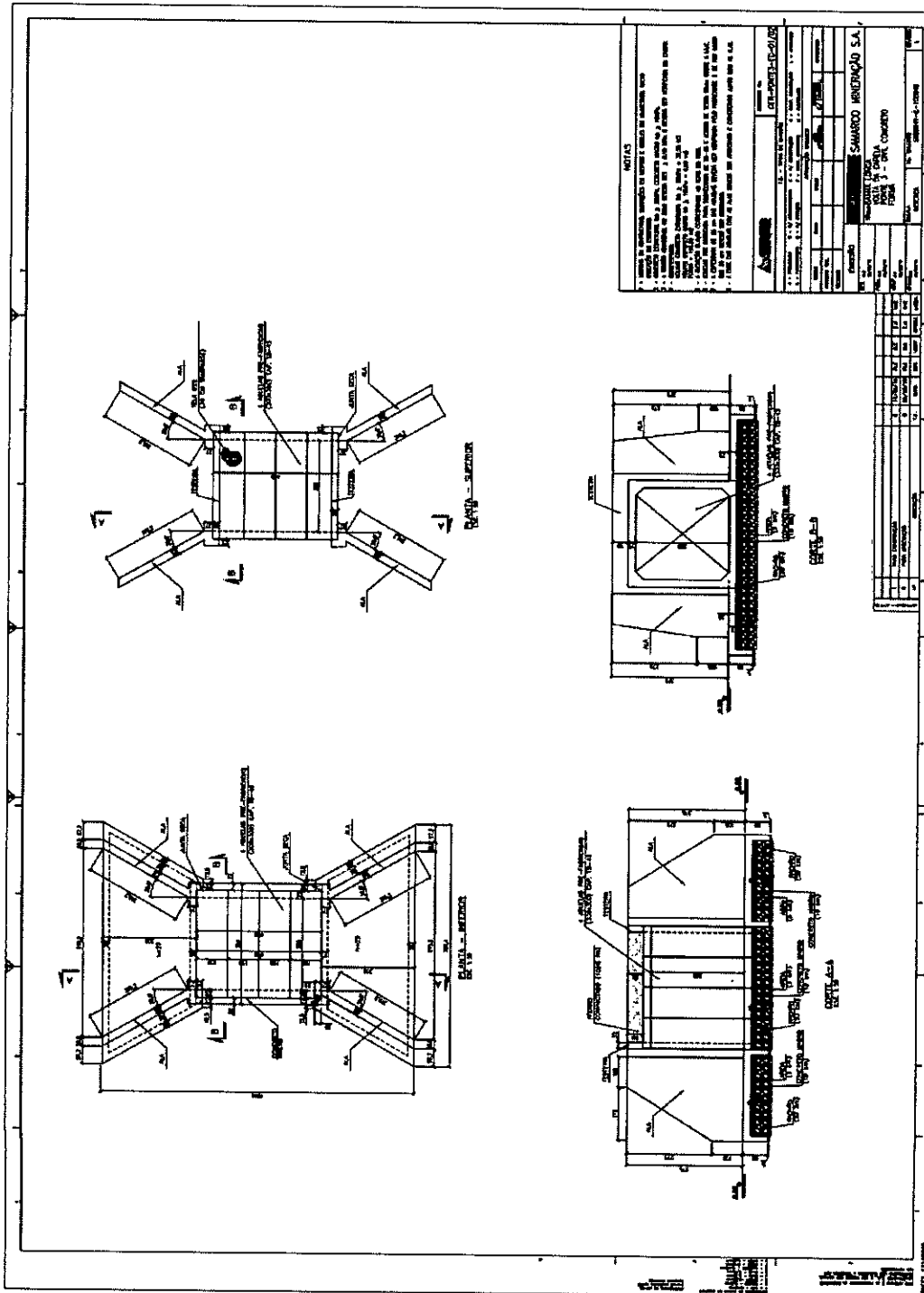
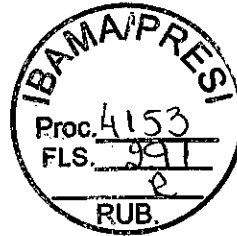

FRANCO

EMBRANCO

FEB 19 1960

4.5. AREA DE ATERRO DE REJEITO

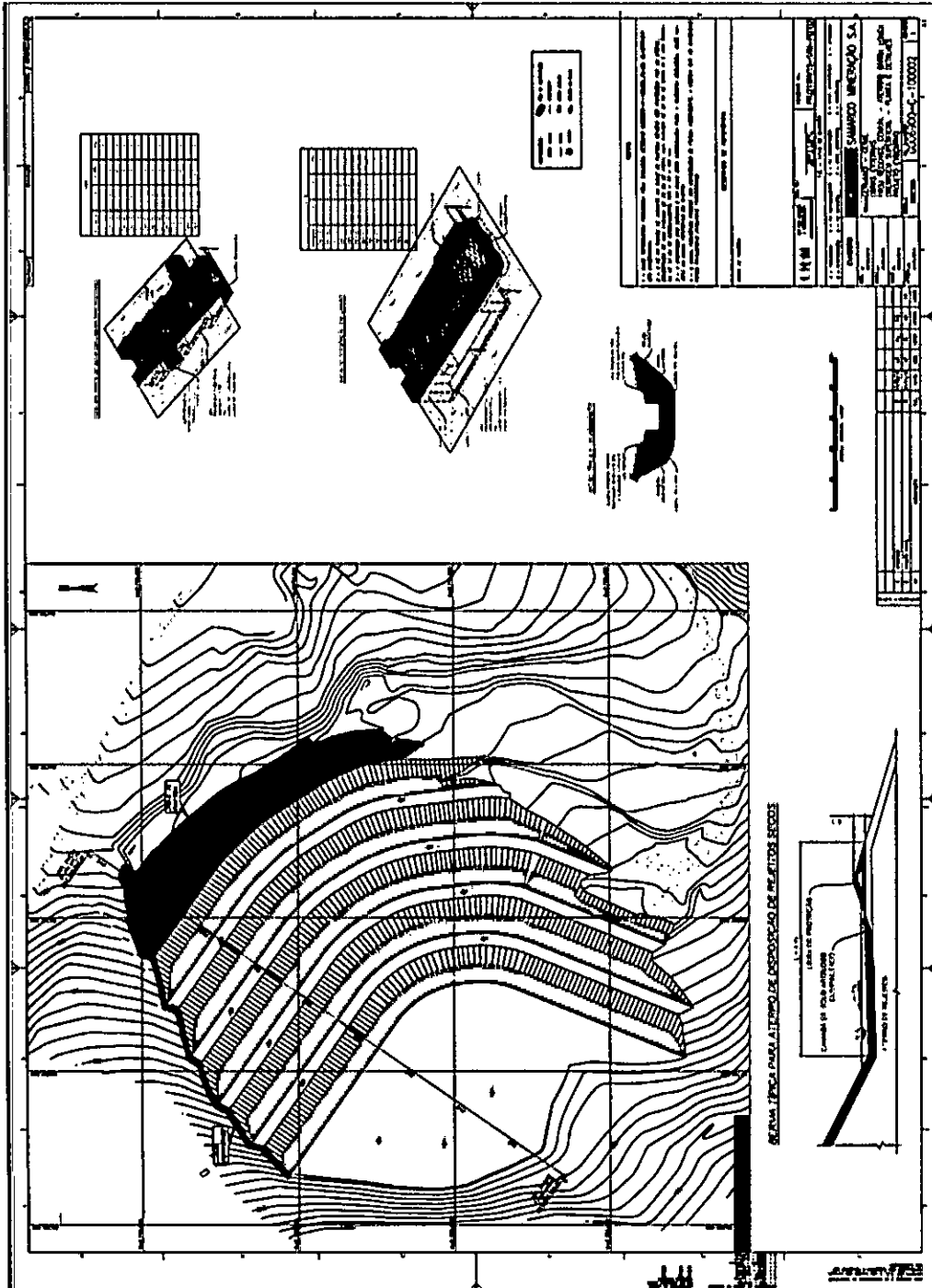
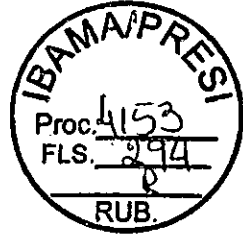

EMBRANCO

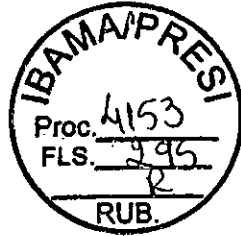
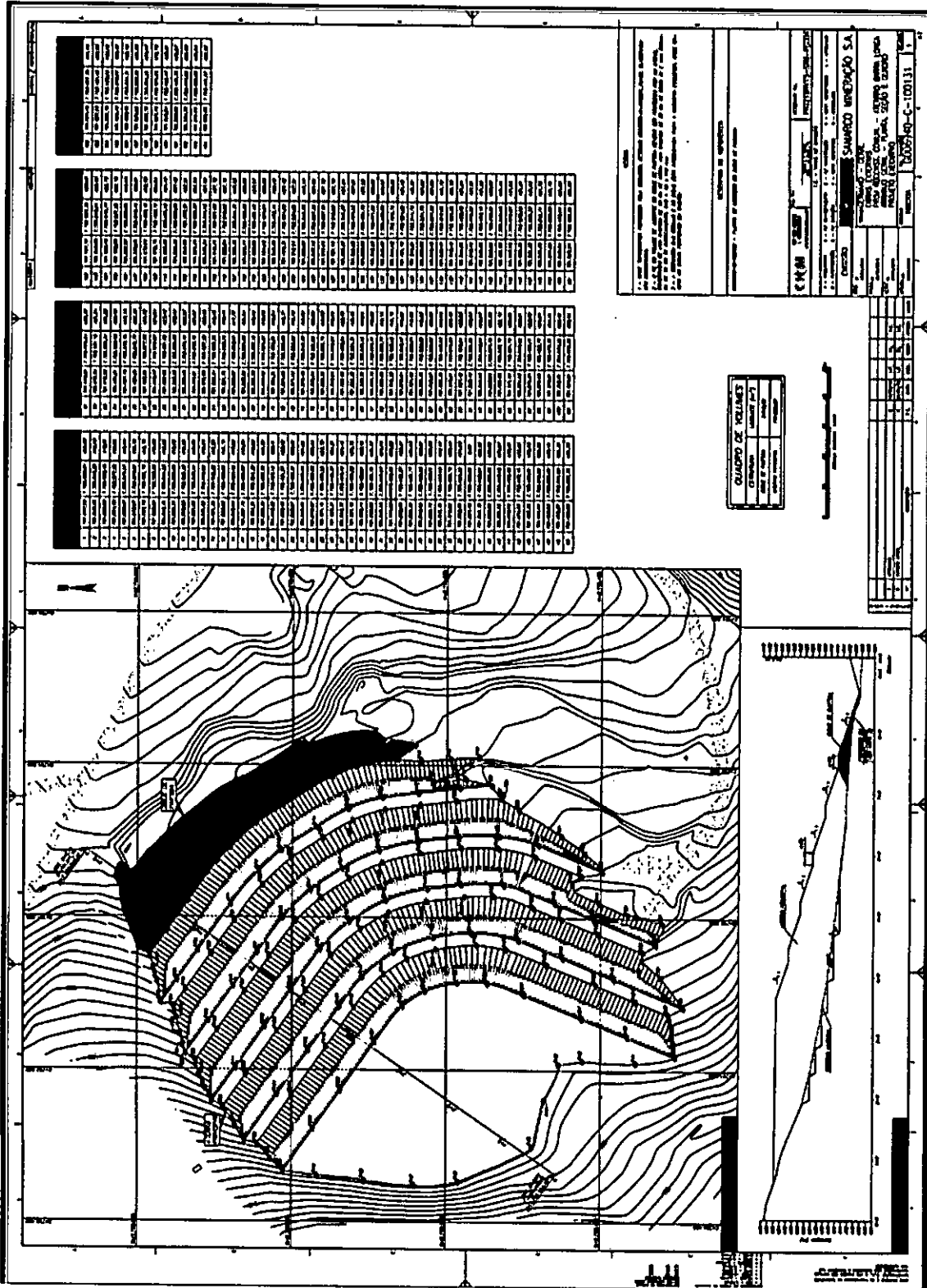

MEMBRANCO

EM BRANCO

IBAMA/PRESI
 Proc. 4153
 LS. 294
 RUB.

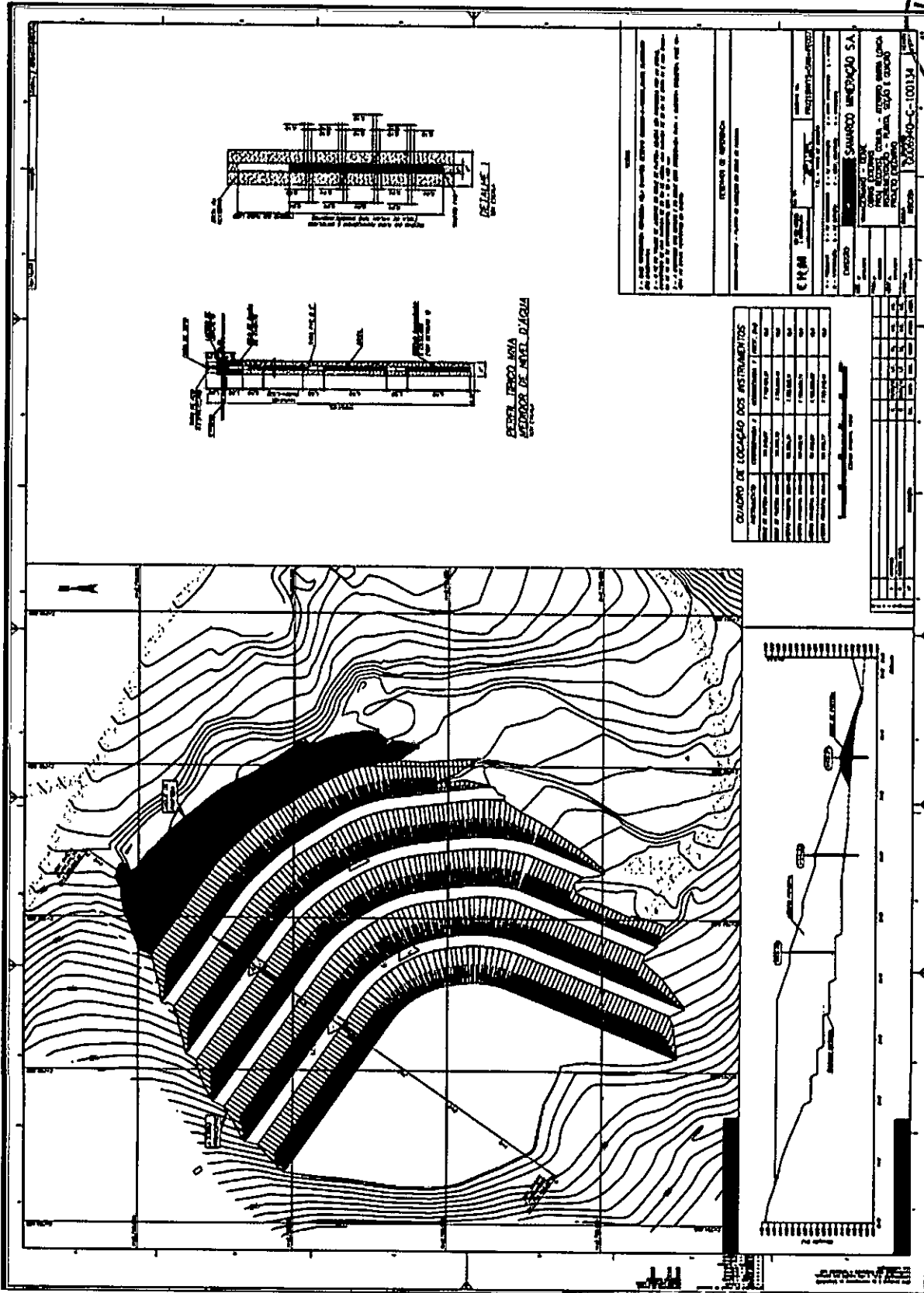

EM BRANCO

EM BRANCO

EM BRANCO

EM BRANCO

IBAMA/PRES!
 Proc. 4153
 FLS. 301
 2
 RUB.

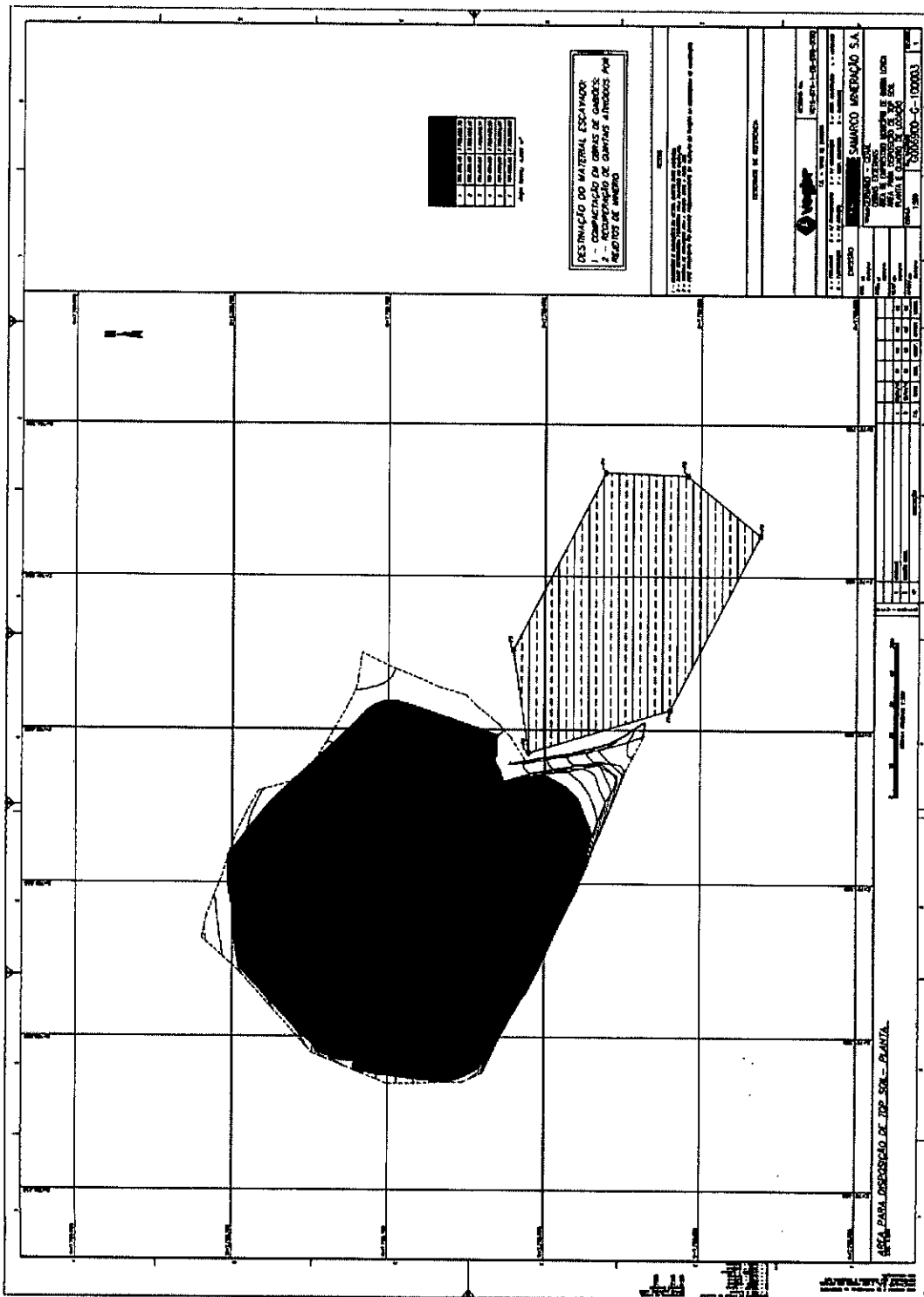

EM BRANCO

EM BRANCO

EM BRANCO



FUNDAÇÃO
renova
Fundação de Amparo à Pesquisa do Estado de São Paulo

FUNDAÇÃO RENOVA

Nº

REV
0

PÁGINA
120

6. QUINTAIS

6.1. CENTRO

6.1.1. CE 07

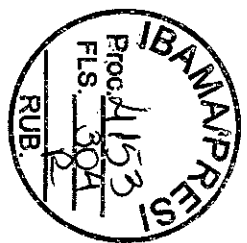
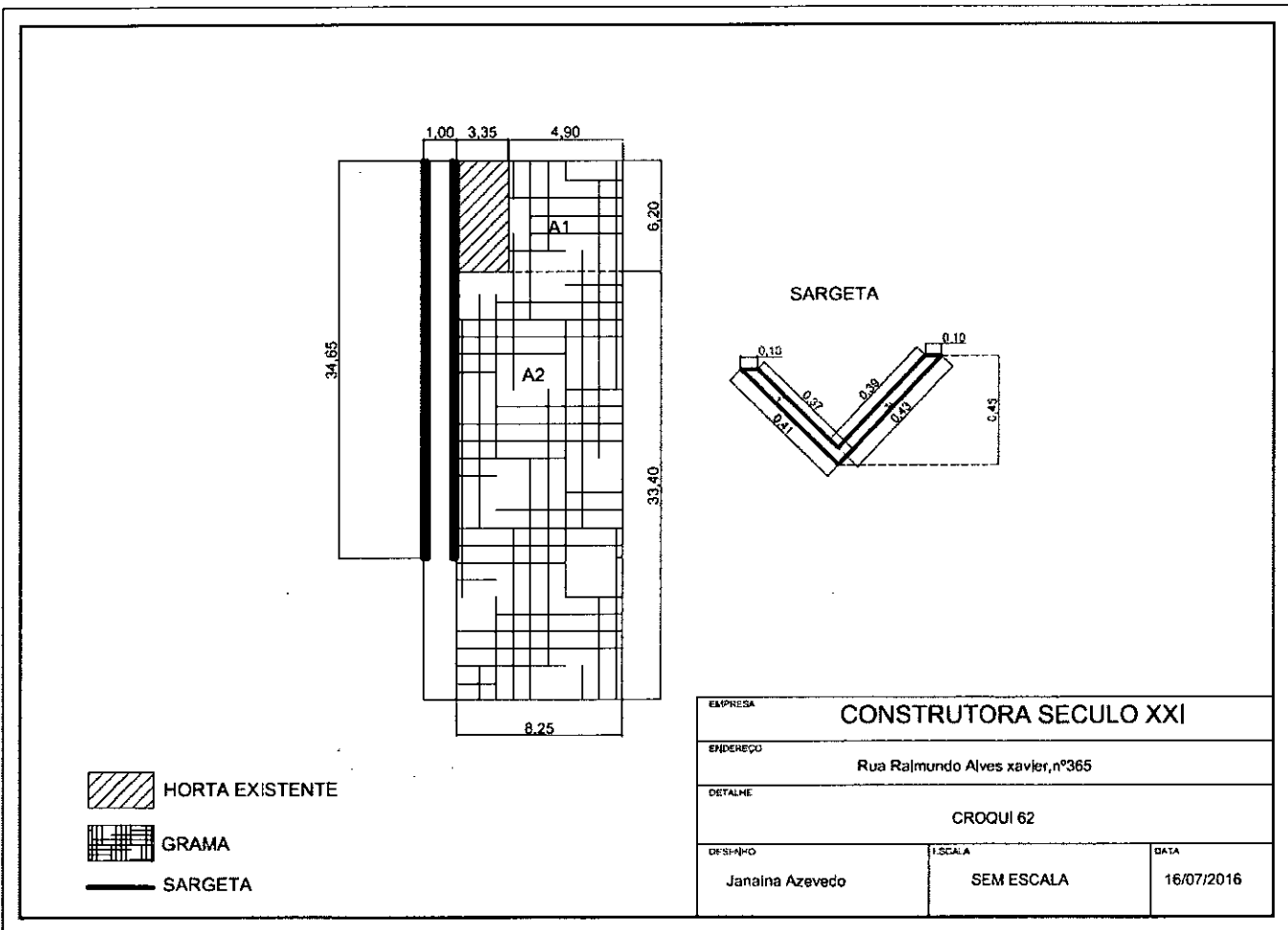

EM BRANCO



FUNDAÇÃO
renova
FEDERAL - FEDERAL DE INCUBIDORIAS

FUNDAÇÃO RENOVA

Nº

REV
0

PÁGINA
121

6.1.2. CE 50

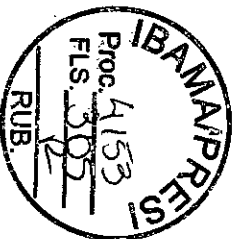
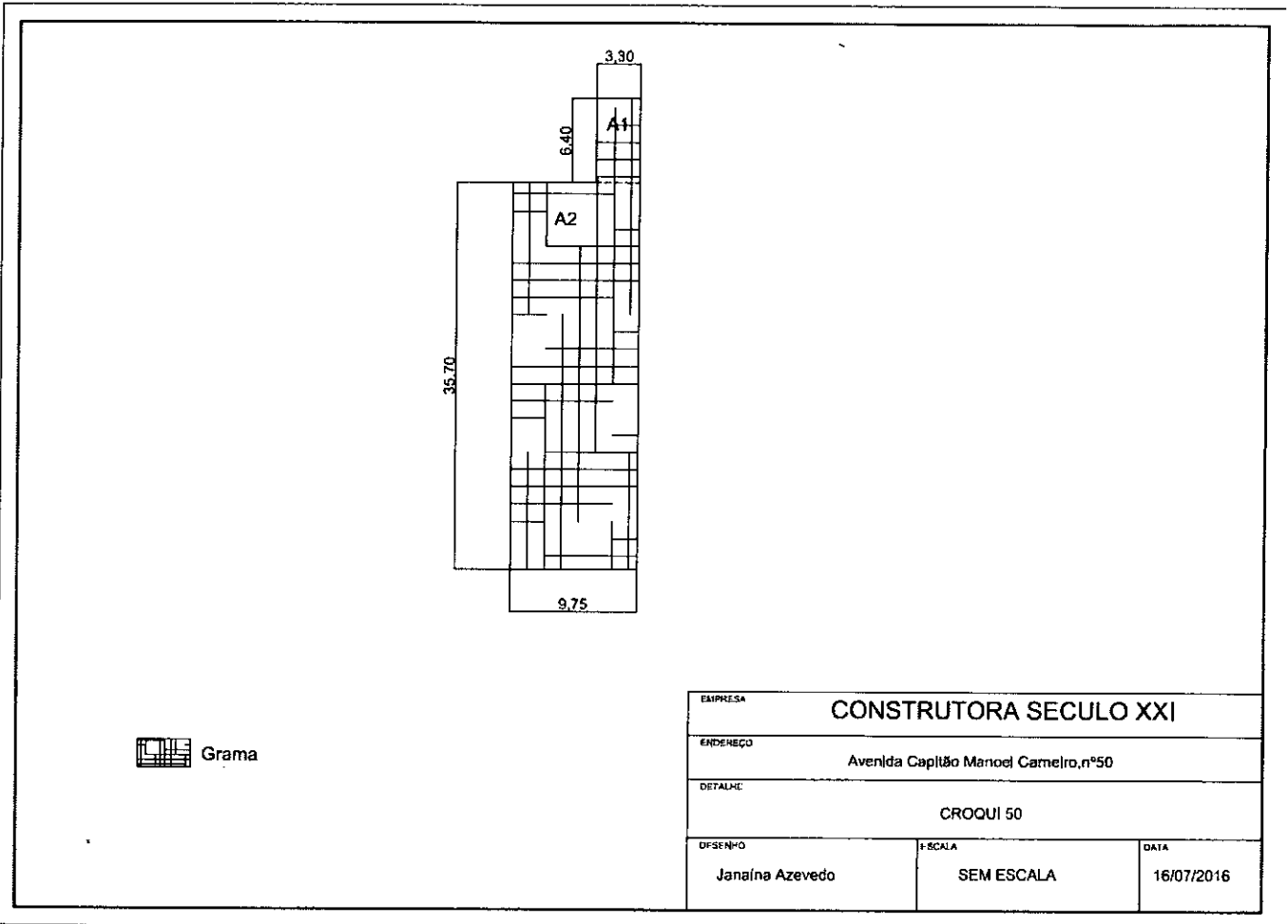

BRANCO

6.1.3. CE 56

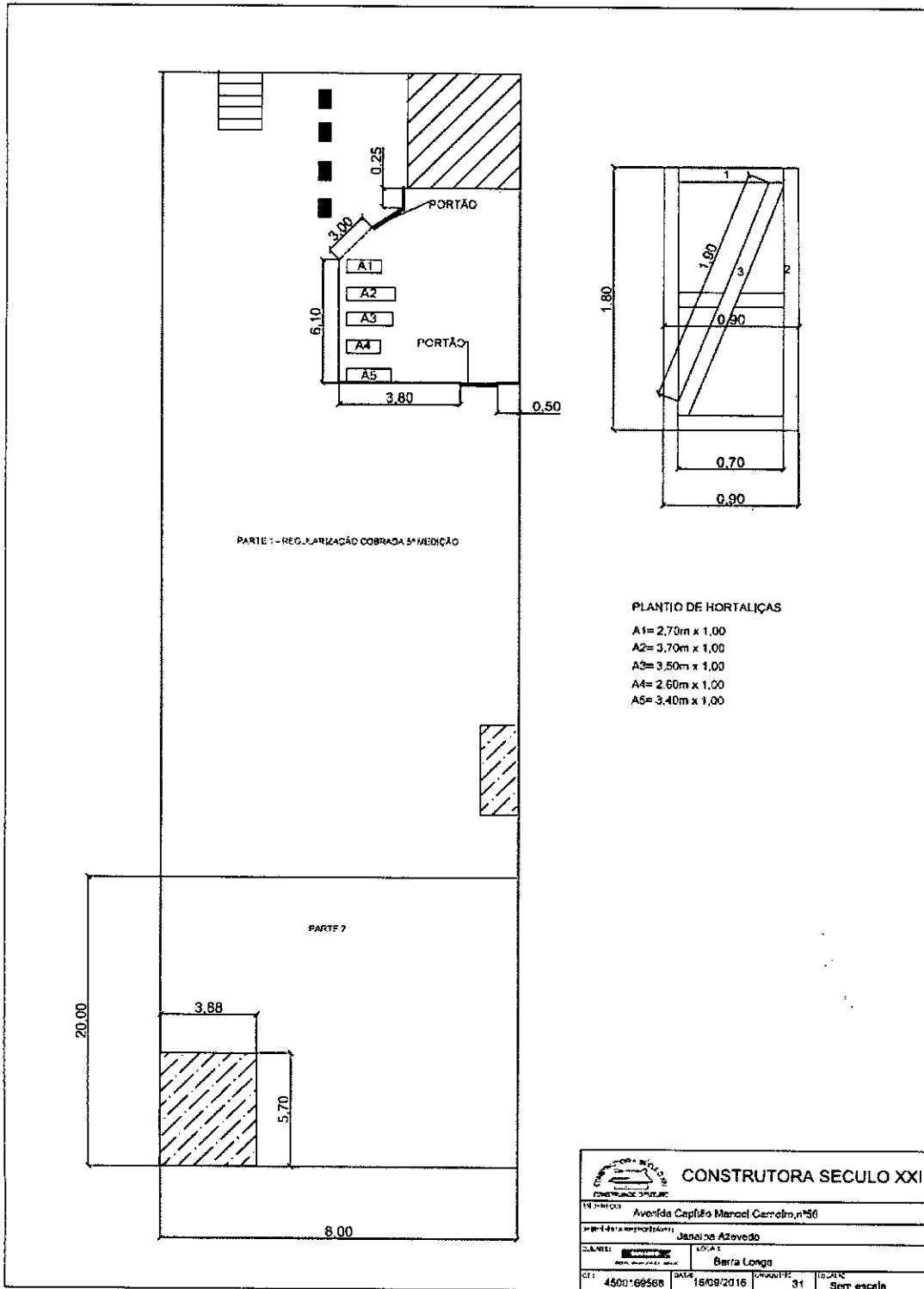
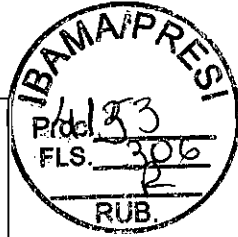

EM BRANCO

6.1.4. CE 154

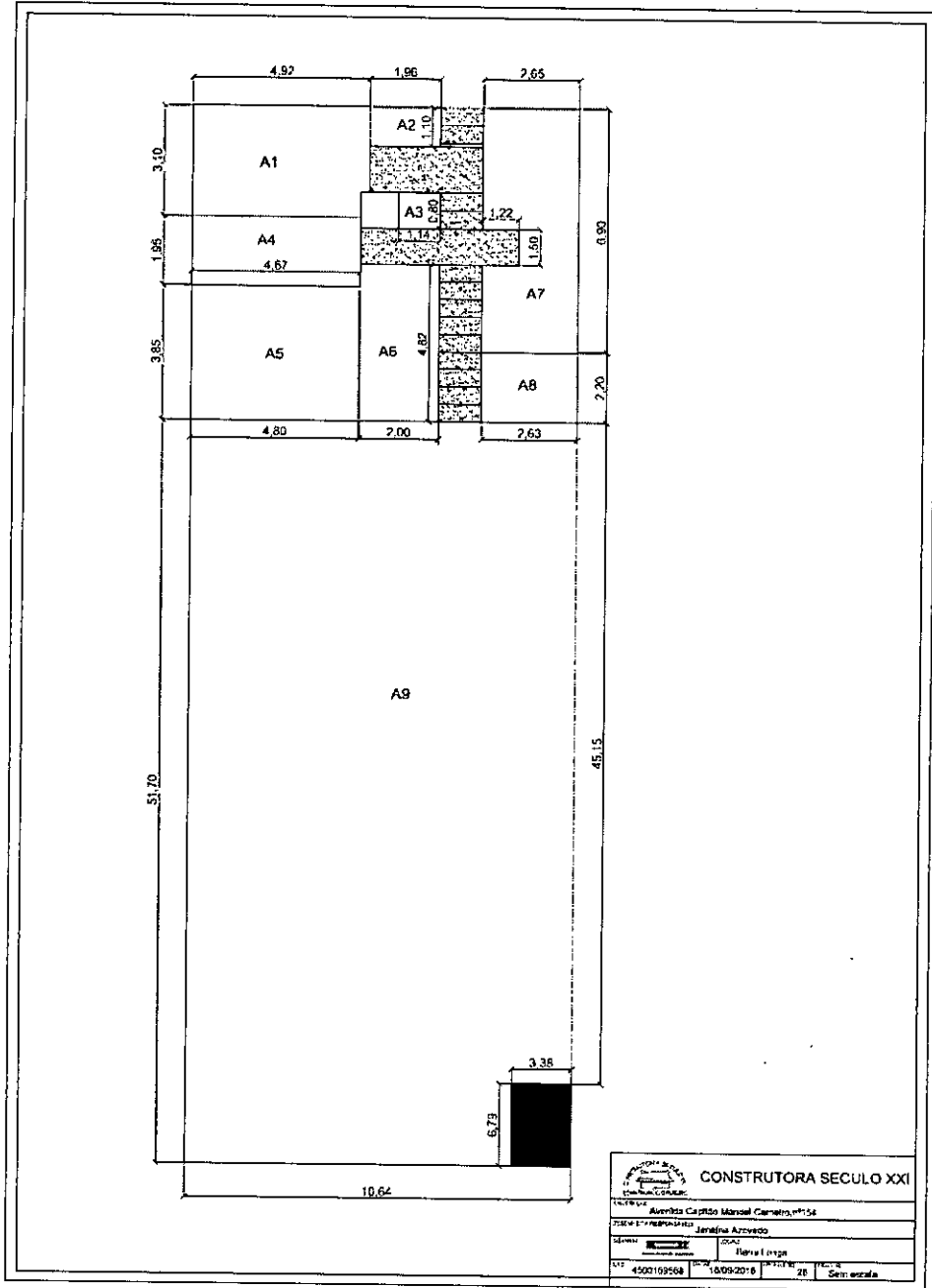
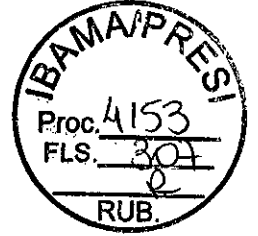

CONSTRUTORA SÉCULO XXI	
Rua Capitão Manoel Carneiro, nº 154	
Jardim Alzavos	
Zona	
Barra Longa	
CPF: 450199508	18/09/2018
Sem escala	

EM BRANCO

6.1.5. CE 96

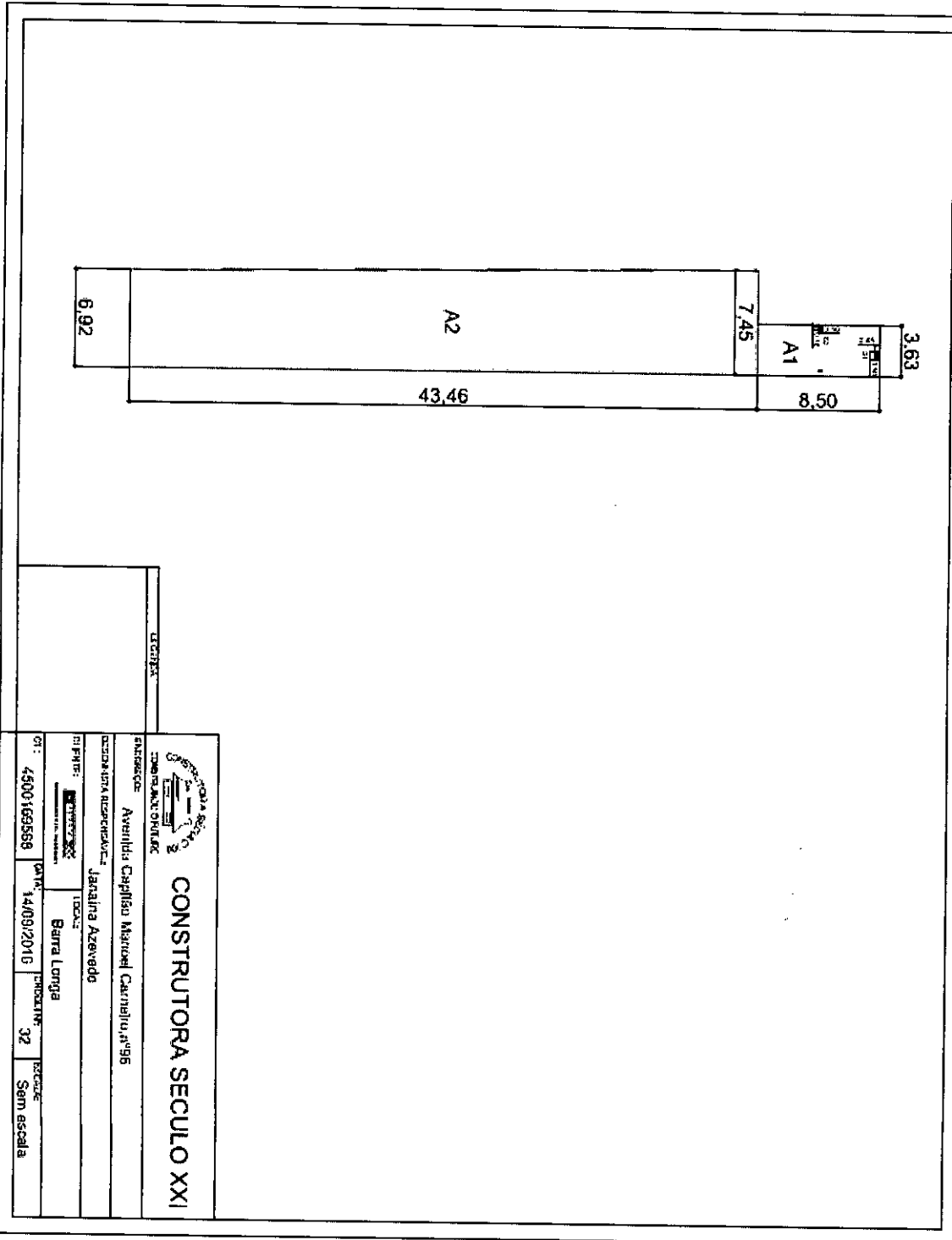
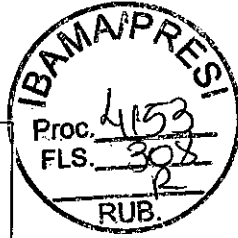

EM BRANCO

6.1.6. CE 154

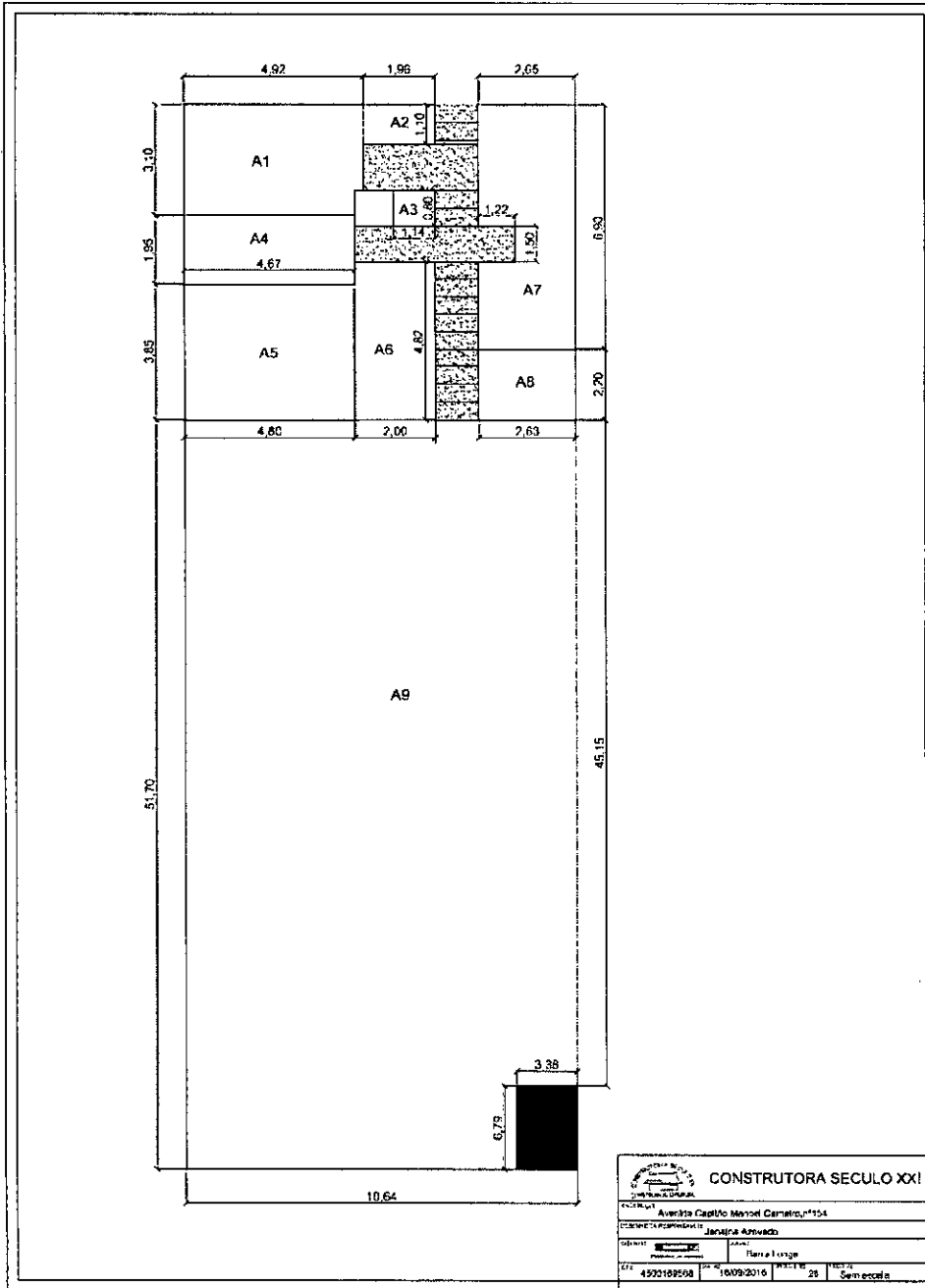
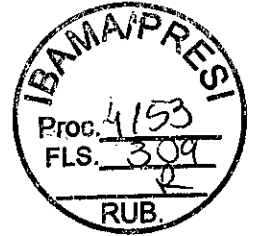

CONSTRUTORA SÉCULO XXI

PROJETO: Avenida Capitão Manoel Carneiro, nº154

CLIENTE: Jandira Arruda

PROJETO: Planta Única

DATA: 4/22/2008

PROJETO: 1009/2016

PROJETO: 28

PROJETO: Sem escala

BRANCO

6.1.7. CE 166

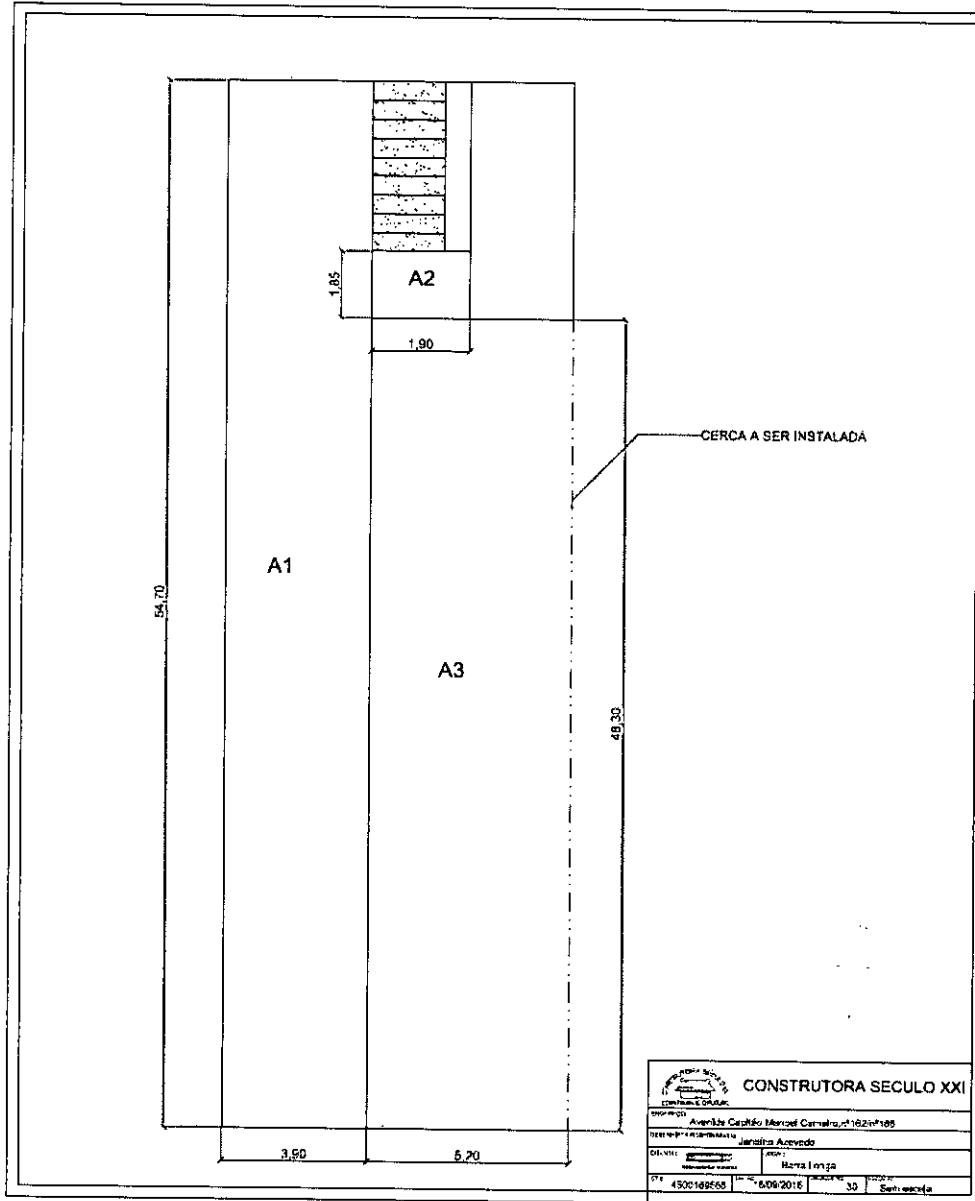
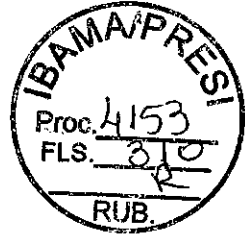

BRANCO



6.1.8. CE 176

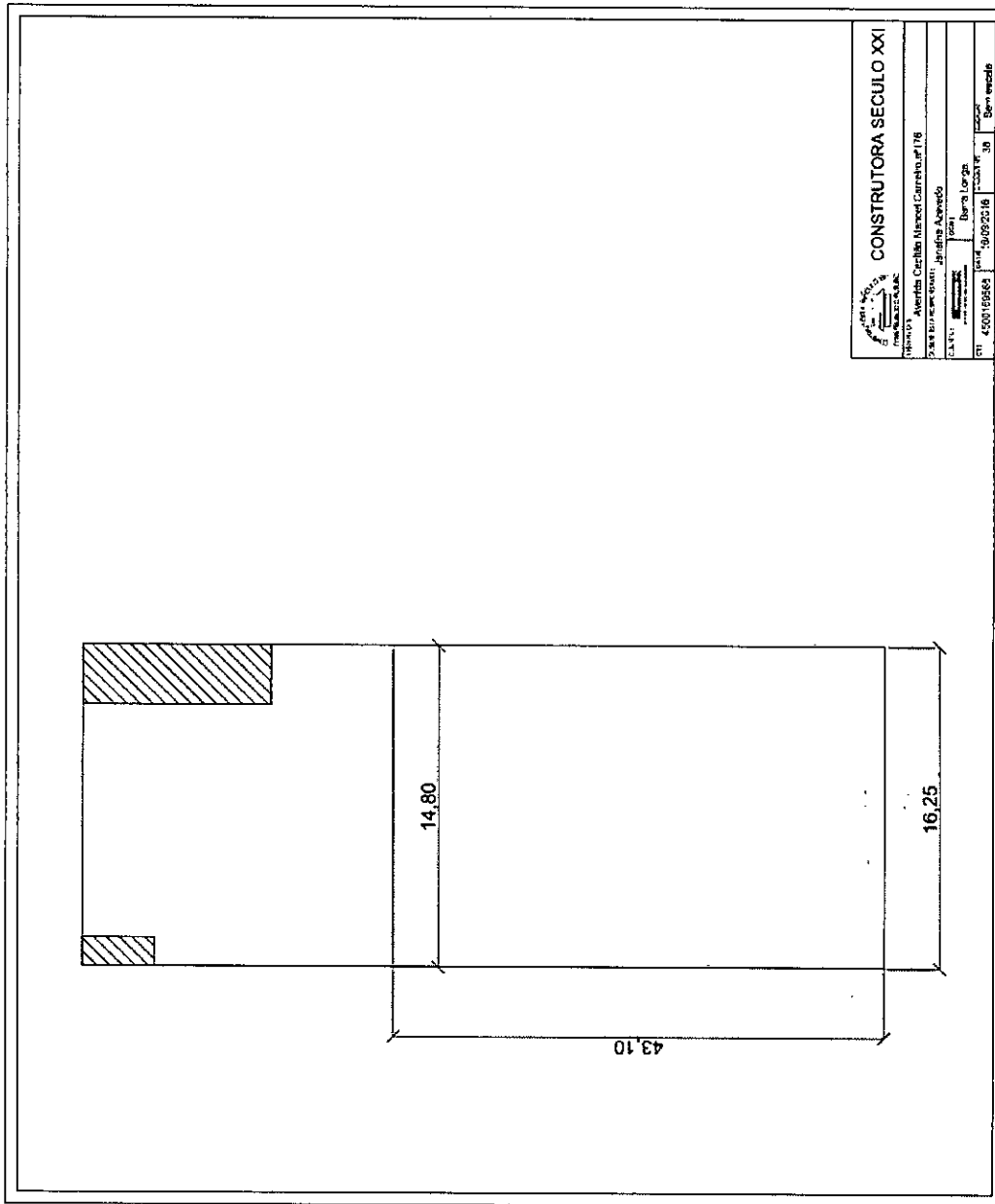
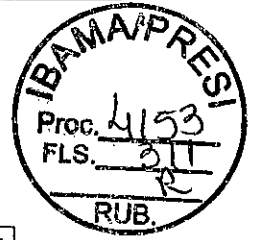

CONSTRUTORA SÉCULO XXI

Projeto: Avenida Capitão Alencar Correia nº 176
Bairro: Jardim América
Cidade: Curitiba - Paraná

Projeto: [] Data: [] Local: []
Escala: []

Proj. 450116684 Data: 26/09/2016 Folha: 30 de 30

IMBRANCO

6.1.9. CE 202

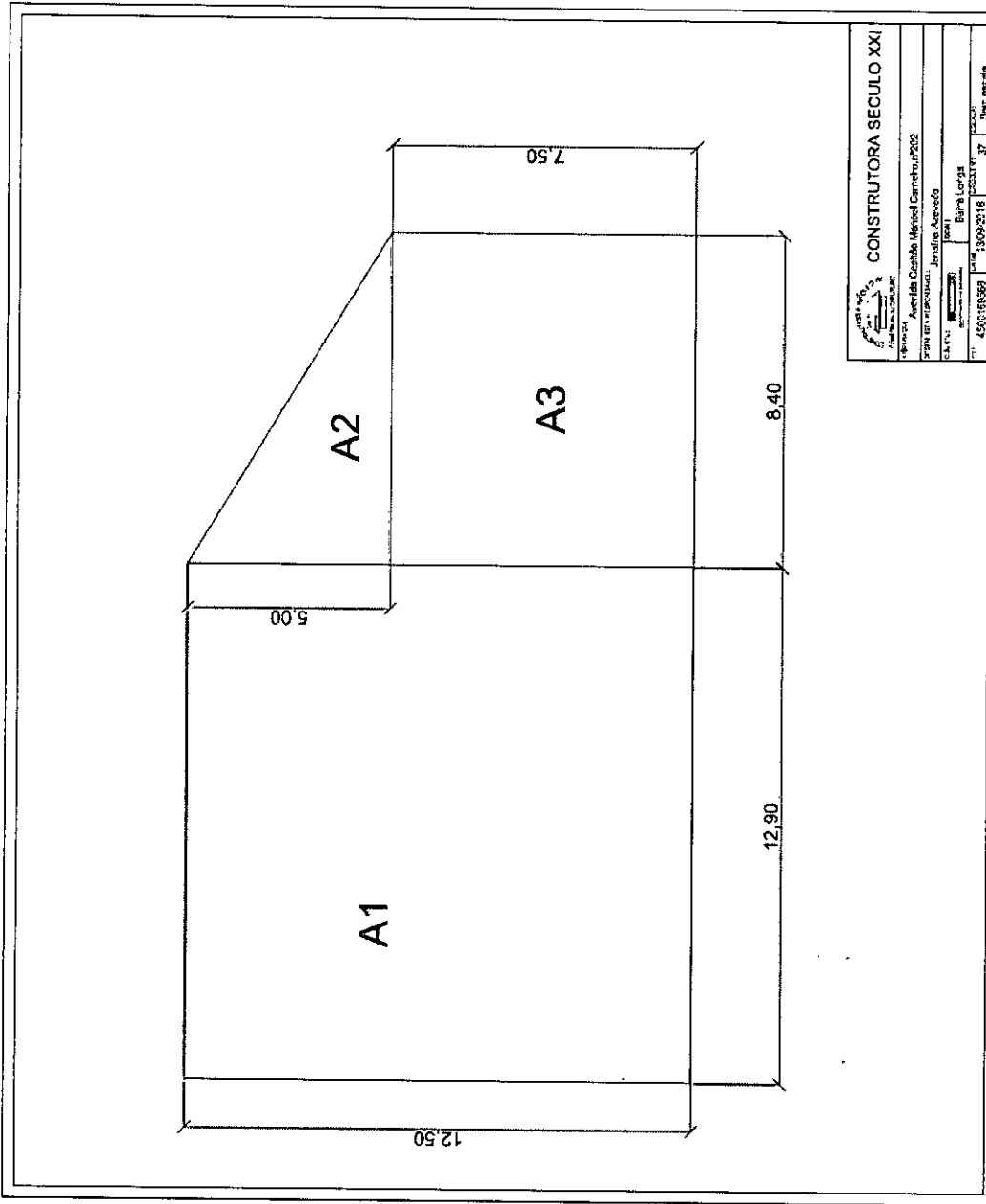

CONSTRUTORA SÉCULO XXI

Projeto Arquitetônico

Endereço: Avenida Curitiba, Mercado Central 202

CEP: 81130-000 - Curitiba - Paraná

Telefone: (41) 3309-2018

Site: www.seculo21.com.br

Projeto: 37

Shed: 000000

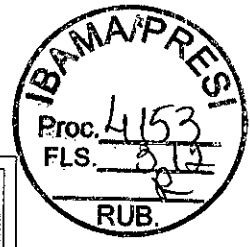

AL BRANCO

EM BRANCO

EM BRANCO



FUNDAÇÃO
renova
FUNDAÇÃO DE APOIO À ADMINISTRAÇÃO

FUNDAÇÃO RENOVA

Nº

REV
0

PÁGINA
131

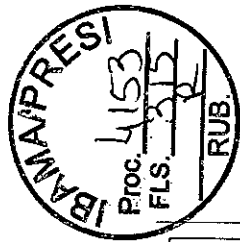

6.1.12. CE 151

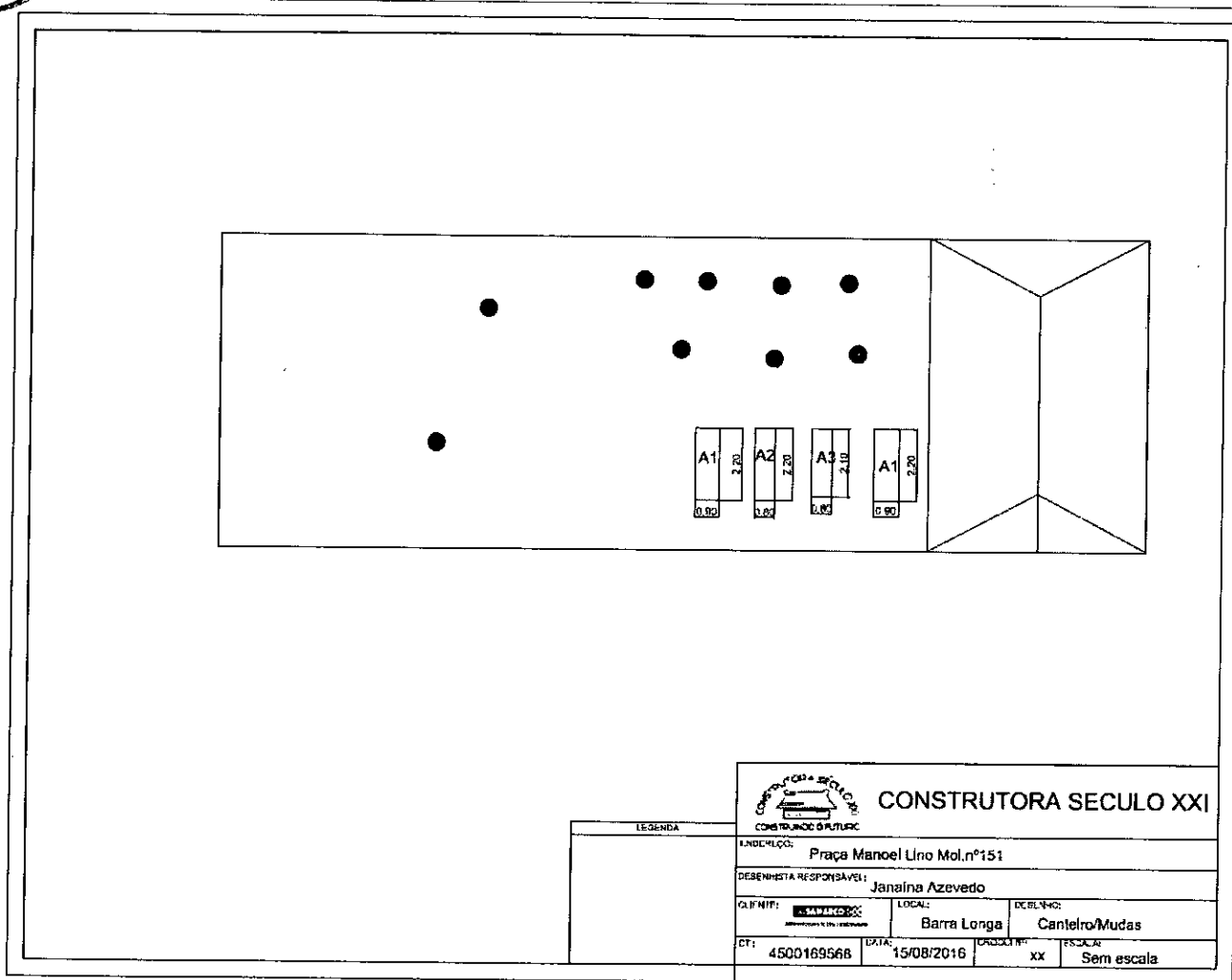

EM BRANCO

6.1.13. CE 203

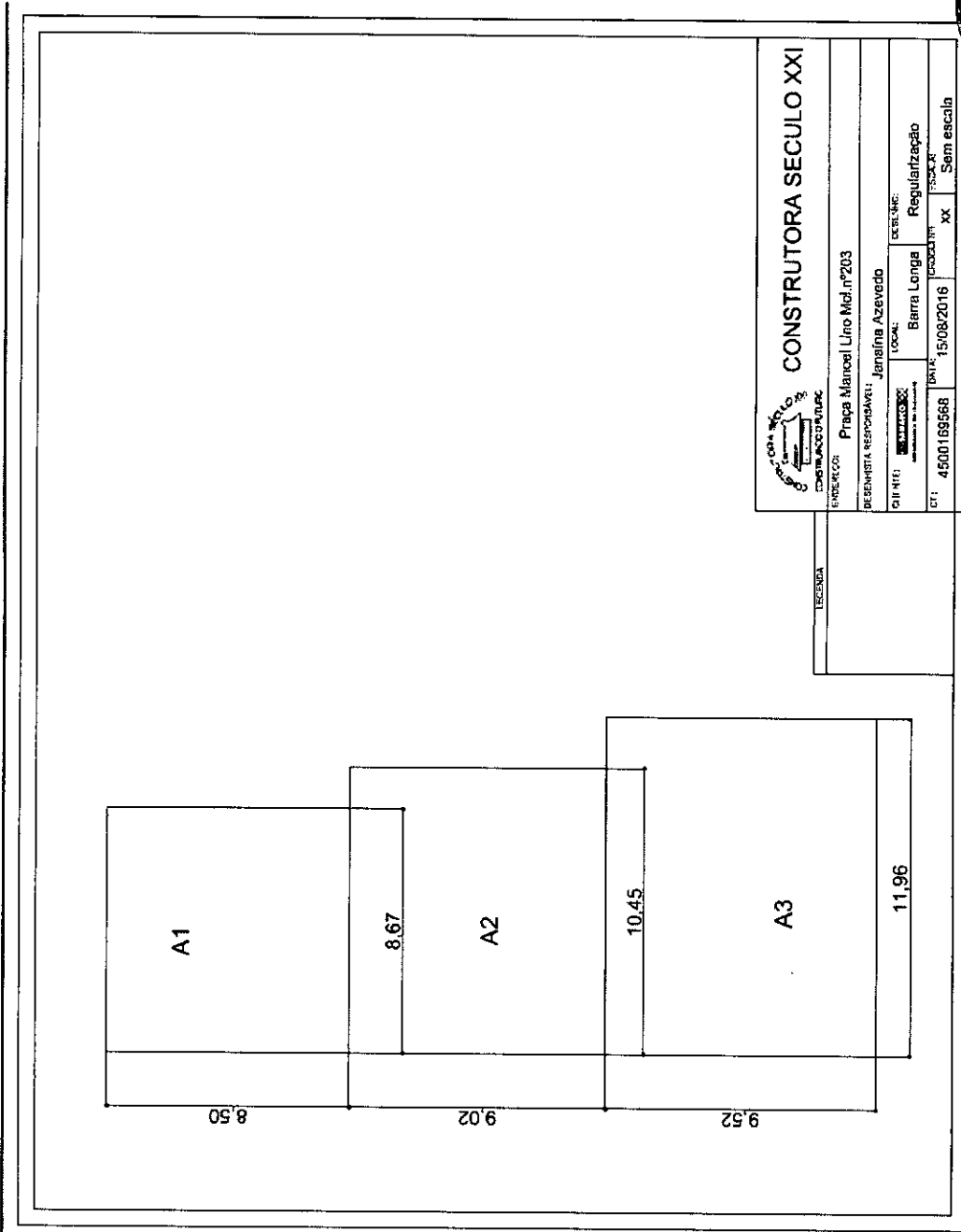
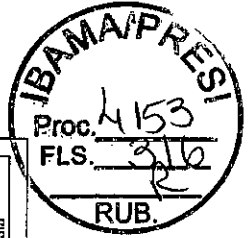

EM BRANCO

6.2. VOLTA DA CAPELA E 1º DE JANEIRO

6.2.1. VC 56 E 244

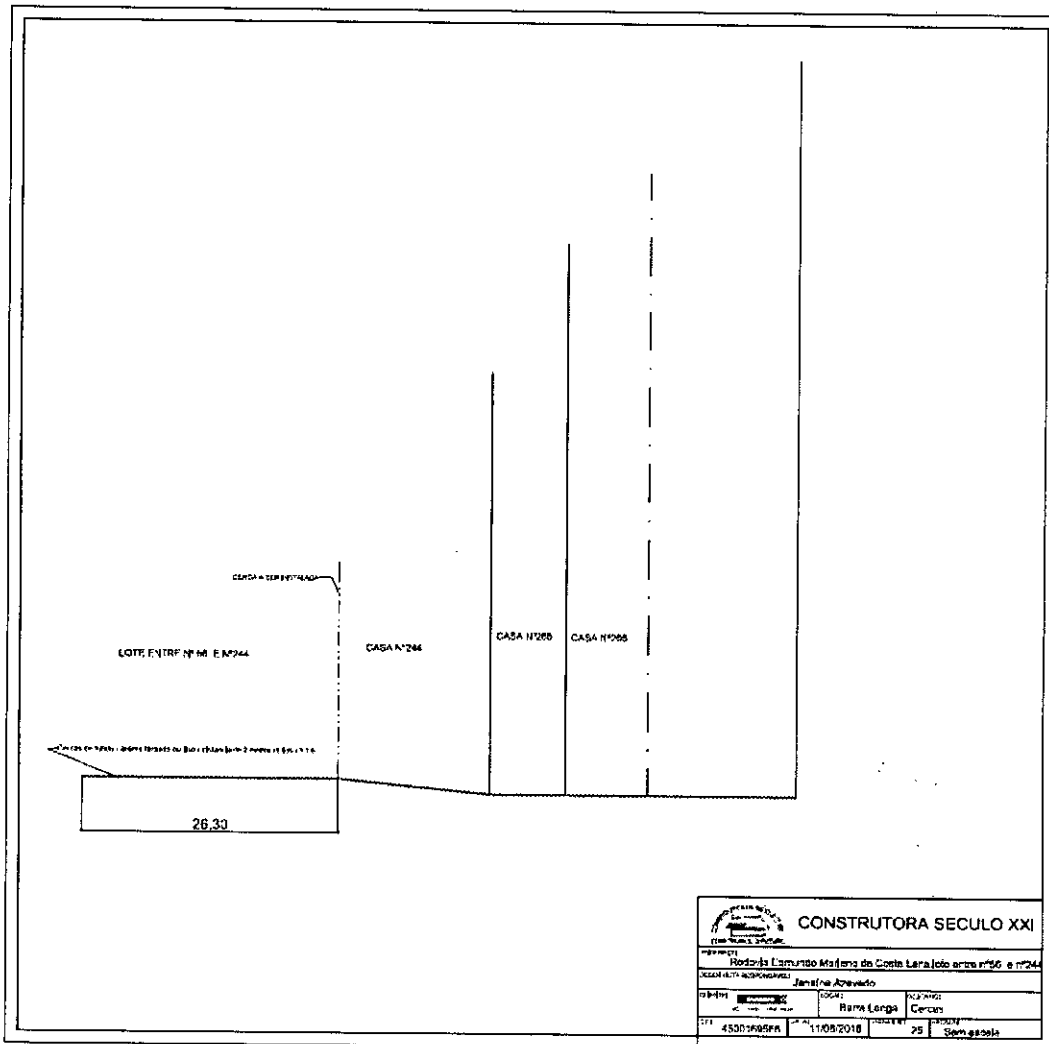
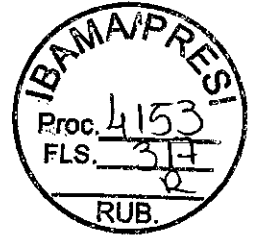

CONSTRUTORA SECULO XXI	
Rodo-va Laminado Madeira do Costa Lara lotes nº 06 e nº 24	
PROJETO	Janeiro Azevedo
LOCAL	Rama Longa Cercas
DATA	11/09/2018
PROJETO	Sem assola

EM BRANCO



FUNDAÇÃO
renova
RECONSTRUÇÃO - REQUALIFICAÇÃO - REDESENVOLVIMENTO

FUNDAÇÃO RENOVA

Nº

REV
0

PÁGINA
134

6.2.2. VC 162

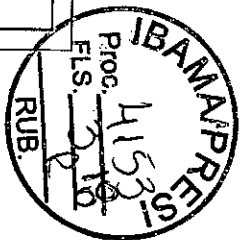
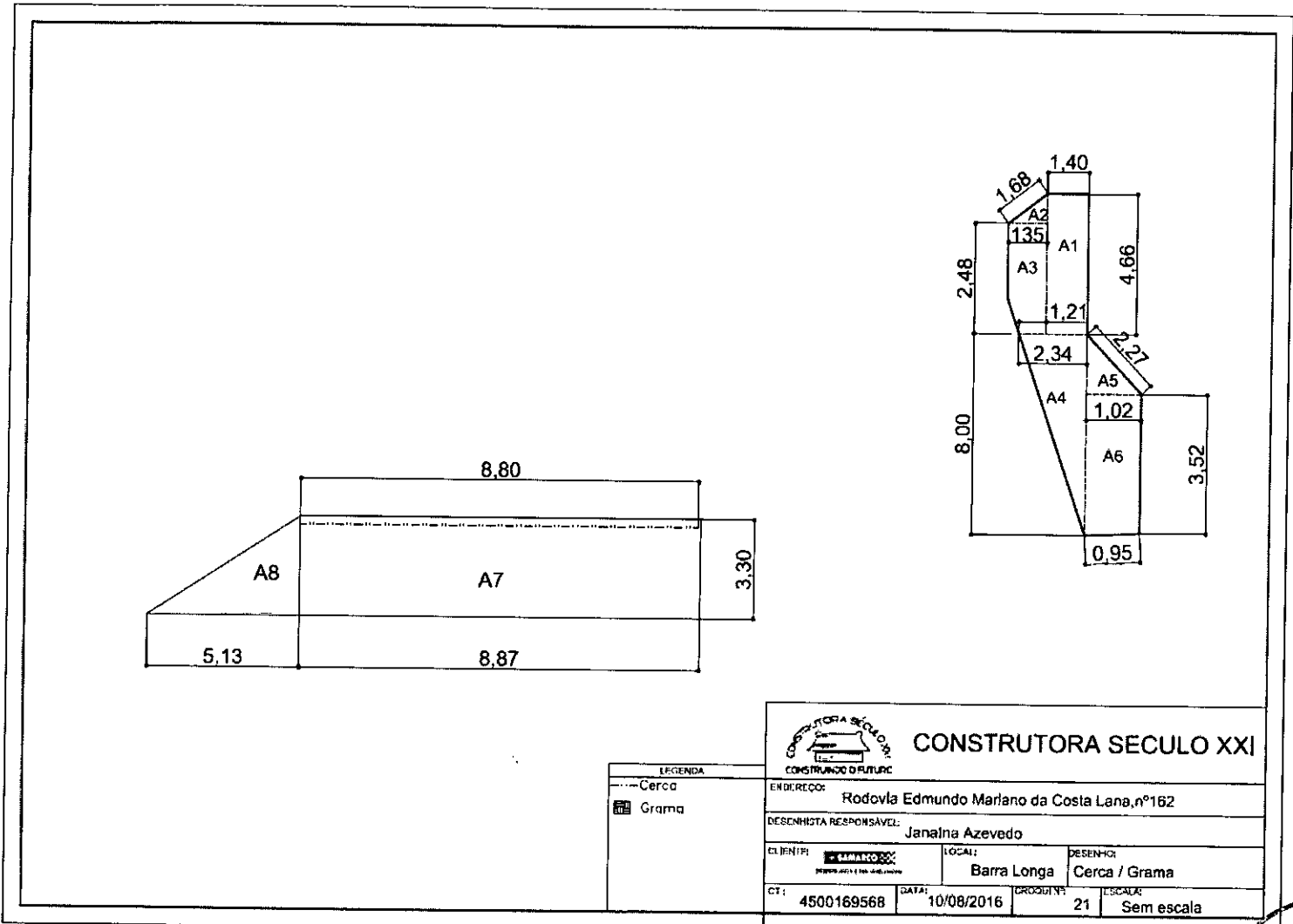

EM BRANCO



6.2.3. VC 163

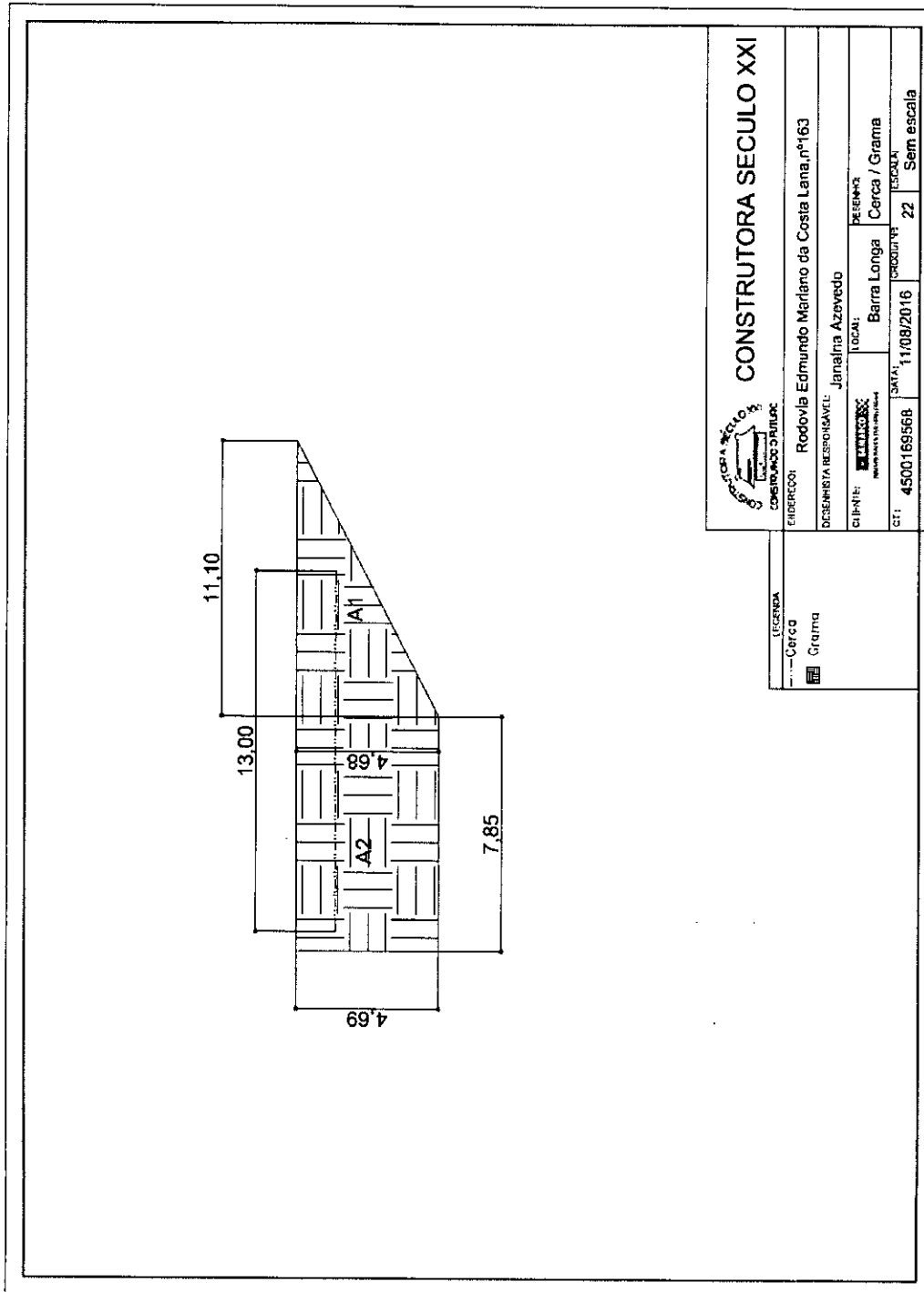
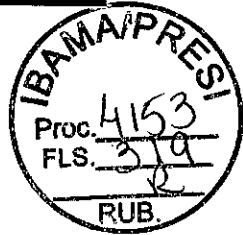

		CONSTRUTORA SECULO XXI	
ENDERECO:	Rodovia Edmundo Mariano da Costa Lana, nº163		
DESEMNISTA RESPONSÁVEL:	Janaina Azevedo		
CIP-RN:	RECANTO:	DESEMN:	DESEMN:
	Barra Longa	Cerca / Grama	Cerca / Grama
CT:	4500169568	DATA:	11/08/2016
		ESCALA:	22
			Sem escala

LEGENDA
--- Cerca
■ Grama

EM BRANCO

EM BRANCO



6.2.5. VC 265

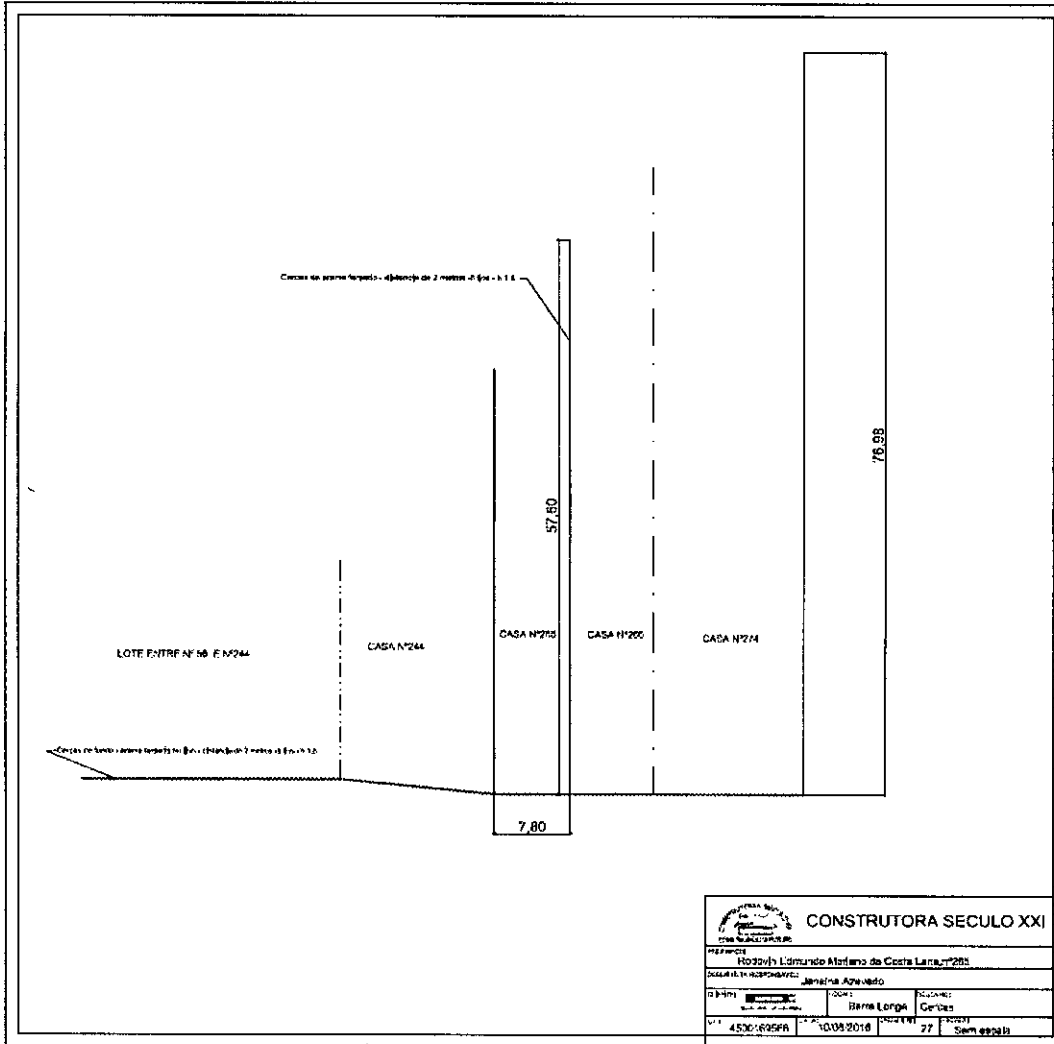
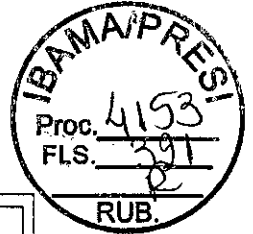

EM BRANCO



6.2.6. VC 266

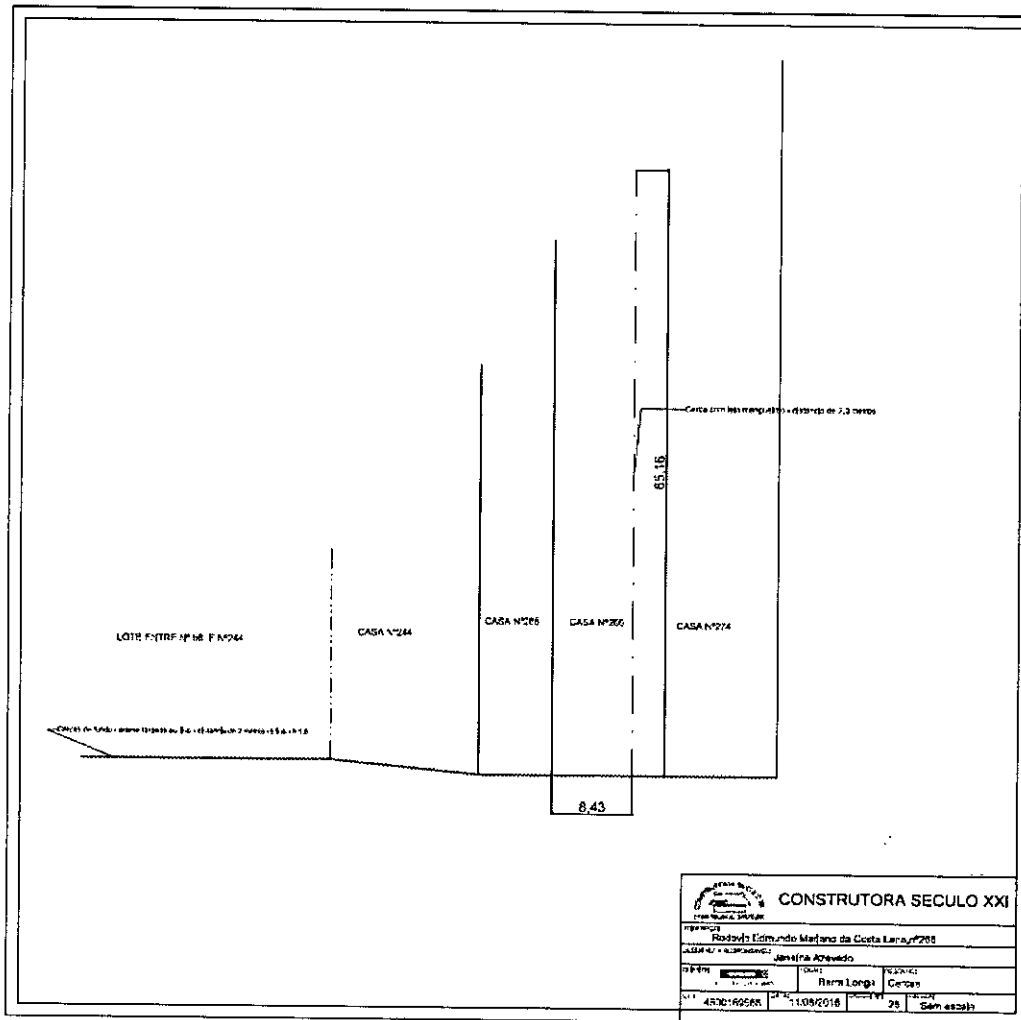
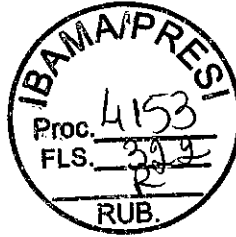

EM BRANCO



FUNDAÇÃO
renova
renovar, restaurar, renovar, renovar

FUNDAÇÃO RENOVA

Nº

REV
0

PÁGINA
139

6.2.7. VC 333 E 353

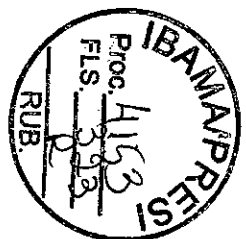
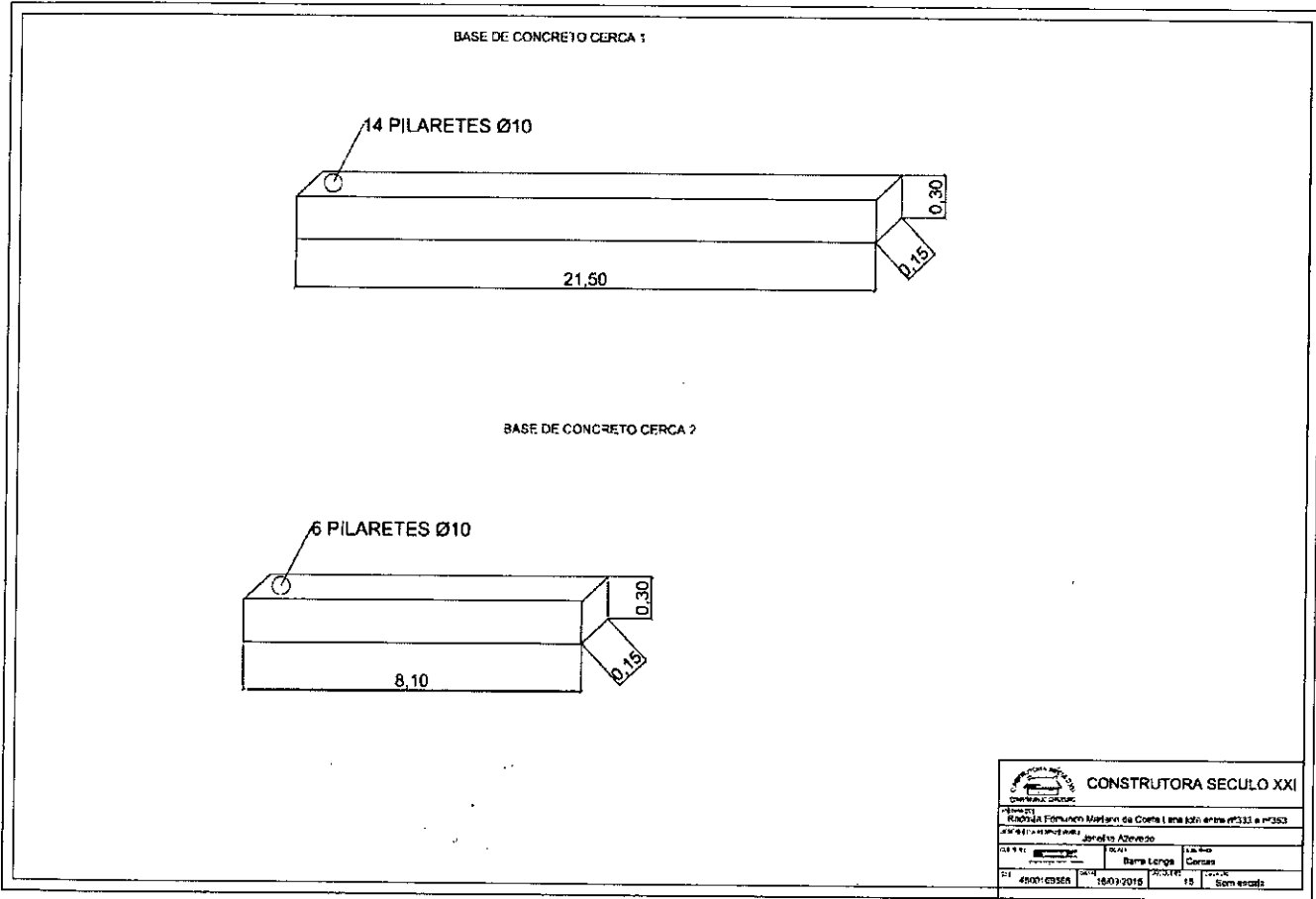

EM BRANCO

6.2.8. VC 599

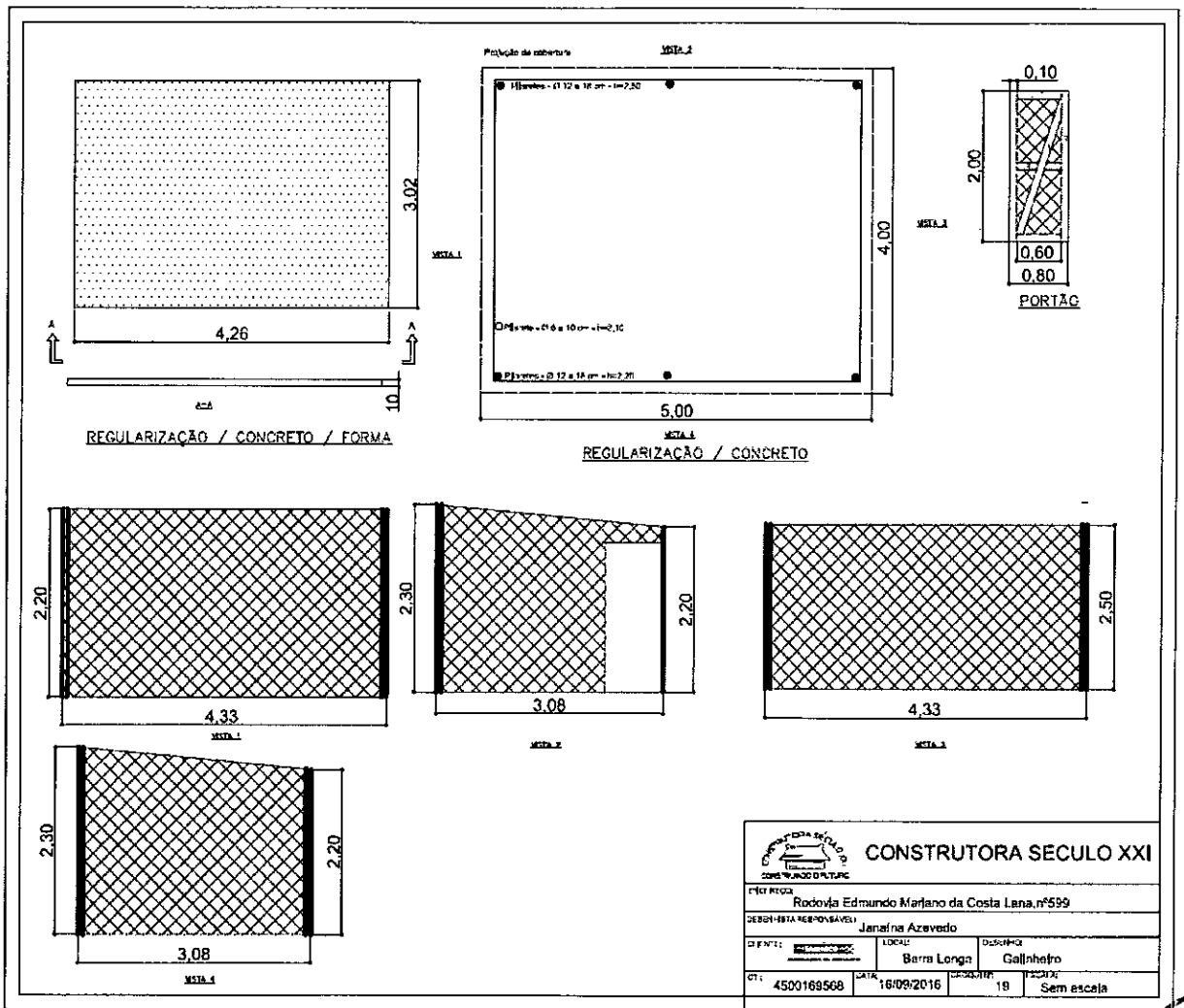

CONSTRUTORA SÉCULO XXI

PROJETO: Rodovia Edmundo Marinho da Costa Lana, nº599

DESENHISTA RESPONSÁVEL: Janaina Azevedo

EMPRESA:	LOCAL:	USURARIA:
	Barra Longa	Galinheto
OT: 4500169568	DATA: 16/09/2016	PROPOSTA: 18 Sem escala

IBAMA/PRESI
 Proc. 4153
 FLS. 394
 RUB. R

LIBRARIATO



FUNDAÇÃO
renova
Indústria, restauração e sustentabilidade

FUNDAÇÃO RENOVA

Nº

REV
0

PÁGINA
141

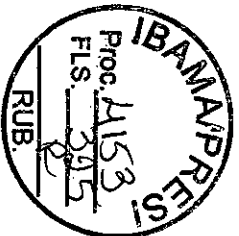
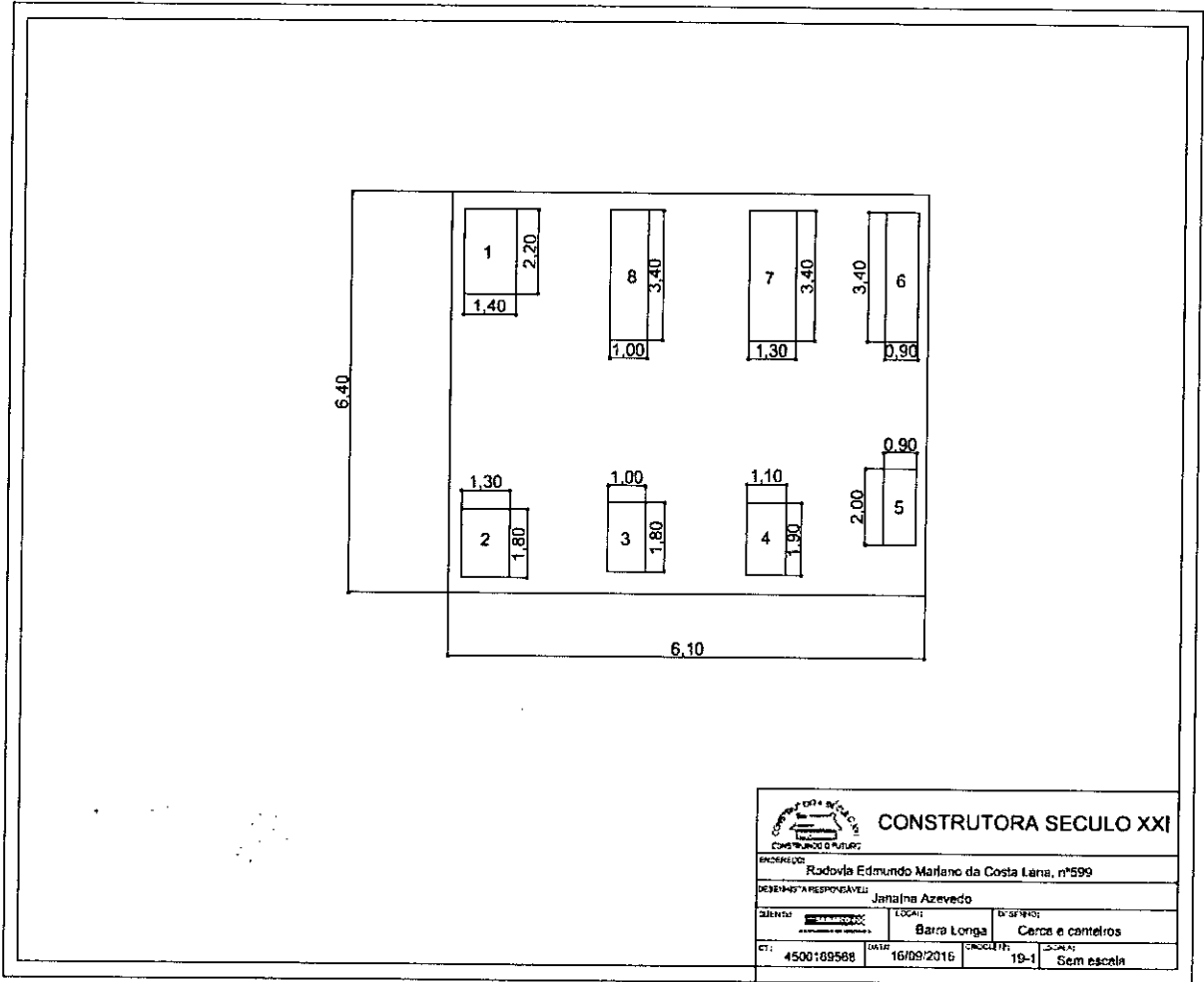

EMBRANCO



6.3. MORRO VERMELHO

6.3.1. ESCOLA ESTADUAL PADRE JOSÉ EPIFÂNIO

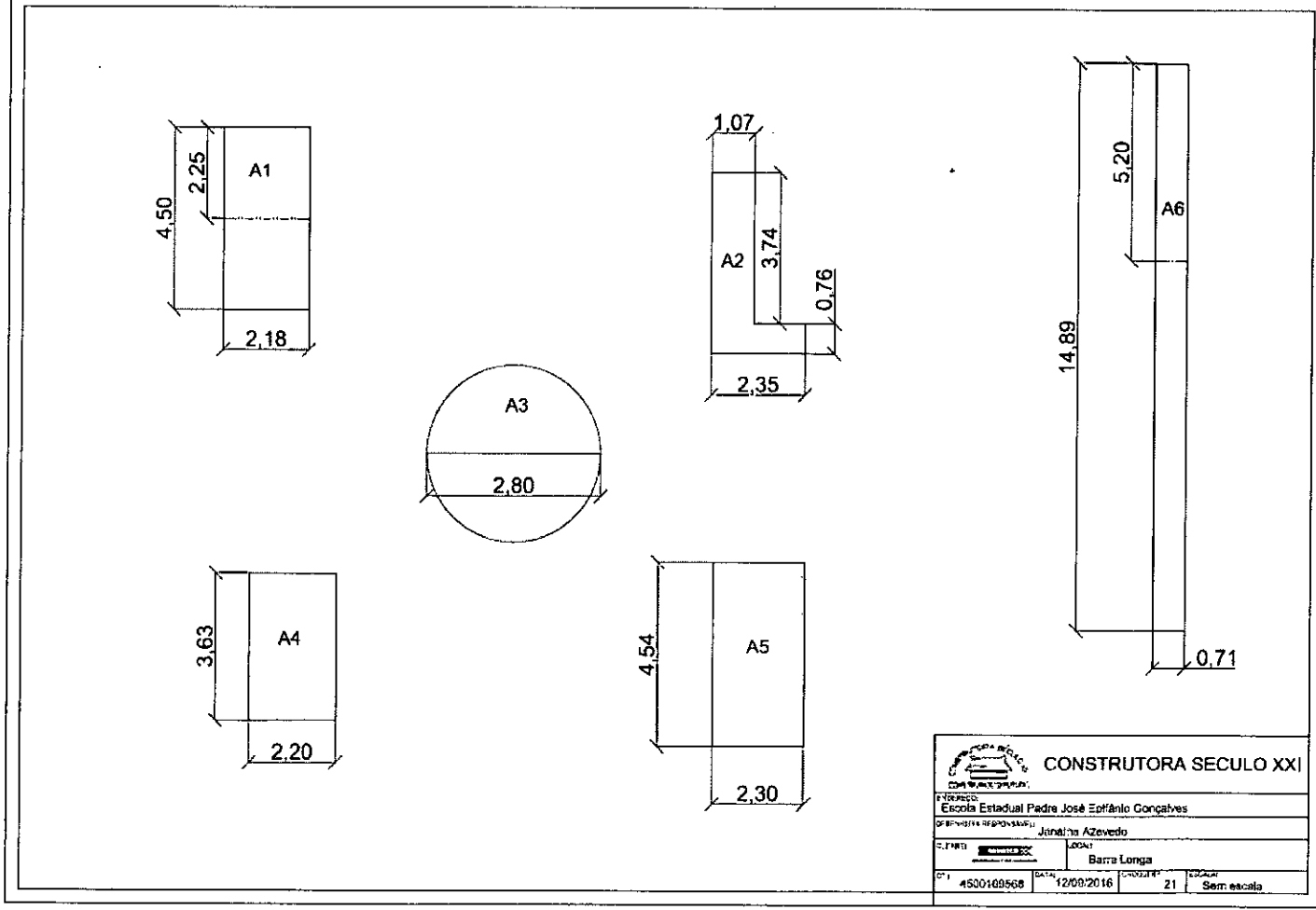

LIMBRANCO



FUNDAÇÃO
RENOVA
Fundação de Amparo à Pesquisa do Estado de São Paulo

FUNDAÇÃO RENOVA

Nº

REV
0

PÁGINA
143

6.3.2. MV 365

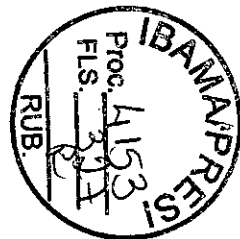
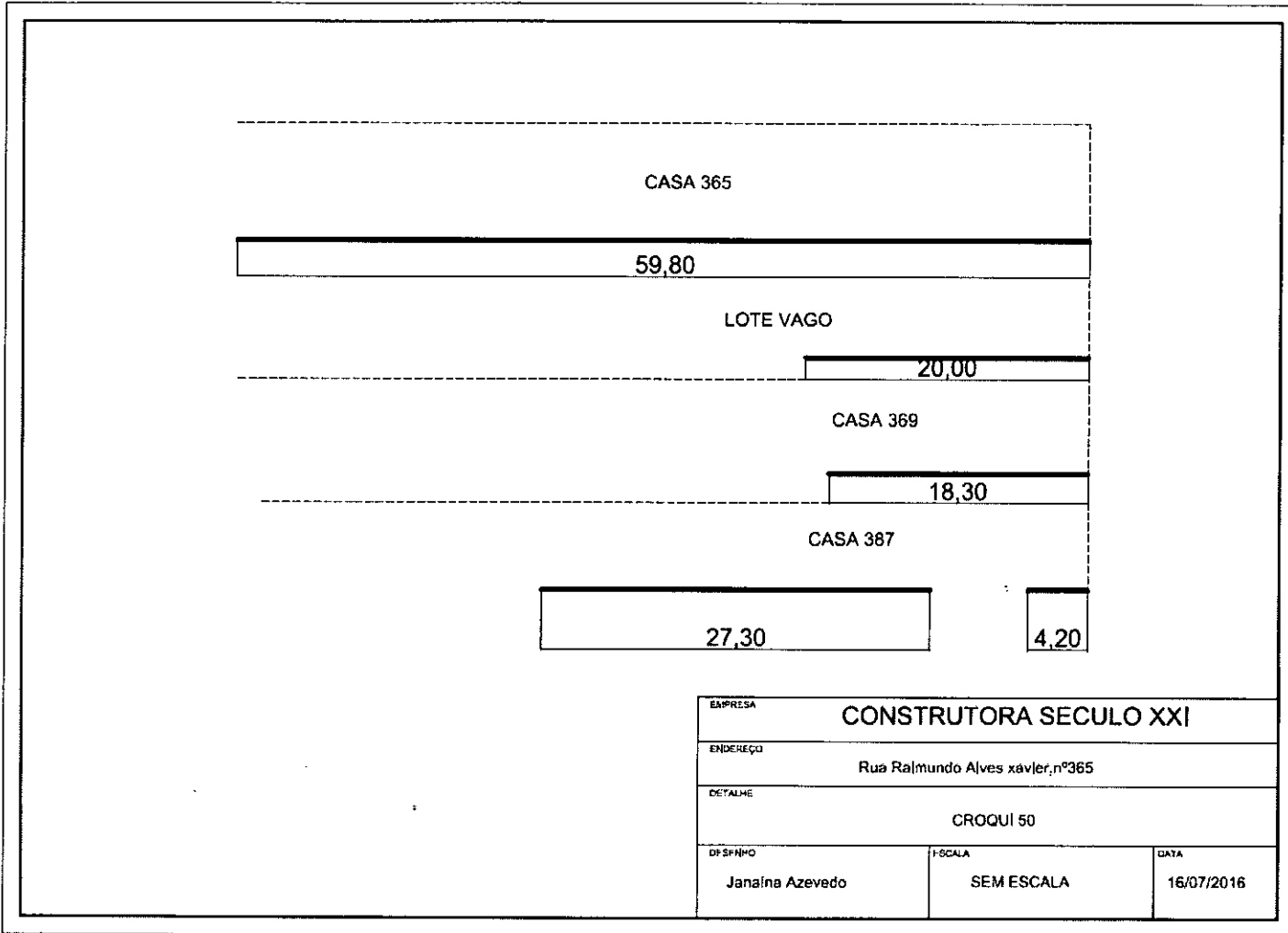

EMBRANCO



FUNDAÇÃO
renova
FUNDAÇÃO, S.A. - CNPJ: 07.042.170/0001-00

FUNDAÇÃO RENOVA

Nº

REV
0

PÁGINA
144

6.3.3. MV 369

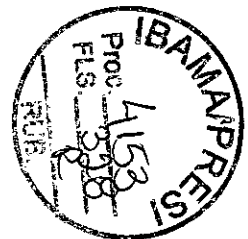
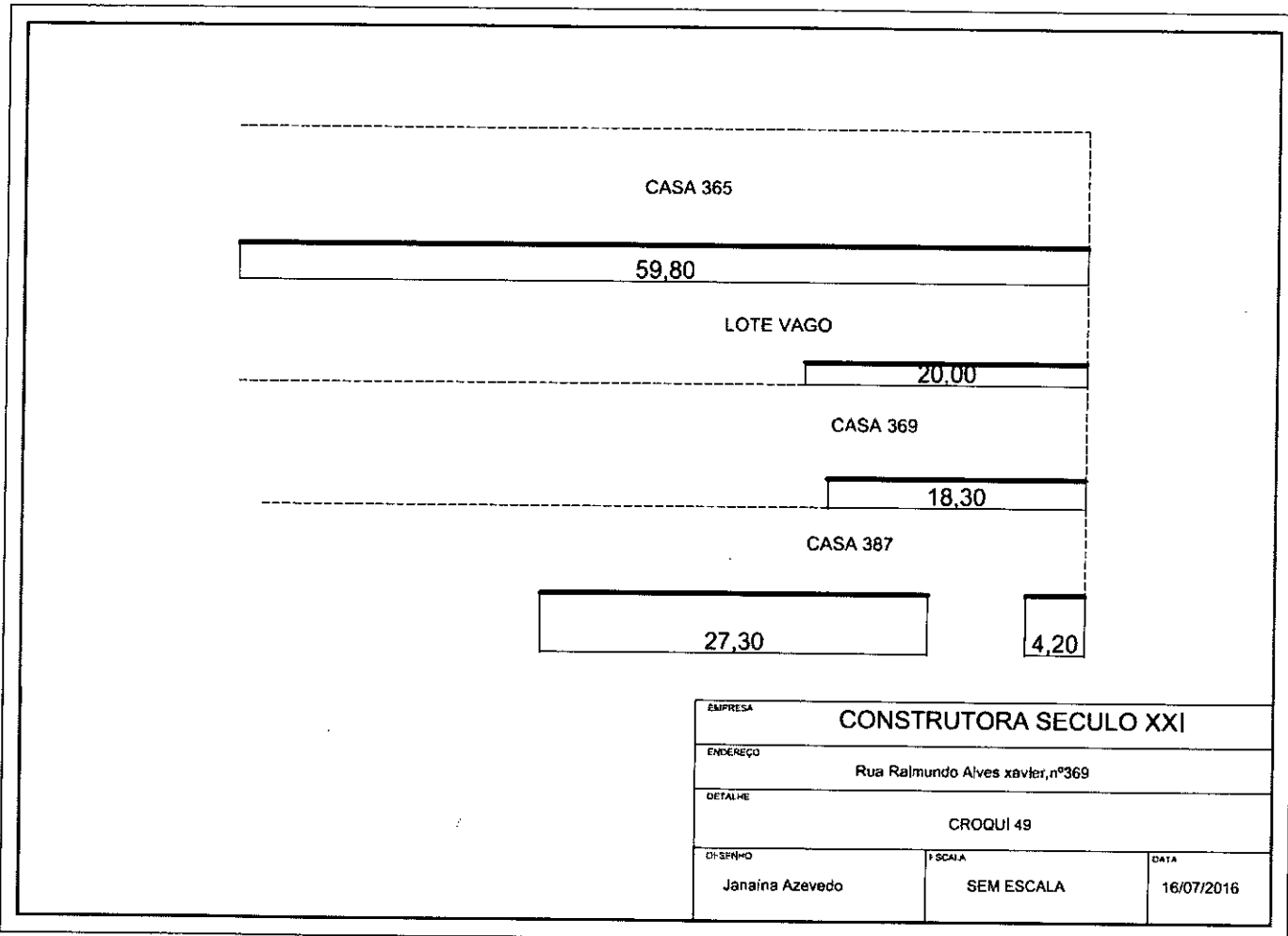

EM BRANCO



FUNDAÇÃO
Renova
FUNDAÇÃO RENOVADA - 14.038.011

FUNDAÇÃO RENOVA

Nº

REV
0

PÁGINA
145

6.3.4. MV 387

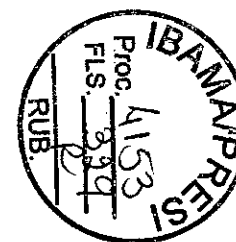
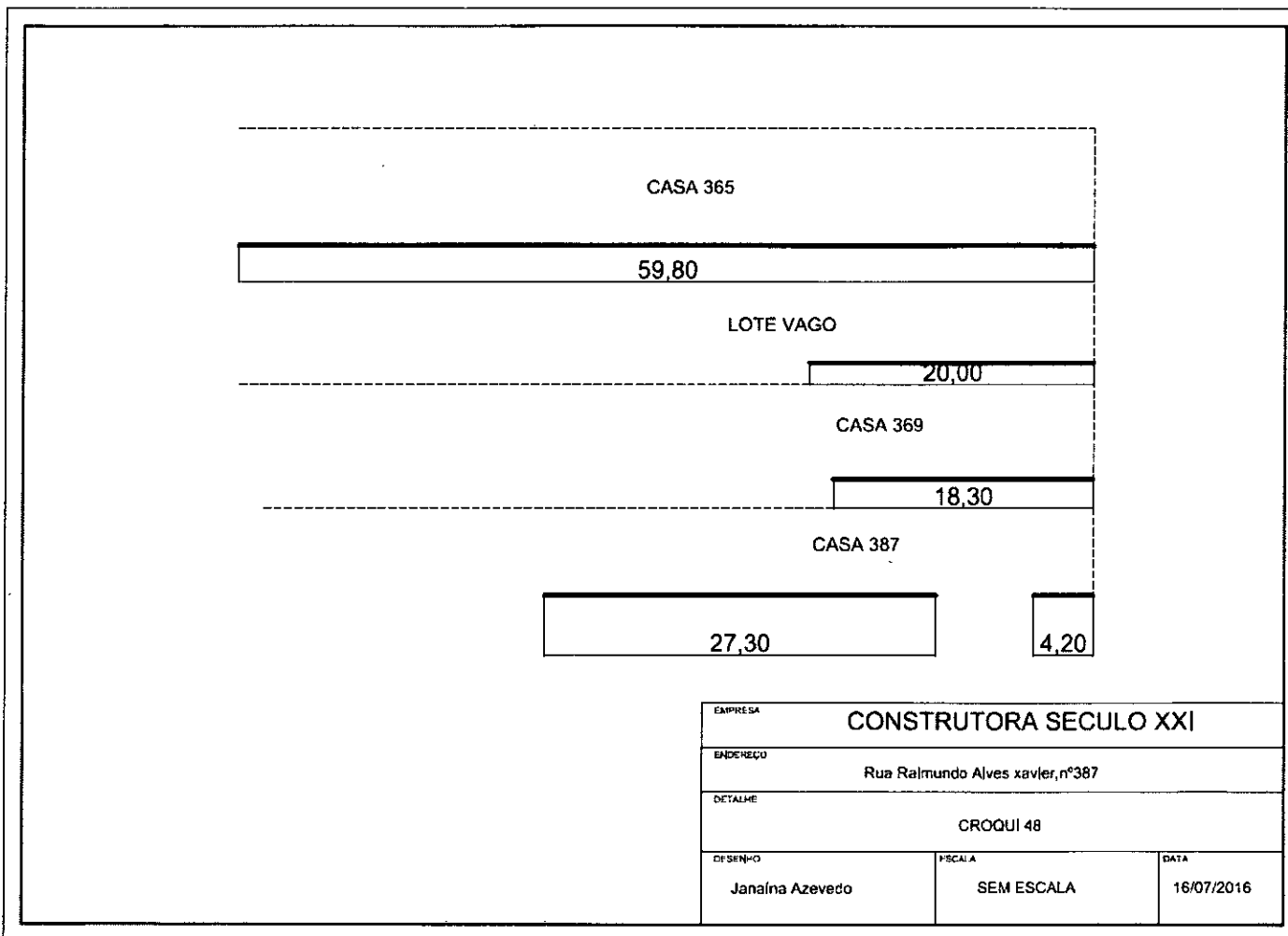

EM BRANCO

EM BRANCO

6.3.6. MV 545

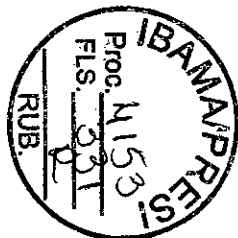
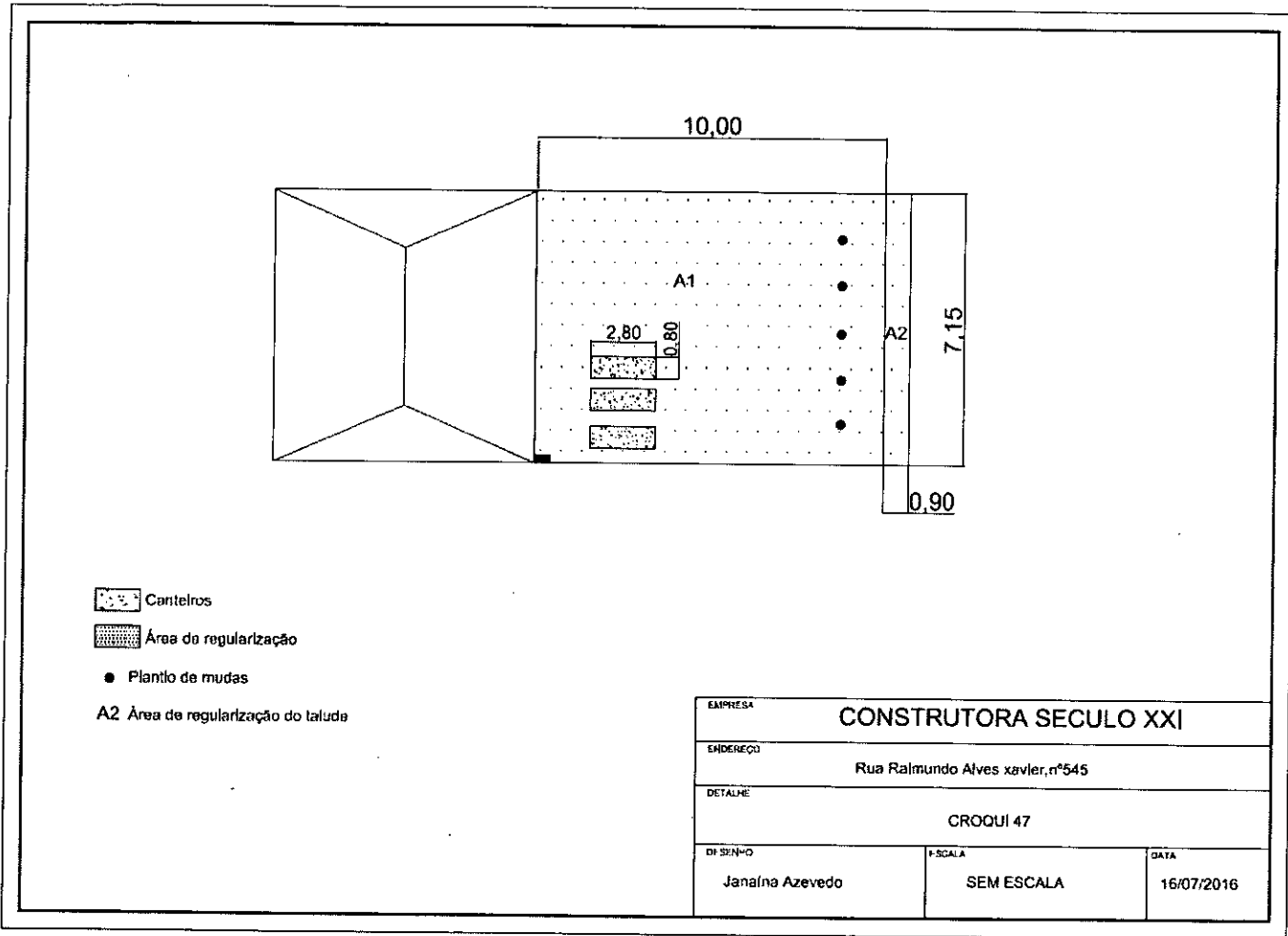

EM BRANCO



FUNDAÇÃO
Renova
FUNDAÇÃO RAIMUNDO ALVES XAVIER

FUNDAÇÃO RENOVA

Nº

REV
0

PÁGINA
148

6.3.7. MV 551

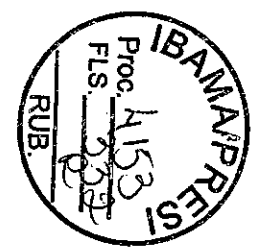
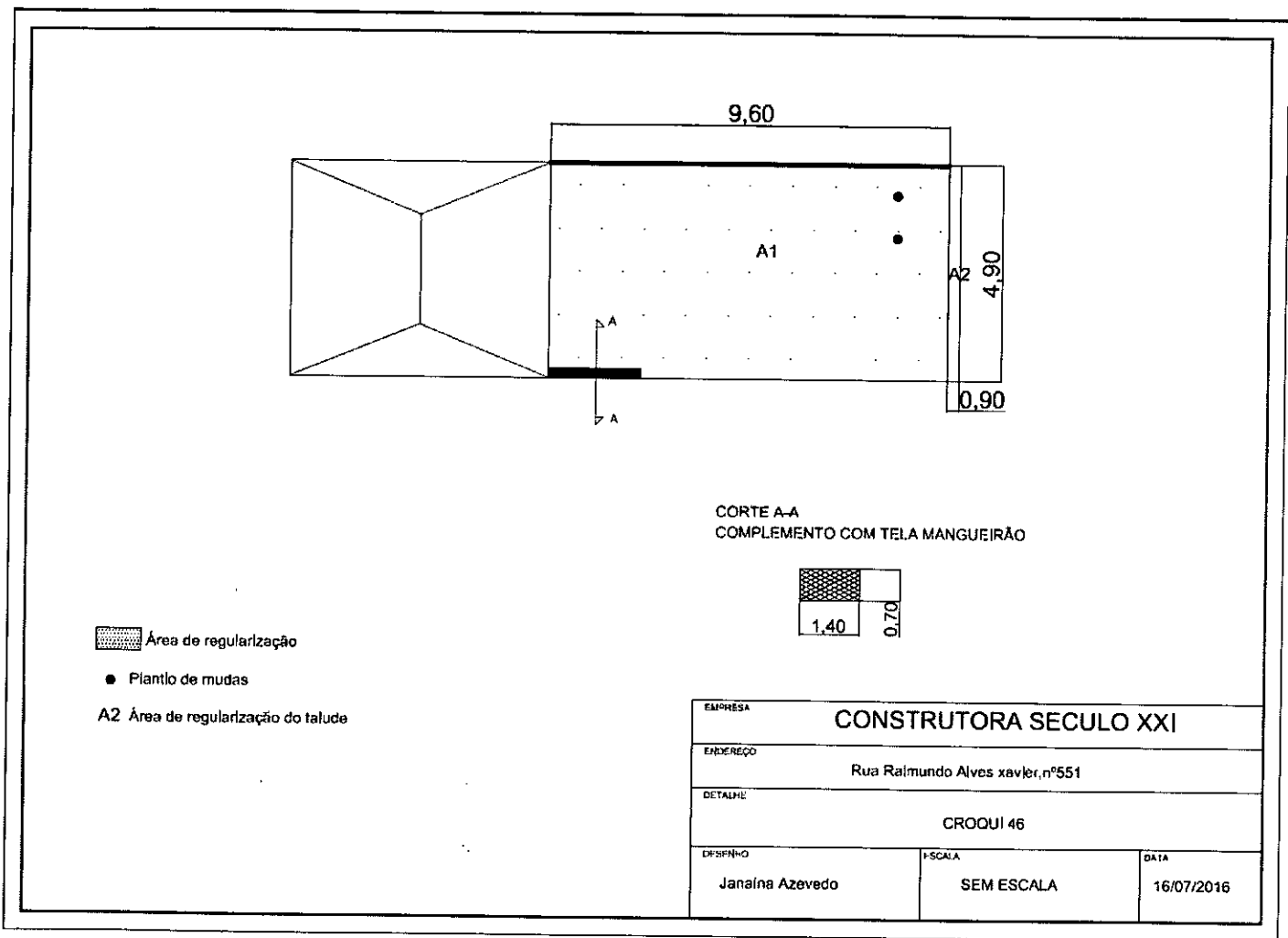

EMERSON



FUNDAÇÃO
renova
Fundação para a Renovação da Indústria

FUNDAÇÃO RENOVA

Nº

REV
0

PÁGINA
149

6.3.8. MV 561

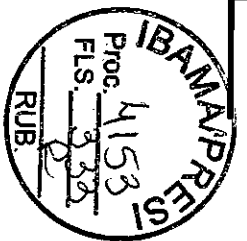
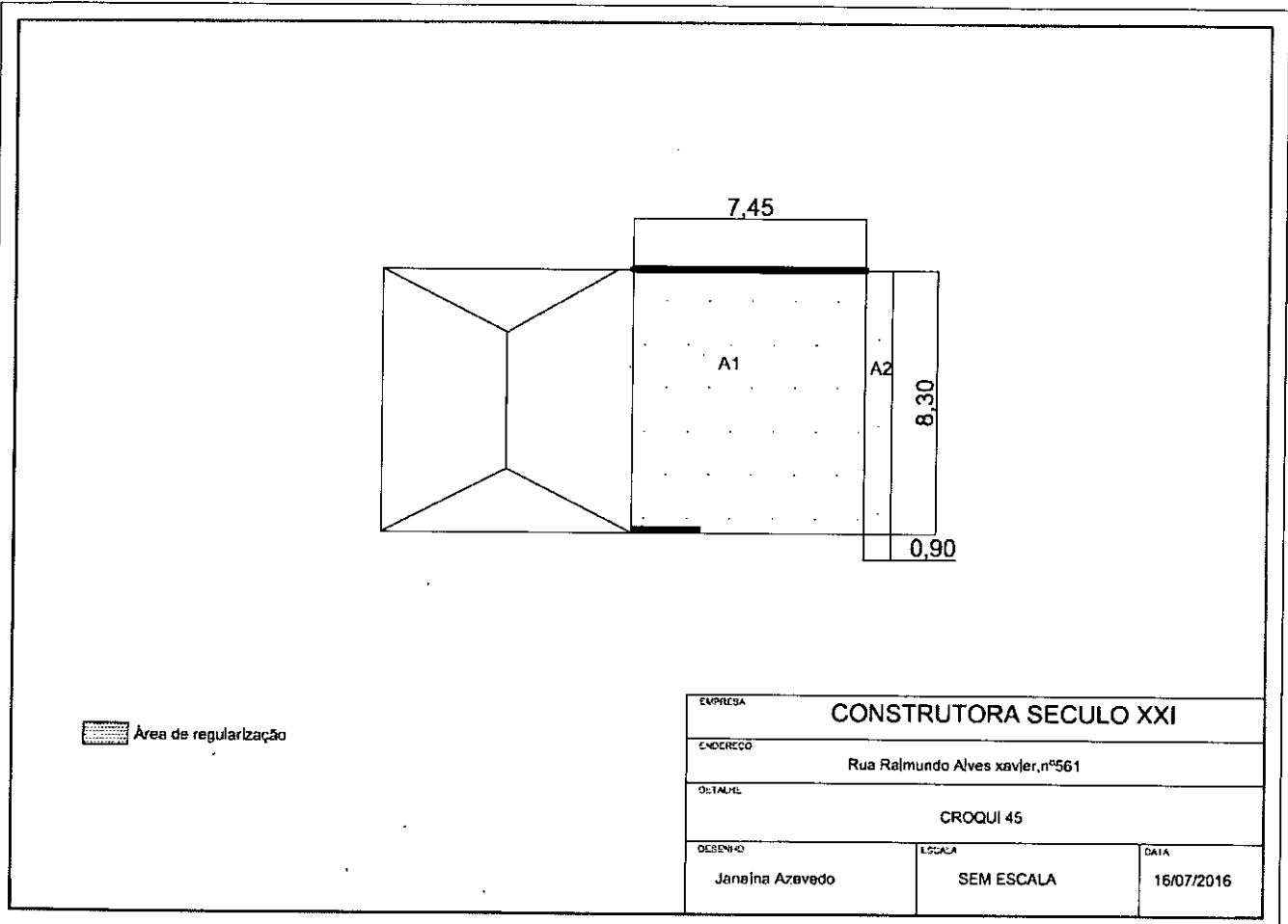

EM BRANCO

6.3.9. MV 573

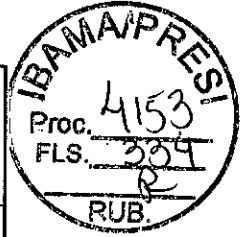
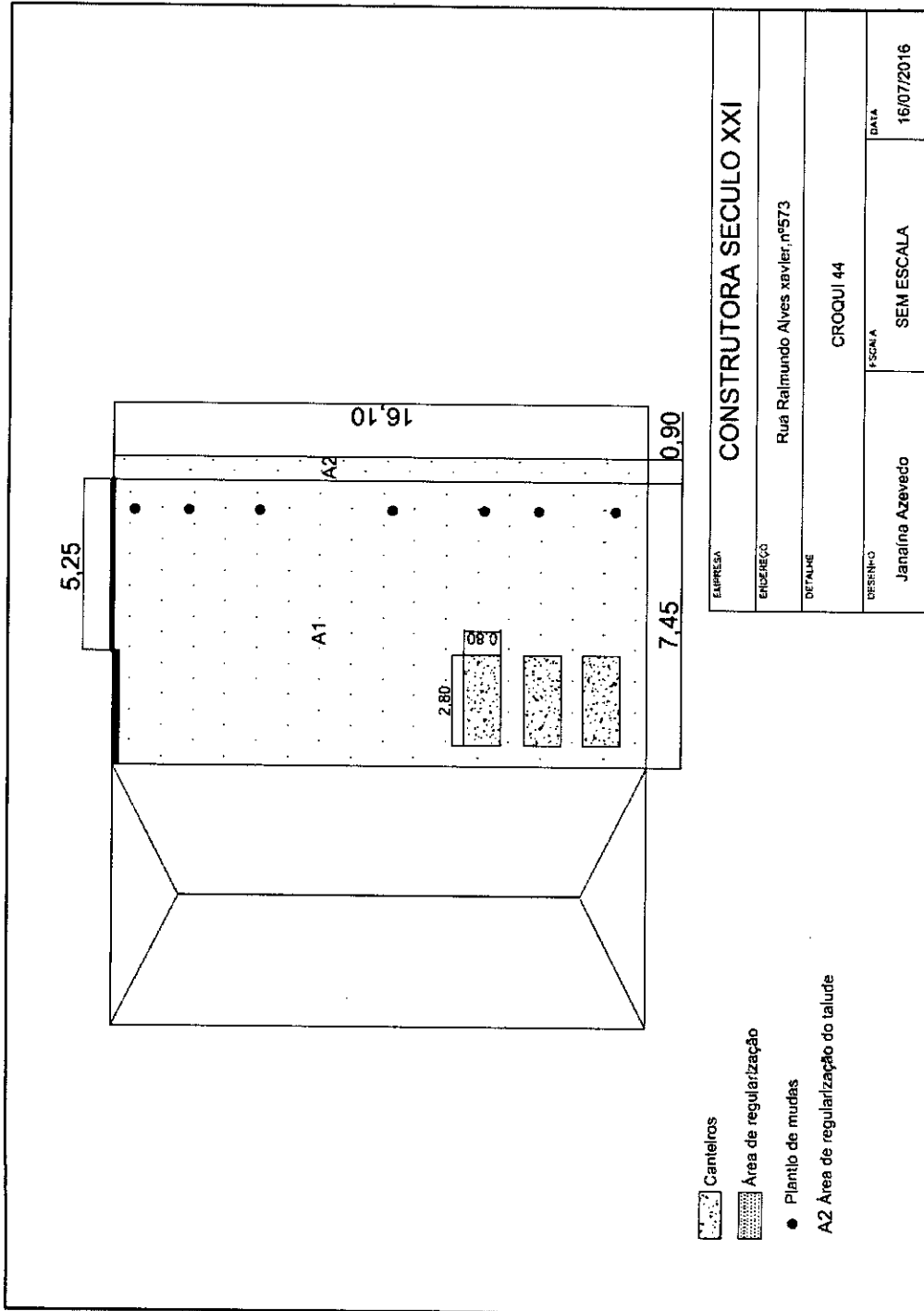

EMBRANCO



FUNDAÇÃO
renova
Fundação para a melhoria da qualidade de vida

FUNDAÇÃO RENOVA

Nº

REV
0

PÁGINA
151

6.3.10.

MV 583

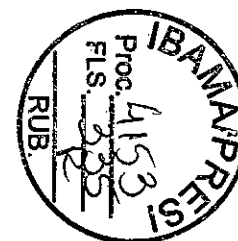
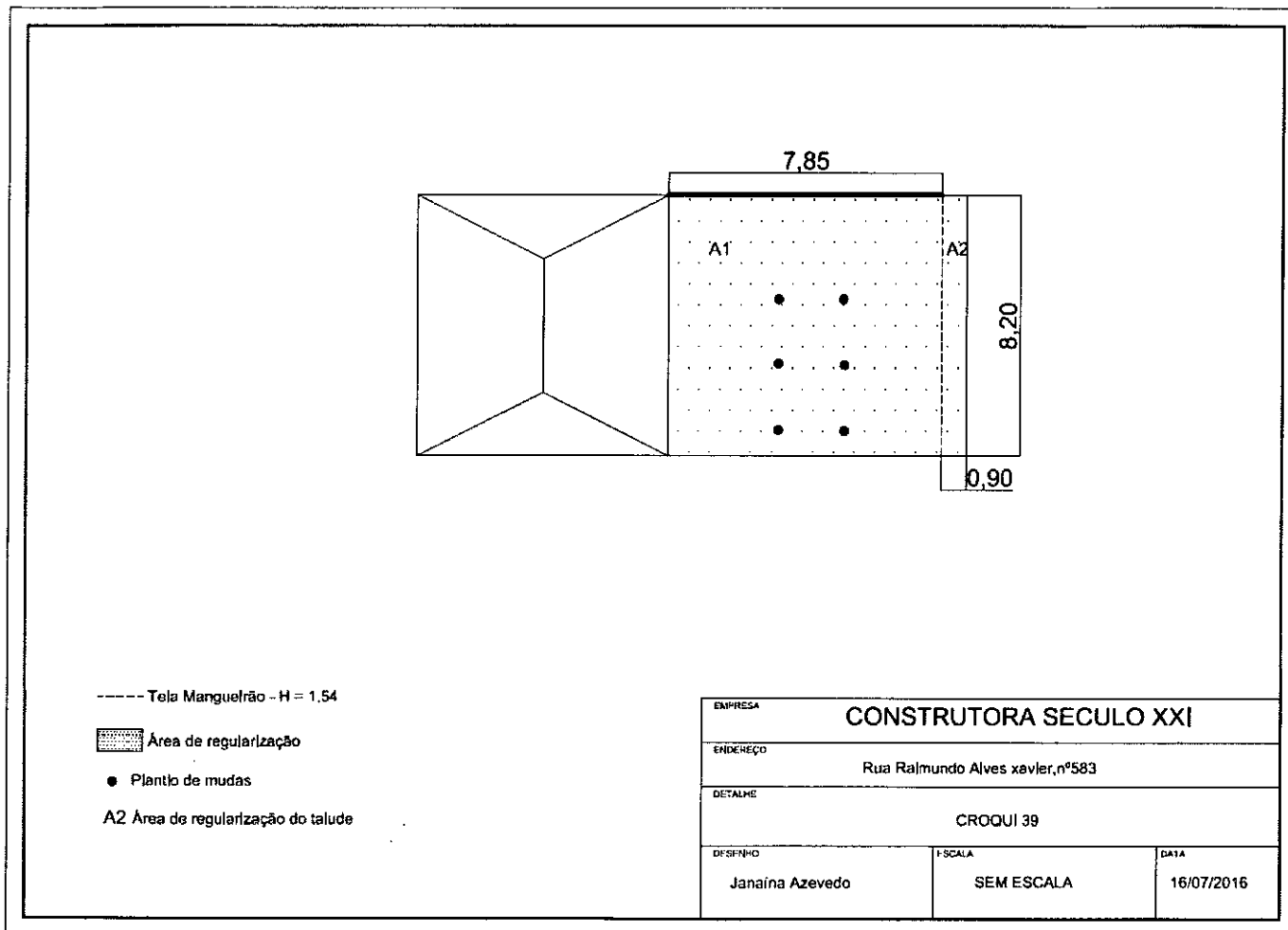

EMBRANCO



6.3.11. MV 593

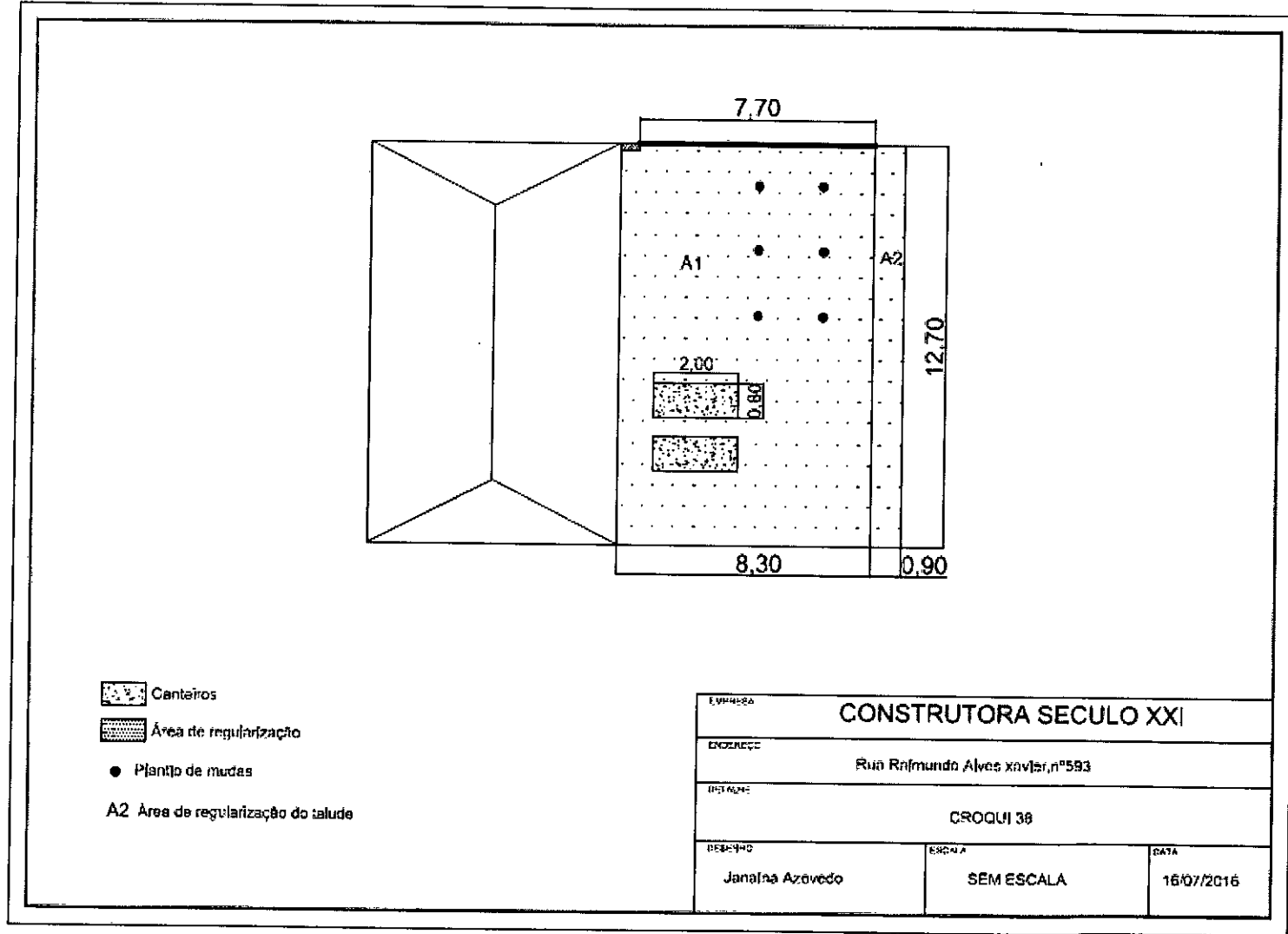

SAN FRANCISCO