

3.2.21. CE 130

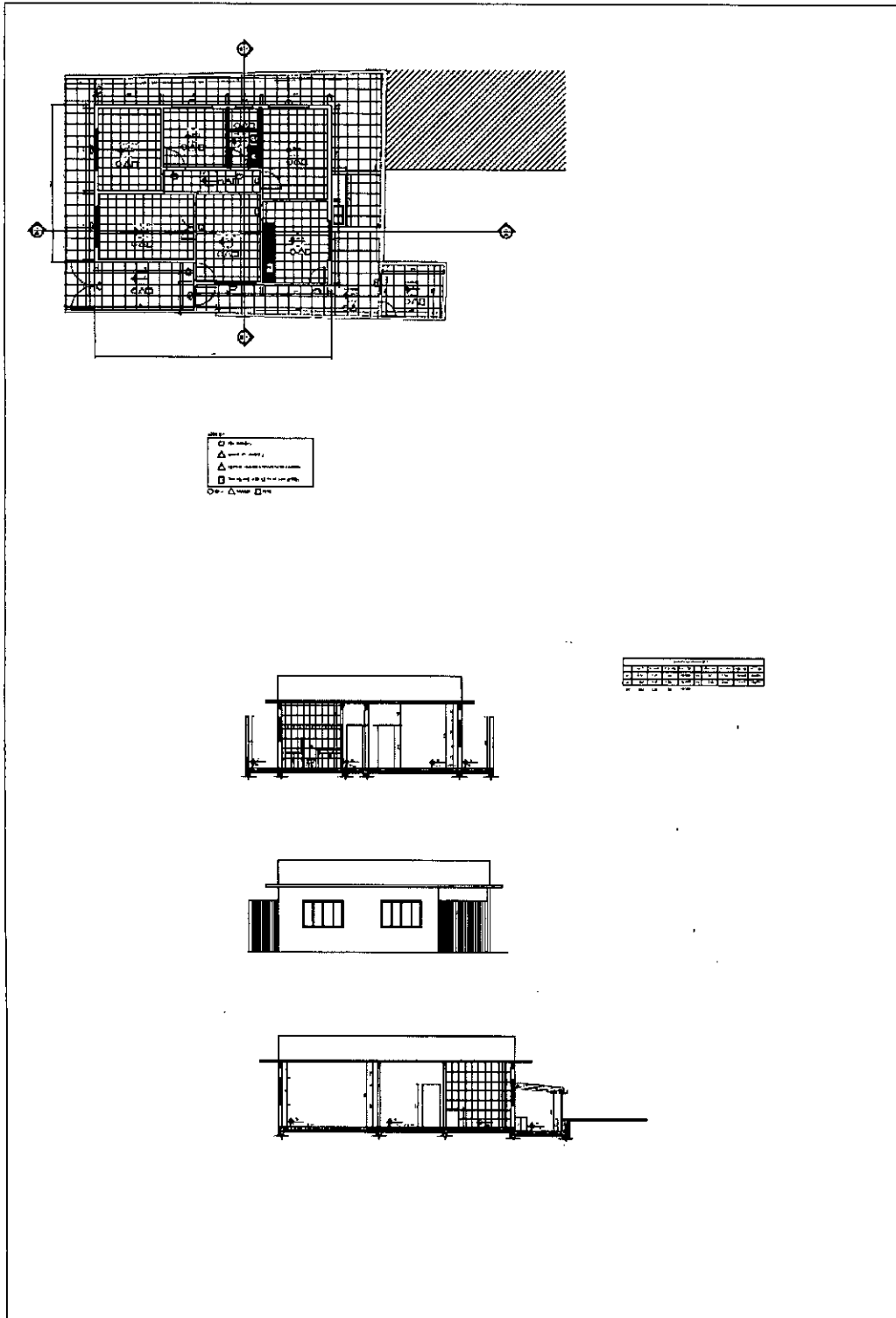
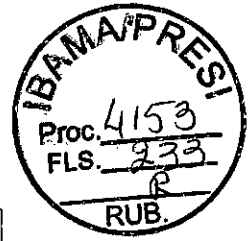

EM BRANCO

3.2.22.

CE 340

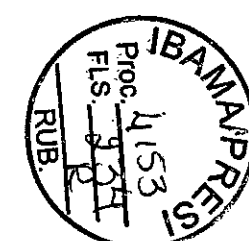
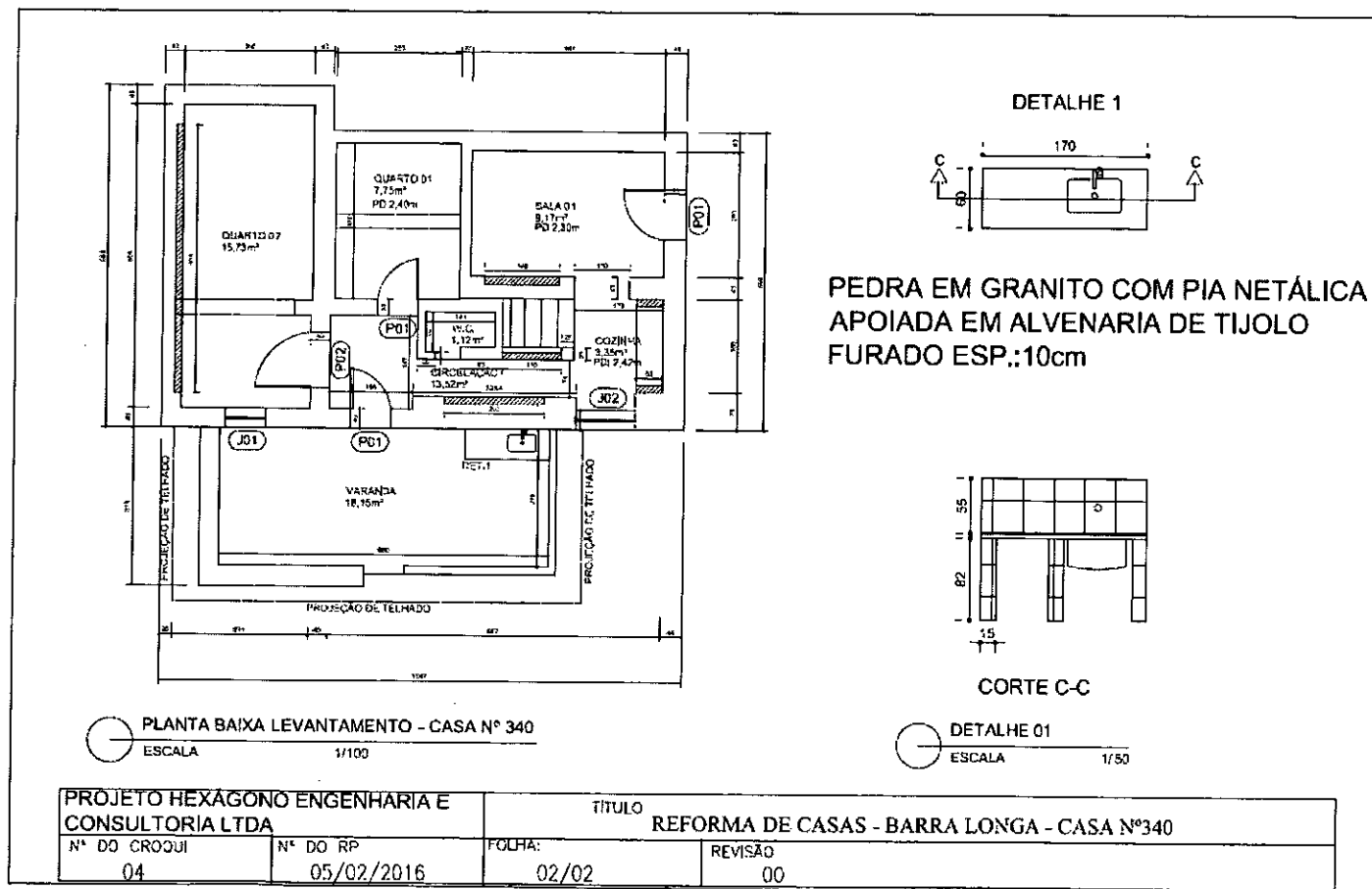

EM BRANCO



FUNDAÇÃO
RENOVA
PROMOVENDO A RECONSTRUÇÃO DE CASAS

FUNDAÇÃO RENOVA

Nº

REV
0

PÁGINA
50

3.2.23.

CE 156

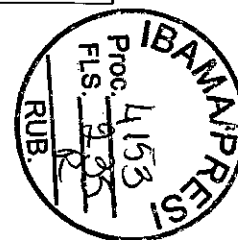
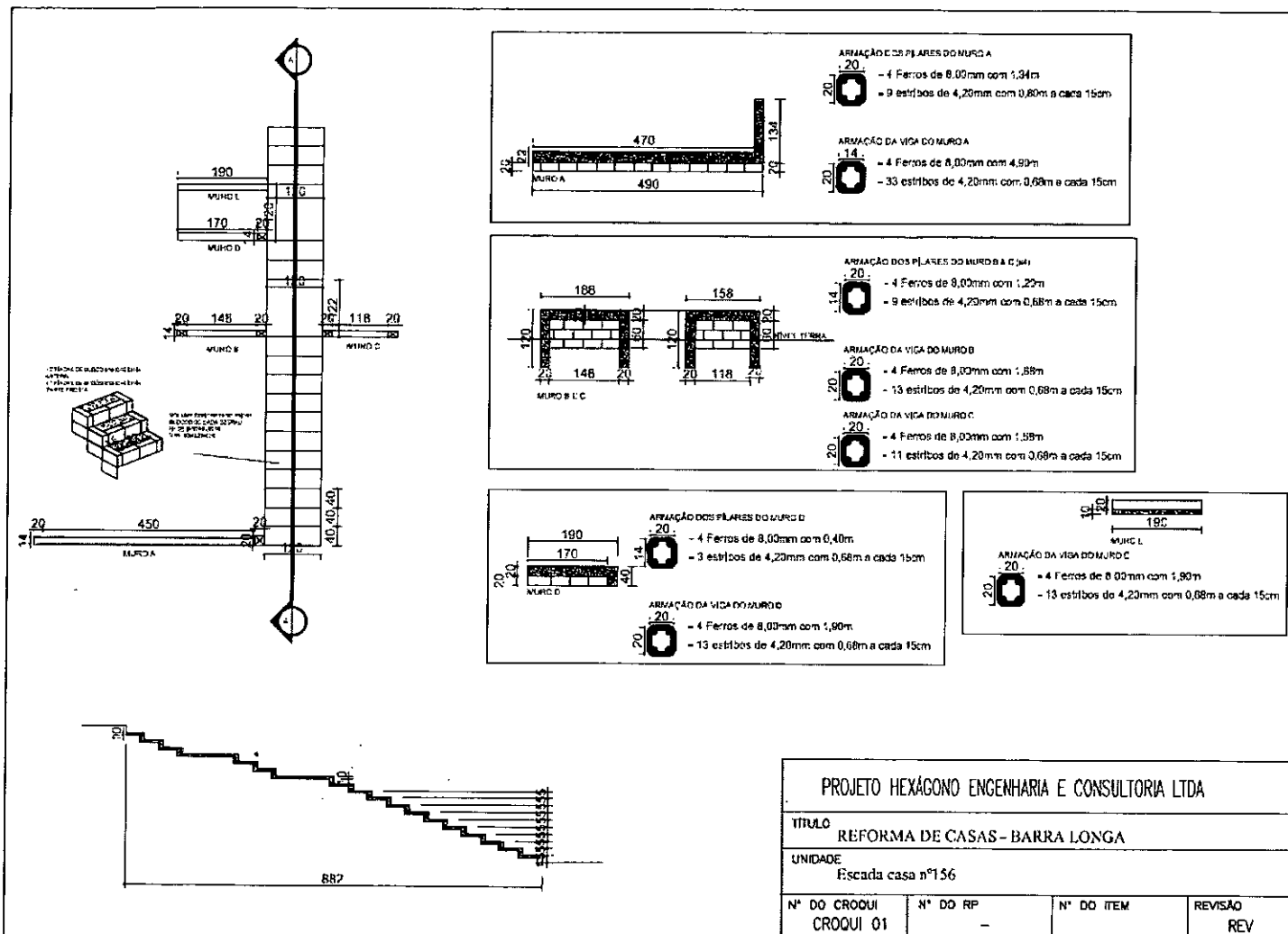

EMERSON

3.2.24. CE 56

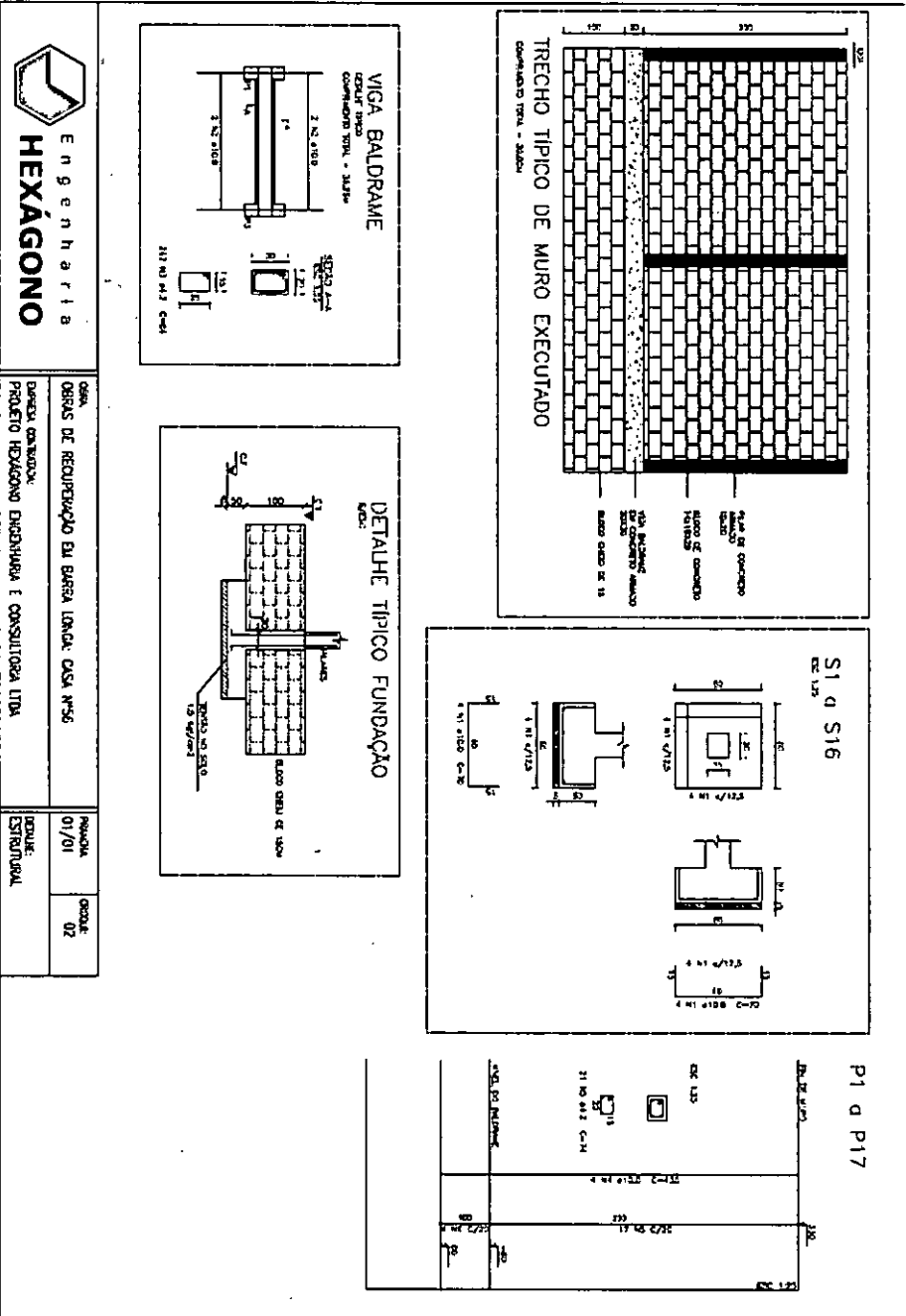

Engenharia
HEXÁGONO

OBRA: OBRAS DE RECONSTRUÇÃO EM BARRA LONGA. OCSA Nº36
 EMPRESA CONTRATADA: EMPRESA CONSTRUTORA E CONSULTORIA LTDA
 DATA: 01/01
 FASE: ESTRUTURAL

IBAMA/PRESI
 Proc. 4153
 FLS. 926
 RUB.

EMBRANCO

3.2.25. CE 105

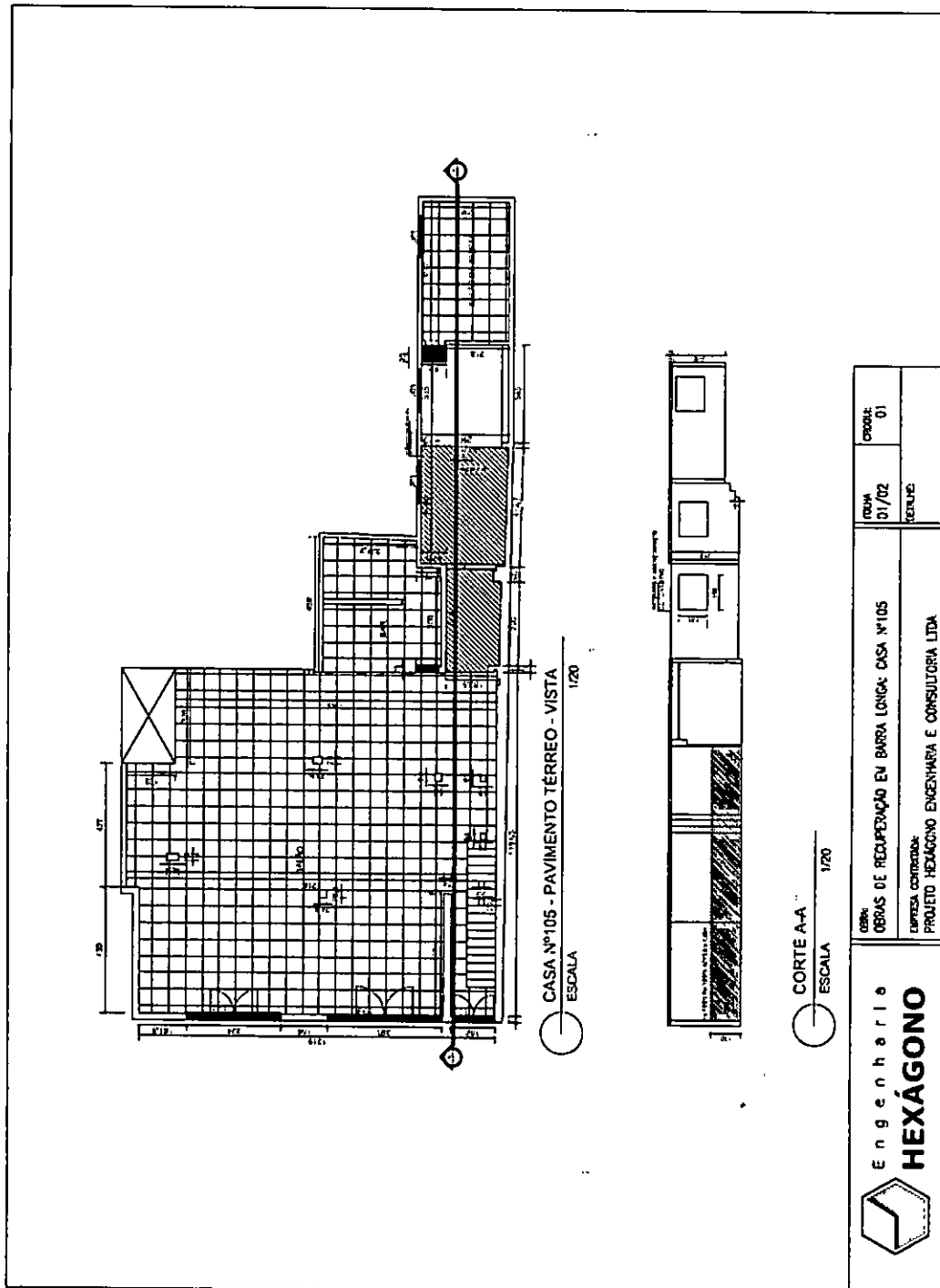
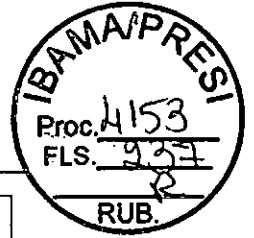

 Engenharia HEXÁGONO	OBRAS DE RECUPERAÇÃO EM BARRA LONGA - CASA Nº105 EMPRESA CONTRATADA: PROJETO HEXÁGONO ENGENHARIA E CONSULTORIA LTDA		OBRAS: 01/02	OBRAS: 01
			RUBRICADO	

EM BRANCO

3.2.26. CE 46

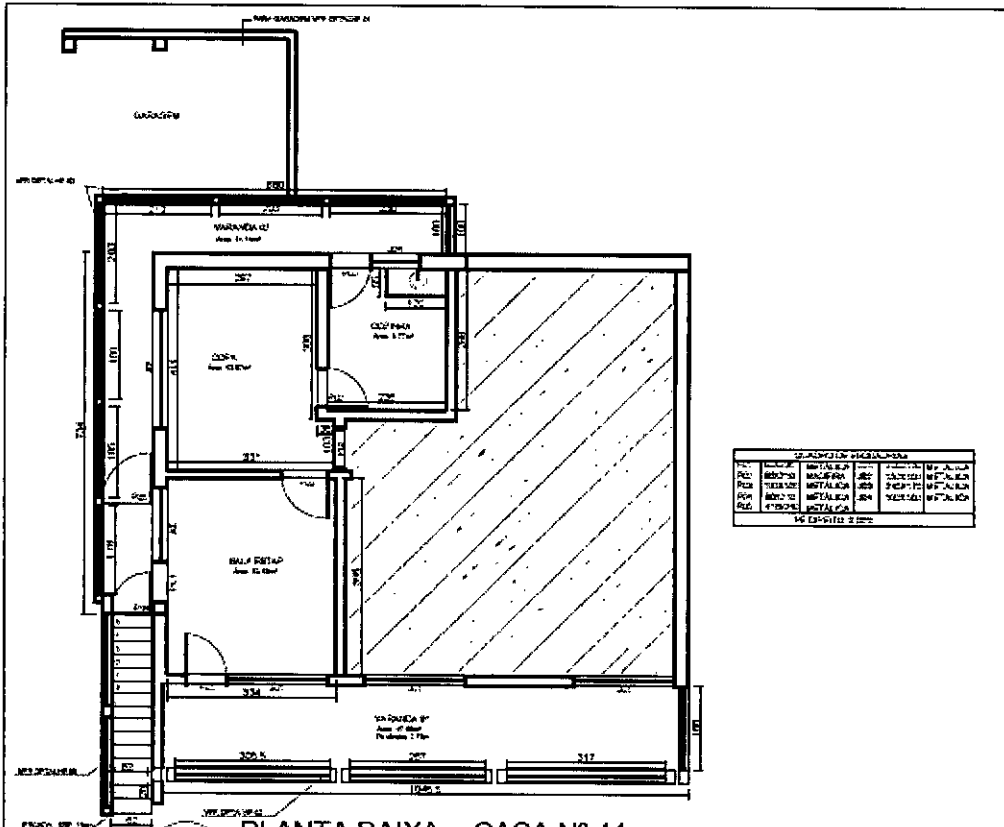
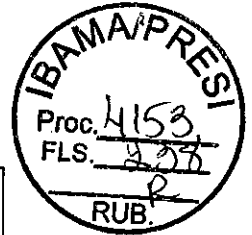

LEGENDA DE MATERIAIS			
COL	CONCRETO	METALICO	METALICO
FOR	ALUMINIO	METALICO	METALICO
FOR	ALUMINIO	METALICO	METALICO
FOR	ALUMINIO	METALICO	METALICO

PLANTA BAIXA - CASA Nº 44

ESCALA

1/100

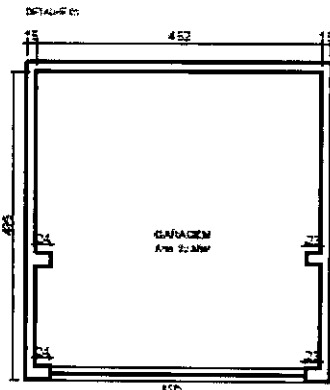

DETAILHE 02



DETAILHE DO GRADIL METÁLICO INSTALADO NA VARANDA 01 E 02 - C 2448

DETAILHE 03



DETAILHE DO GRADIL METÁLICO INSTALADO NA ESCADA - C 977



**Engenharia
HEXÁGONO**

OBRA: OBRAS DE RECUPERAÇÃO EM BARÇA LONCA: CASA Nº45
 EMPRESA CONTRATADA: PROJETO HEXÁGONO ENGENHARIA E CONSULTORIA LTDA.

PROJETO: 21/01

PROD.: 01

DETALHE ESTRUTURAL

EM BRANCO

3.2.27. CE 12

G006940-C-100216- CASA 12 - ARQ-Folha 01-R00

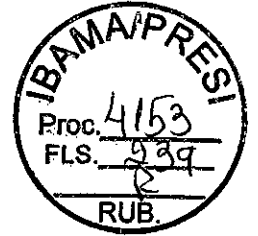
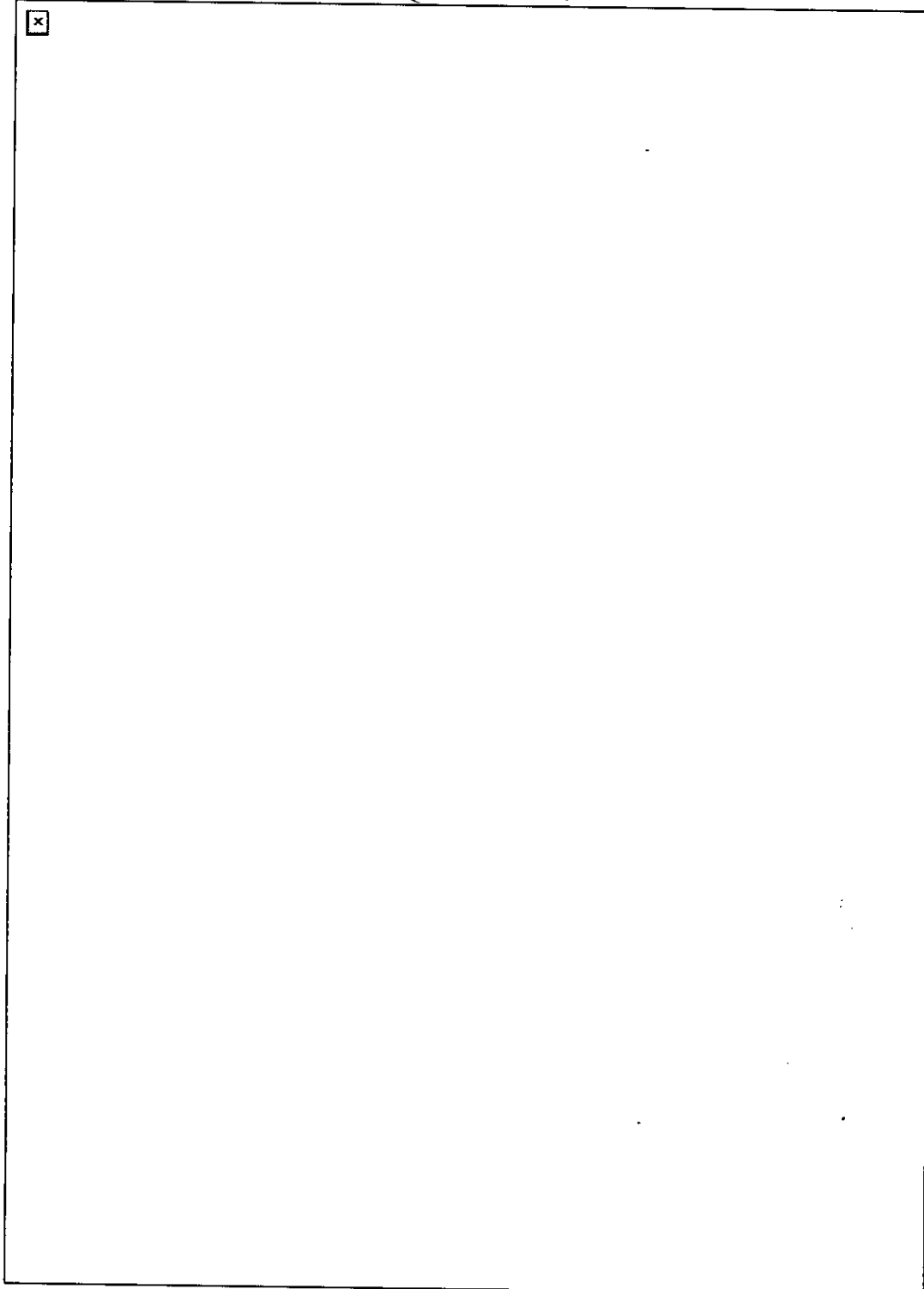

EM BRANCO



FUNDAÇÃO
renova
PROJETAR, RECONSTRUIR, RECONSTRUIR

FUNDAÇÃO RENOVA

Nº

REV
0

PÁGINA
55

G006940-C-100217- CASA 12 - ARQ-Folha 02-R00

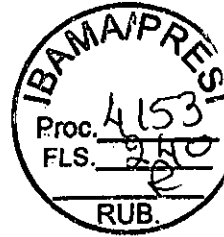
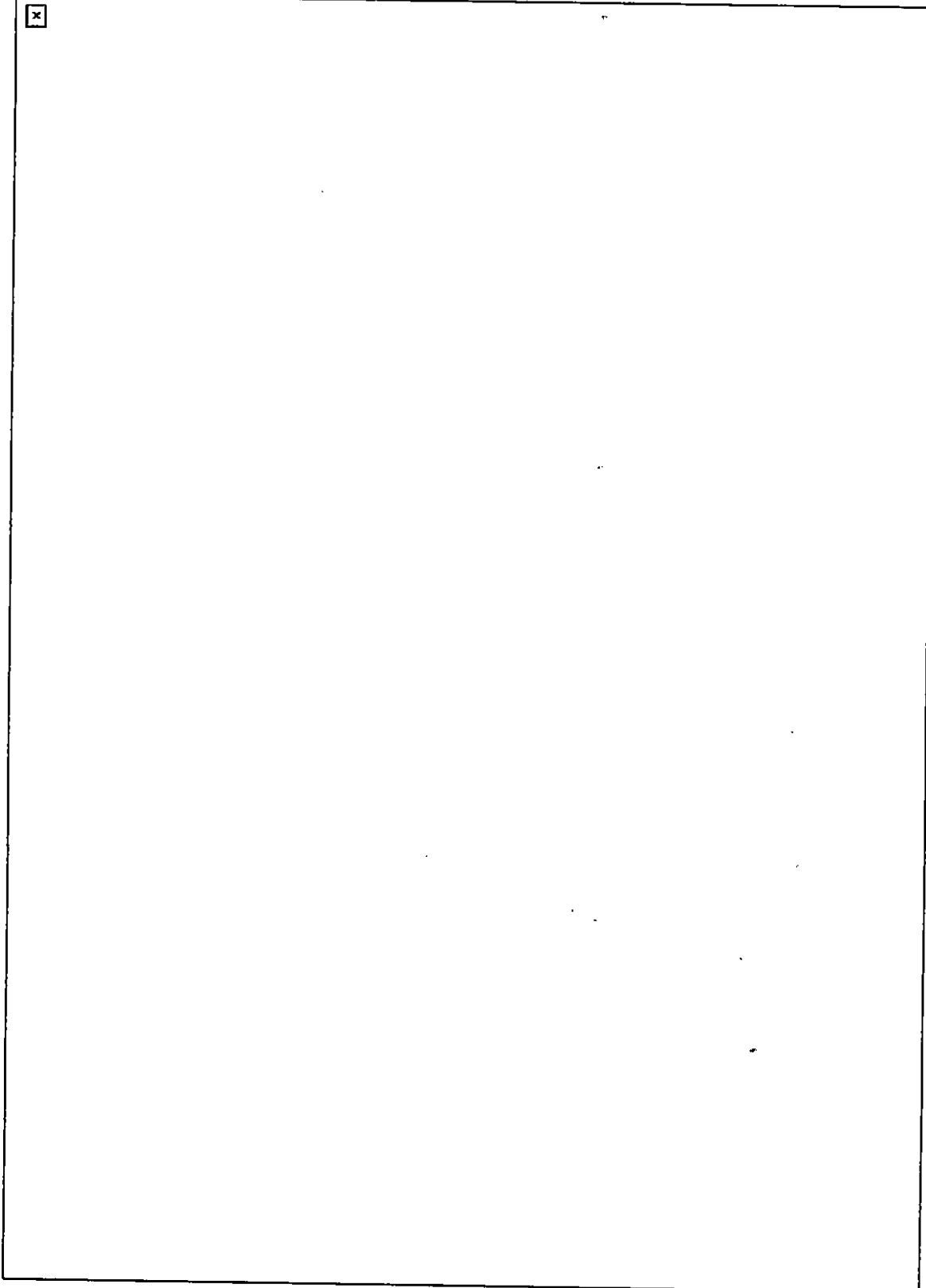

EM BRANCO

G006940-C-100218- CASA 12 - ARQ-Folha 03-R00

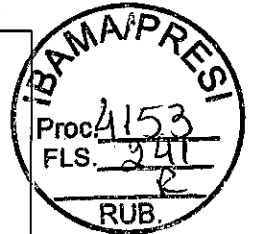

MEMORANDUM
FOR THE RECORD



3.2.28. CE 120

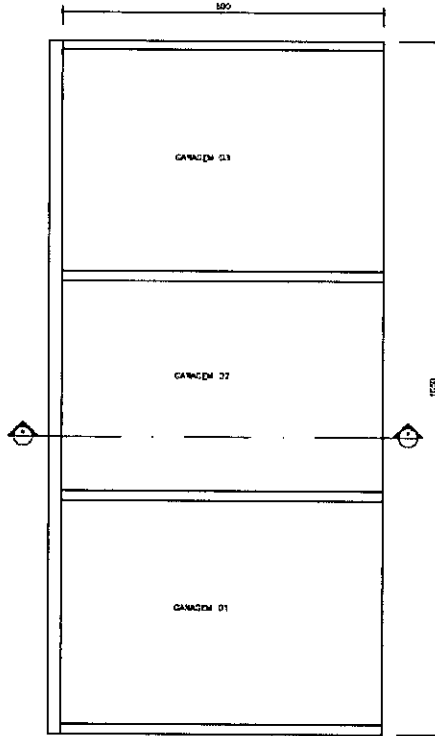
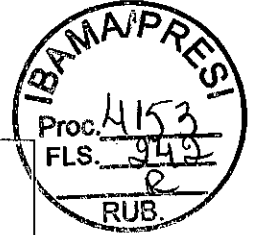

PLANTA BAIXA - GARAGEM

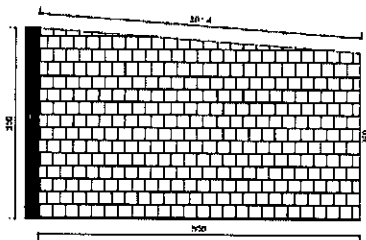

CORTE B-B - GARAGEM



HEXÁGONO
Engenharia

OBRA:
OBRAS DE RECUPERAÇÃO EM BARRA LONGA: CASA Nº120

PLANCHAS:
03/G3

CRD.01:
01

EMPRESA CONTRATADA:
PROJETO HEXÁGONO ENGENHARIA E CONSULTORIA LTDA

DETALHE:
ESTRUTURAL

MEMBERSHIP

3.2.29. CE 140

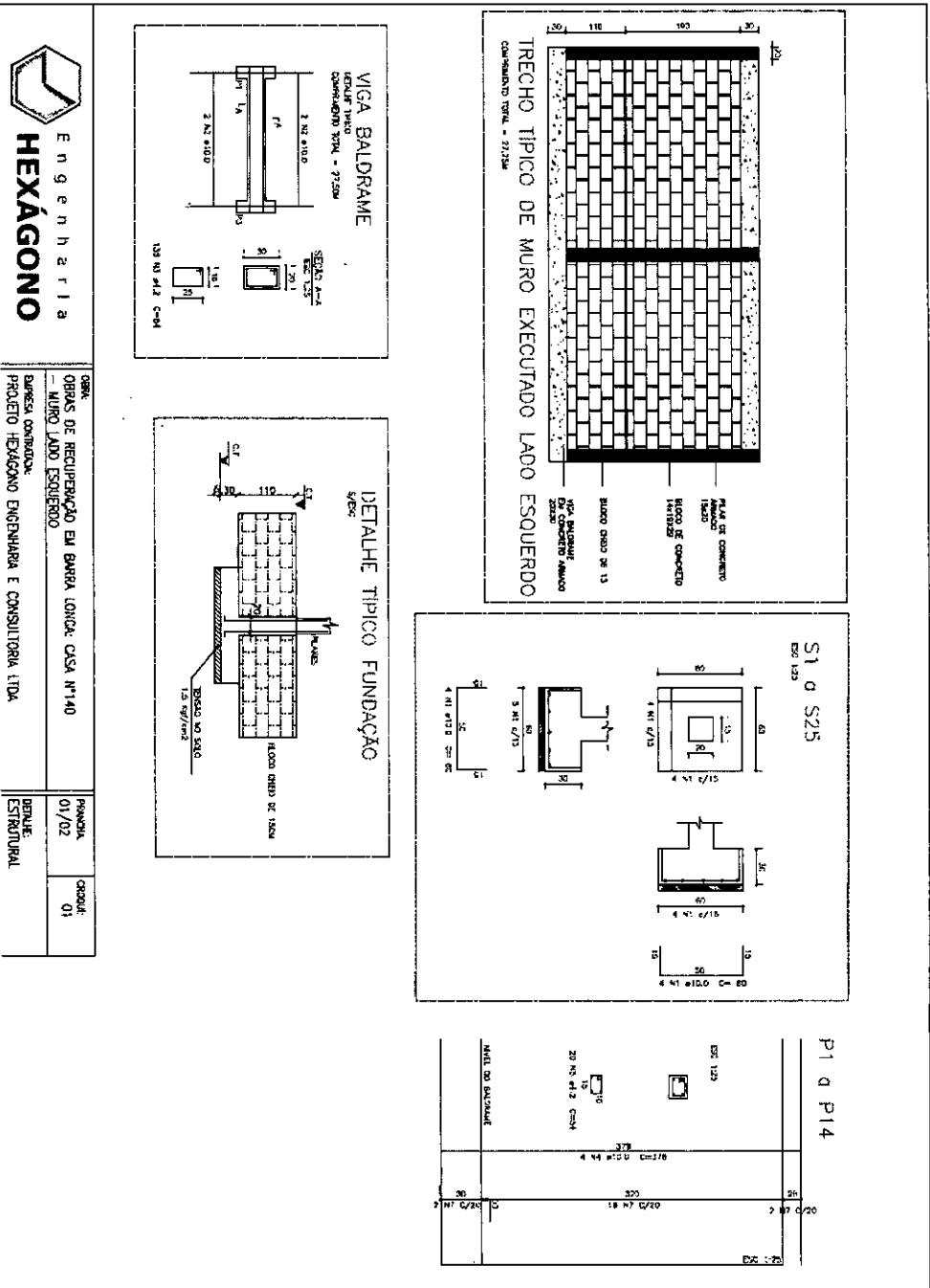

OBRA: OBRAS DE REQUERIMENTO EM BARRA LONCA: CASA Nº140
— MURO LADO ESQUERDO
SERV. CONTROLAD.: PROJETO HEXÁGONO ENGENHARIA E CONSULTORIA LTDA

PRELIMINAR: 01/02
DETALHE ESTRUTURAL

CHOFÉ: 01



EMERSON

MEMBRANCO

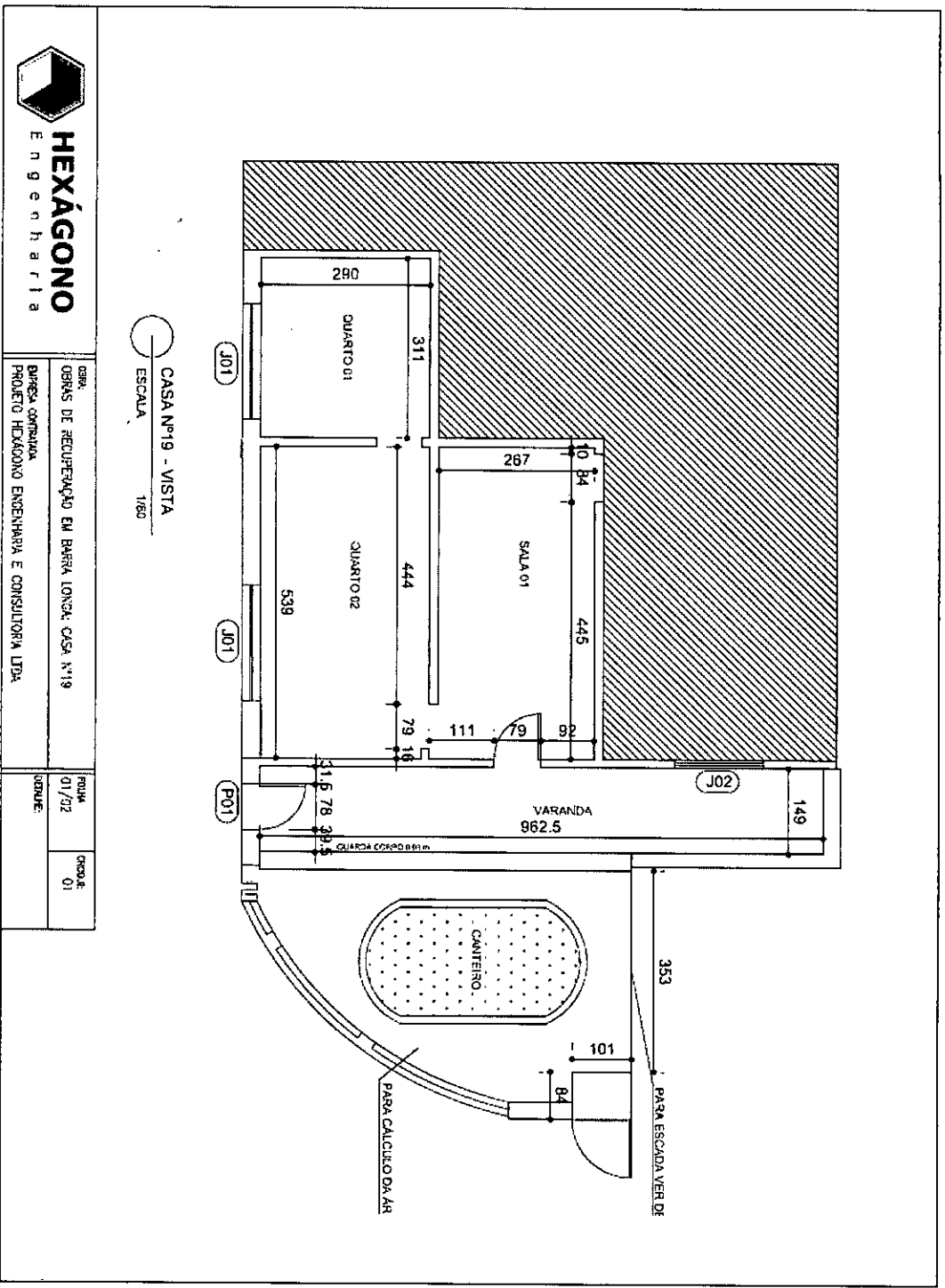

CASA Nº19 - VISTA
 ESCALA 1/80



HEXÁGONO
 Engenharia

OBJETO:	OPERAÇÕES DE RECUPERAÇÃO EM BARRA LONGA, CASA Nº19	FOLHA:	01/72	ORÇAMENTO:	01
EMPRESA:	HEXÁGONO ENGENHARIA E CONSULTORIA LTDA	DATA:	01/72	PROJETO:	HEXÁGONO ENGENHARIA E CONSULTORIA LTDA

3.2.31. CE 49



EM BRANCO

3.2.32. CE 19

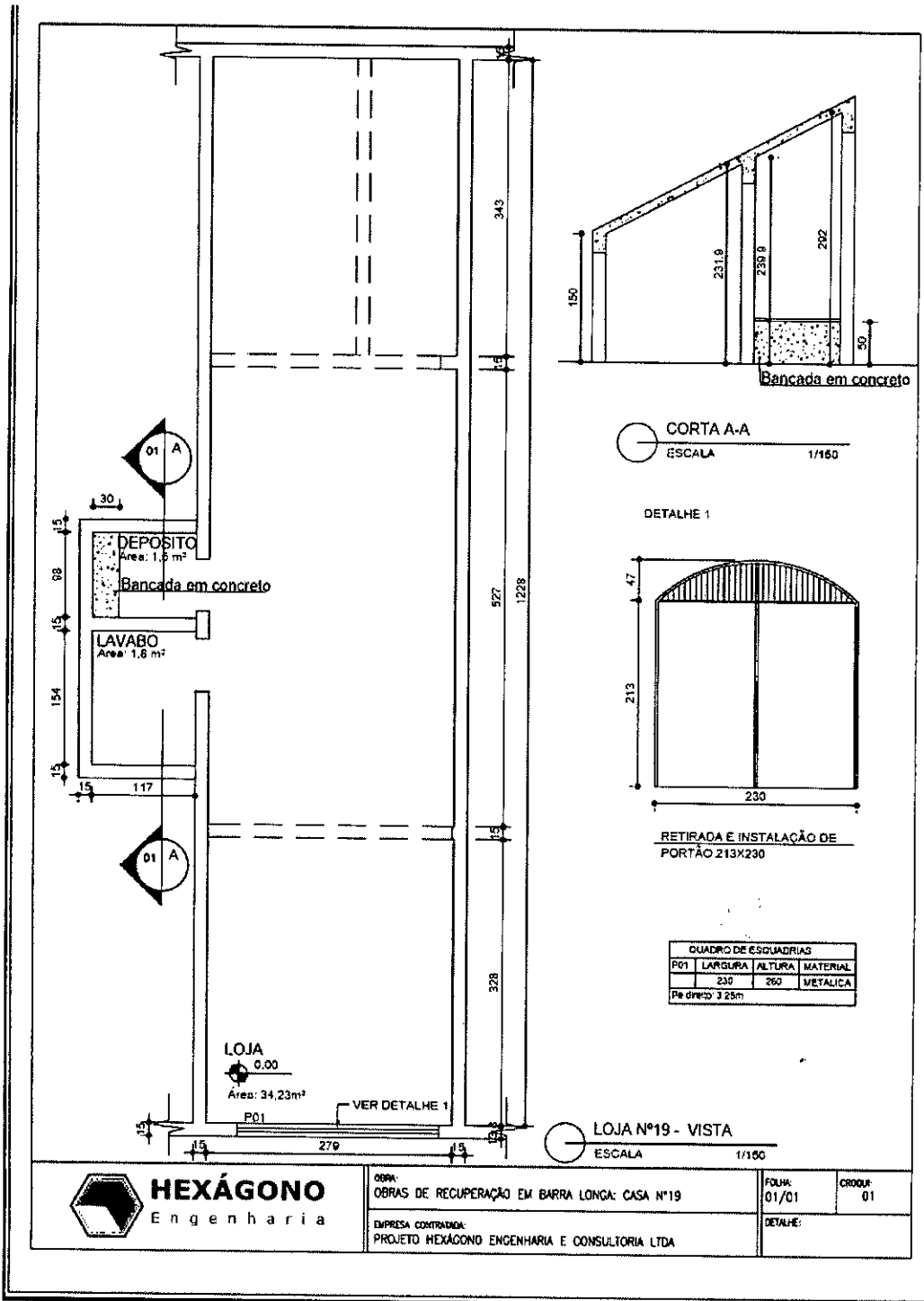
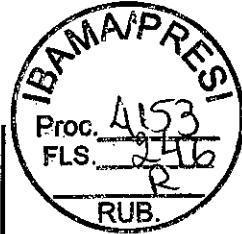

EM BRANCO

3.2.33. CE 70

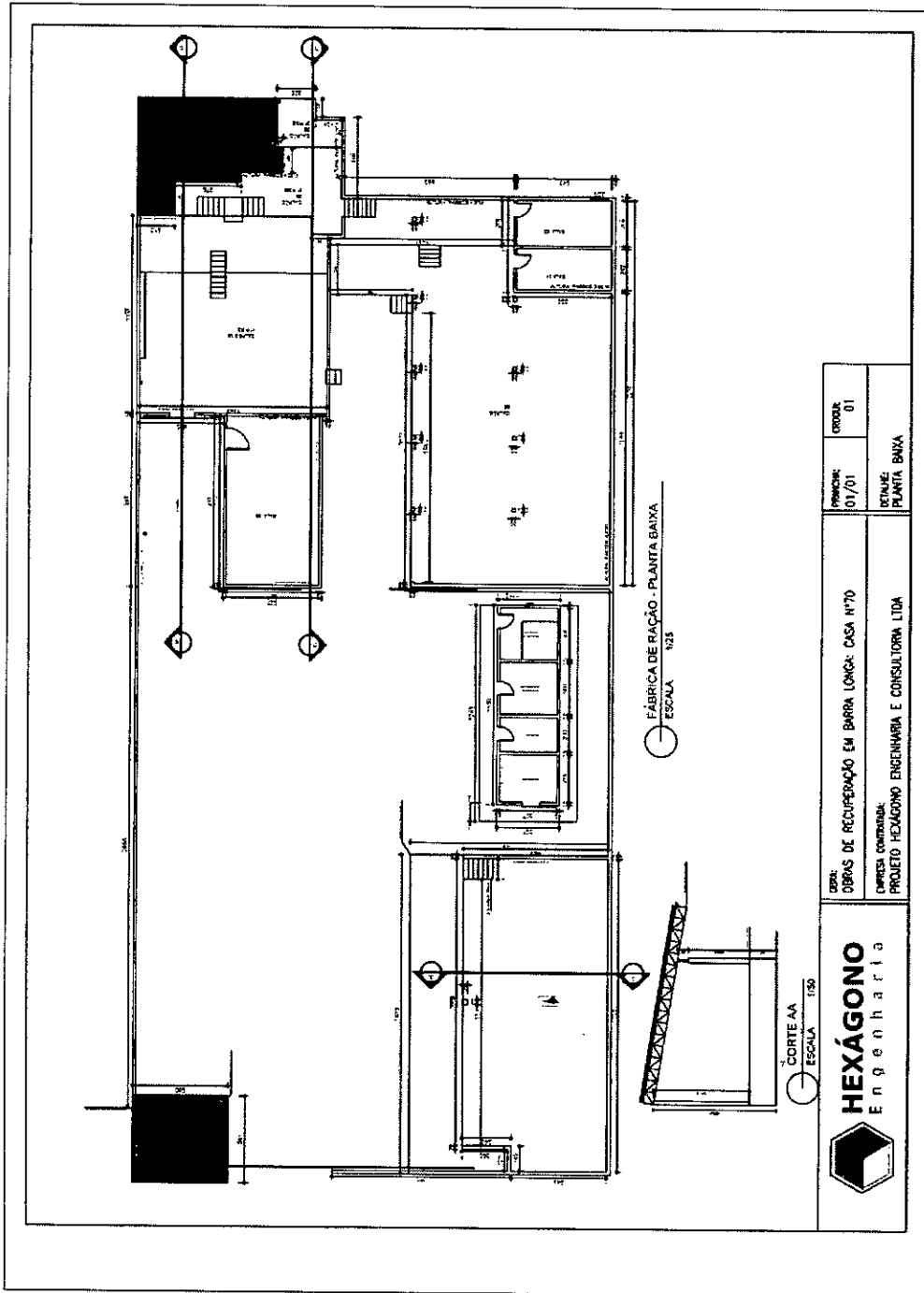
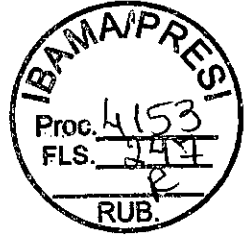

EM BRANCO

CASA Nº38

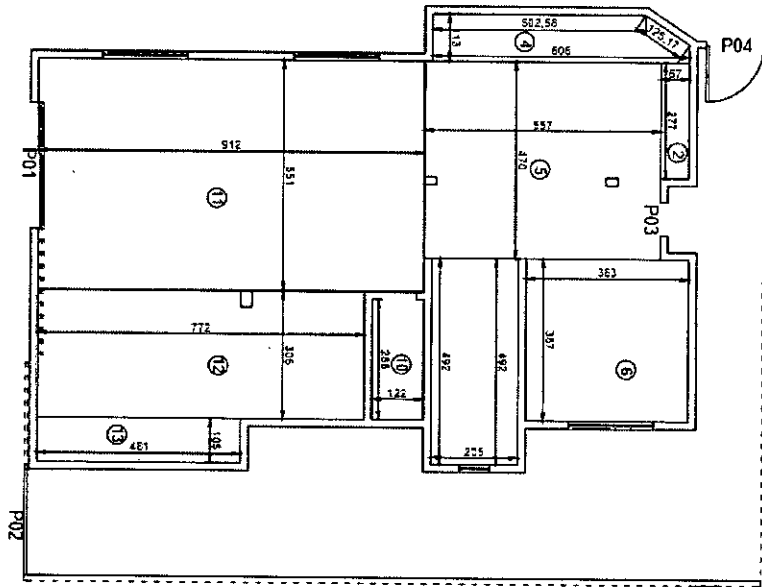

PROJETO HEXAGONO ENGENHARIA E CONSULTORIA LTDA			
TITULO REFORMA DE CASAS - BARBA LONGA			
UNIDADE CASA Nº38			
Nº DO PROJETO	Nº DO RP	Nº DO ITEM	REVISAO
CR0001 01	08/03/2016		REV

3.2.34. CE 38

FUNDAÇÃO RENOVA	Nº	REV 0	PÁGINA 63
-----------------	----	-------	-----------



MEMPHIS
COMMERCIAL

3.2.35. CE 151

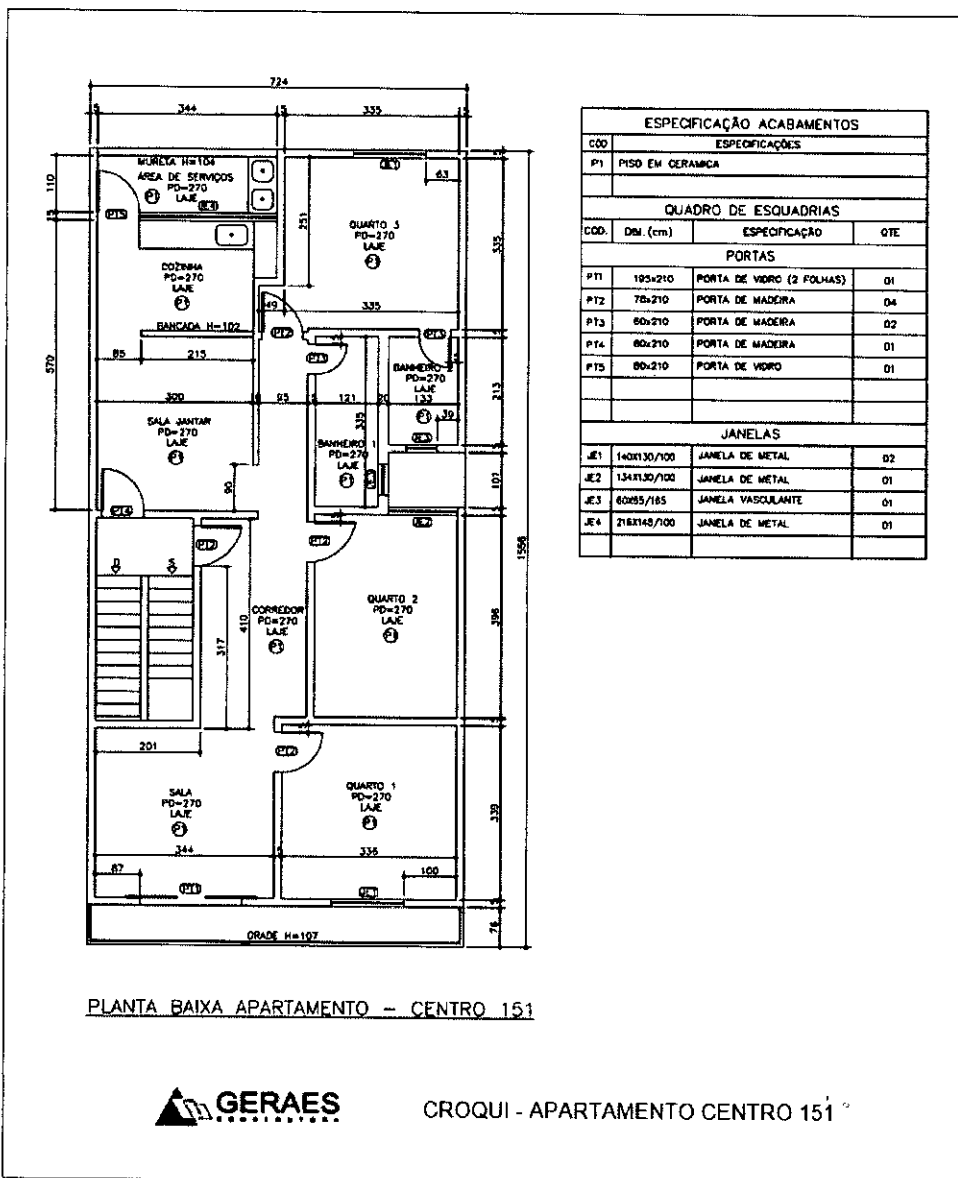
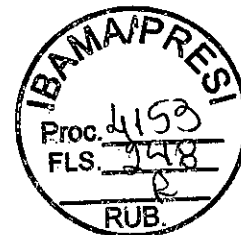

EM BRANCO

EMBRANCO

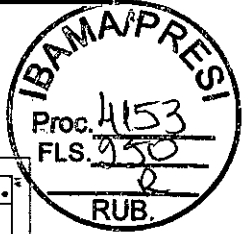

3.3.2. MV 365B

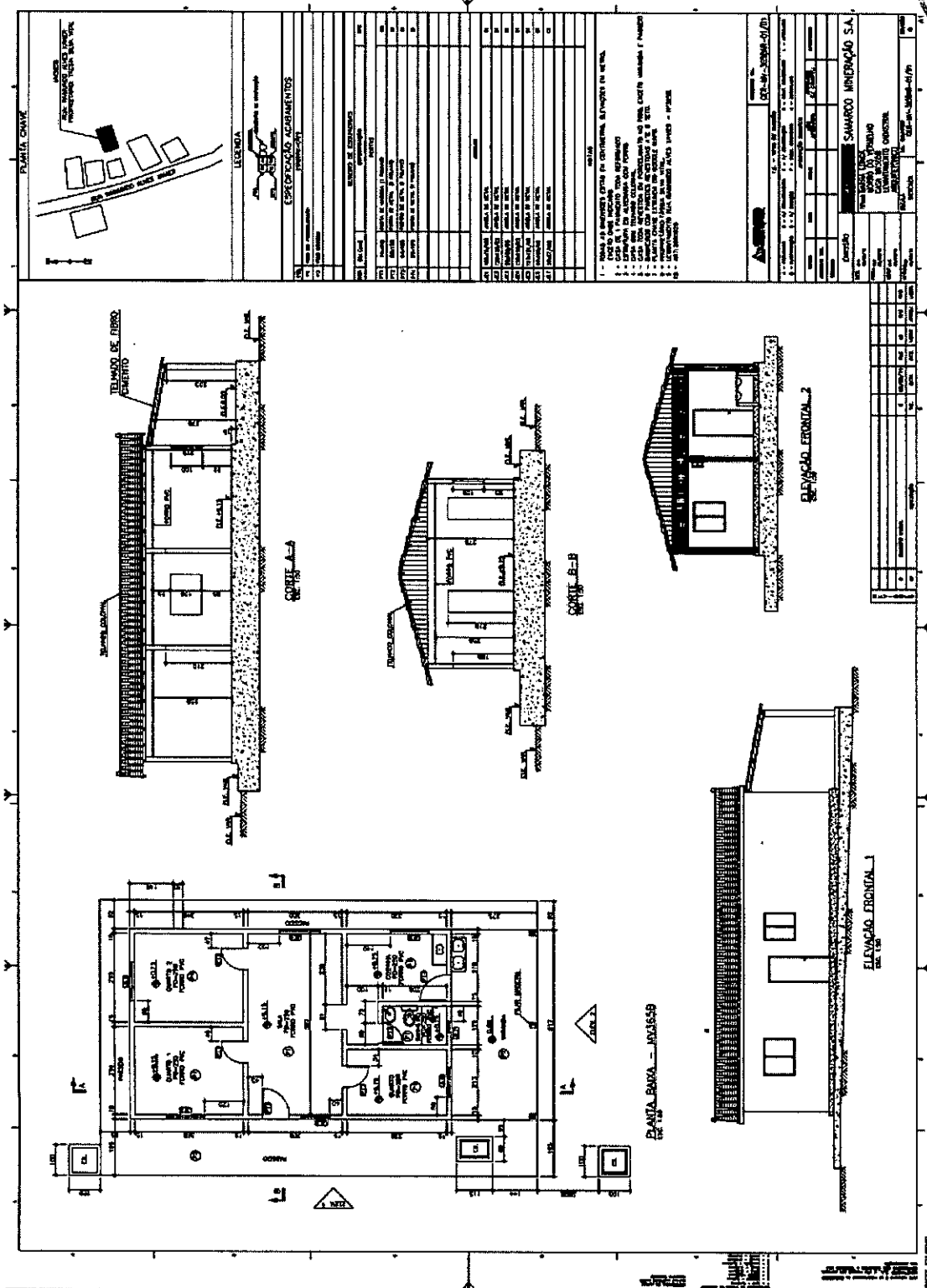

EM BRANCO

MEMBRANCO

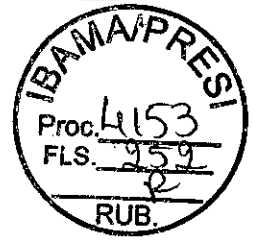

3.3.4. MV 451

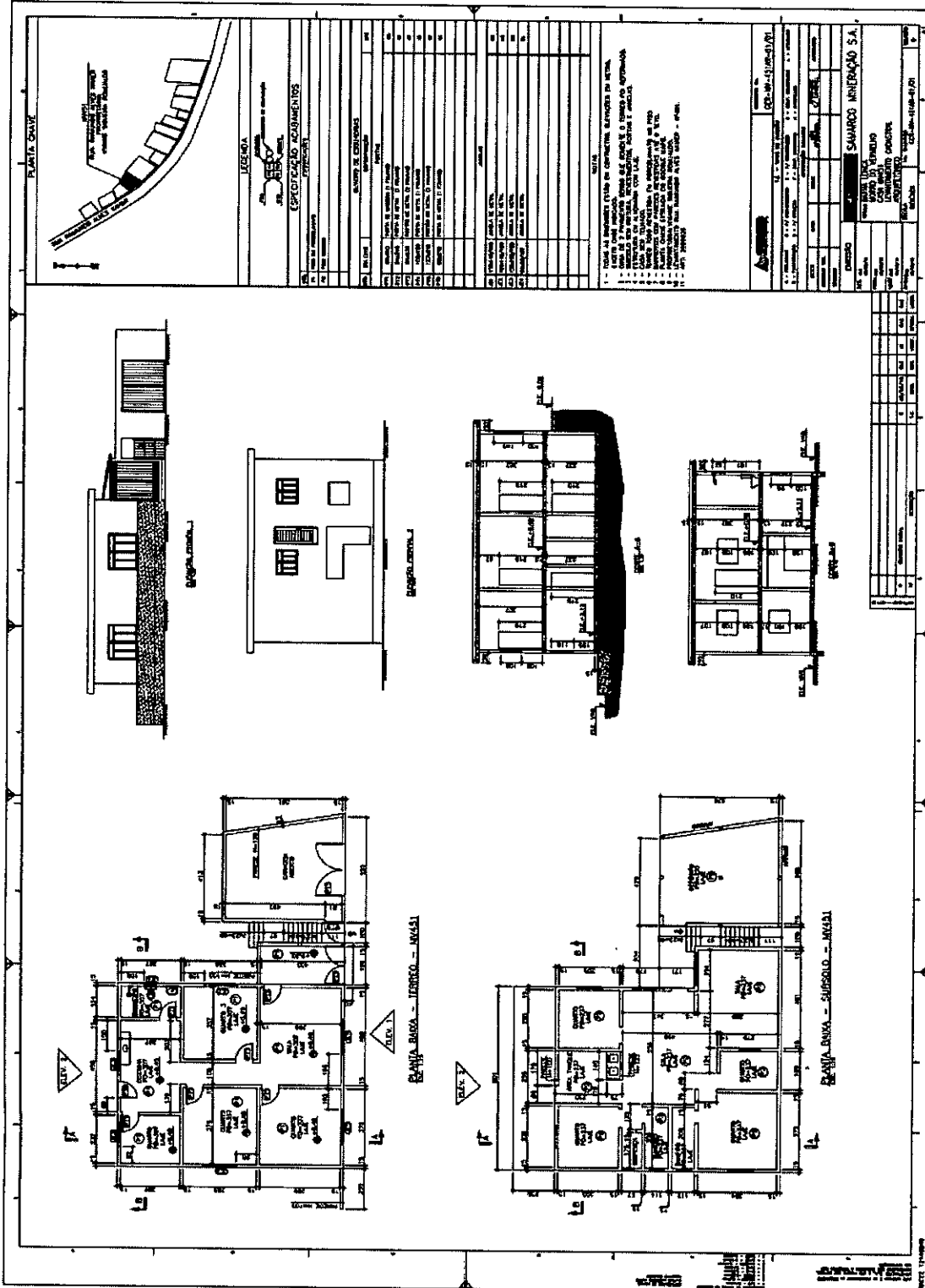

EMBRANCO

3.3.5. MV 539

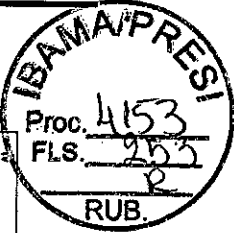

PLANTA GERAL

ESPECIFICAÇÃO ACABAMENTOS		ESPECIFICAÇÃO MATERIAIS		ESPECIFICAÇÃO DE EQUIPAMENTOS		ESPECIFICAÇÃO DE MOBILIÁRIO	
QTD	DESCRIÇÃO	QTD	DESCRIÇÃO	QTD	DESCRIÇÃO	QTD	DESCRIÇÃO
01	1000	01	1000	01	1000	01	1000
02	1000	02	1000	02	1000	02	1000
03	1000	03	1000	03	1000	03	1000
04	1000	04	1000	04	1000	04	1000
05	1000	05	1000	05	1000	05	1000
06	1000	06	1000	06	1000	06	1000
07	1000	07	1000	07	1000	07	1000
08	1000	08	1000	08	1000	08	1000
09	1000	09	1000	09	1000	09	1000
10	1000	10	1000	10	1000	10	1000
11	1000	11	1000	11	1000	11	1000
12	1000	12	1000	12	1000	12	1000
13	1000	13	1000	13	1000	13	1000
14	1000	14	1000	14	1000	14	1000
15	1000	15	1000	15	1000	15	1000
16	1000	16	1000	16	1000	16	1000
17	1000	17	1000	17	1000	17	1000
18	1000	18	1000	18	1000	18	1000
19	1000	19	1000	19	1000	19	1000
20	1000	20	1000	20	1000	20	1000
21	1000	21	1000	21	1000	21	1000
22	1000	22	1000	22	1000	22	1000
23	1000	23	1000	23	1000	23	1000
24	1000	24	1000	24	1000	24	1000
25	1000	25	1000	25	1000	25	1000
26	1000	26	1000	26	1000	26	1000
27	1000	27	1000	27	1000	27	1000
28	1000	28	1000	28	1000	28	1000
29	1000	29	1000	29	1000	29	1000
30	1000	30	1000	30	1000	30	1000
31	1000	31	1000	31	1000	31	1000
32	1000	32	1000	32	1000	32	1000
33	1000	33	1000	33	1000	33	1000
34	1000	34	1000	34	1000	34	1000
35	1000	35	1000	35	1000	35	1000
36	1000	36	1000	36	1000	36	1000
37	1000	37	1000	37	1000	37	1000
38	1000	38	1000	38	1000	38	1000
39	1000	39	1000	39	1000	39	1000
40	1000	40	1000	40	1000	40	1000
41	1000	41	1000	41	1000	41	1000
42	1000	42	1000	42	1000	42	1000
43	1000	43	1000	43	1000	43	1000
44	1000	44	1000	44	1000	44	1000
45	1000	45	1000	45	1000	45	1000
46	1000	46	1000	46	1000	46	1000
47	1000	47	1000	47	1000	47	1000
48	1000	48	1000	48	1000	48	1000
49	1000	49	1000	49	1000	49	1000
50	1000	50	1000	50	1000	50	1000

PLANTA BAIXA - 1º ANDAR - MV539

LEV. A-1

PLANTA BAIXA - 3º ANDAR - MV539

LEV. A-3

EM BRANCO

EM BRANCO

3.3.7. MV 369

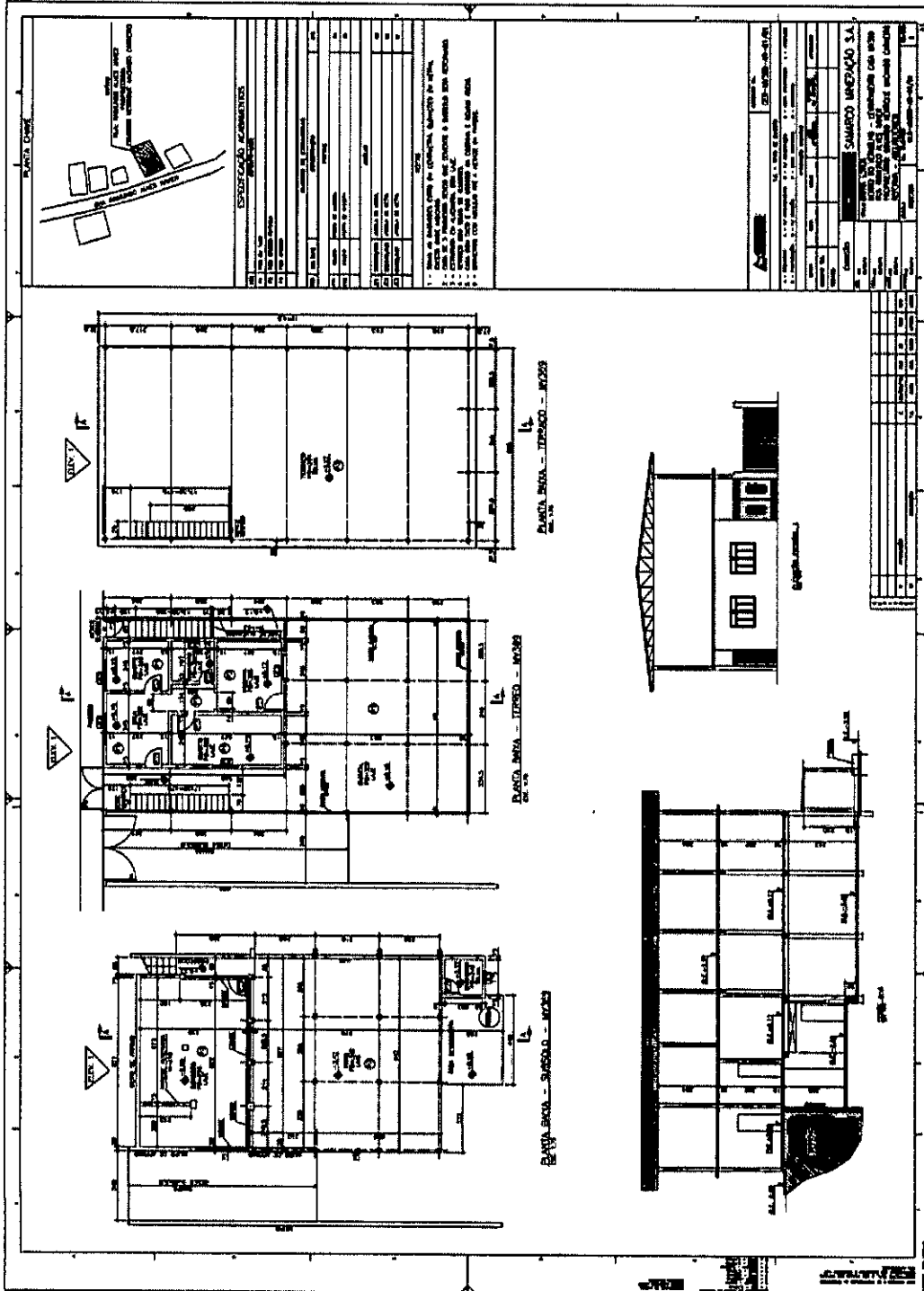
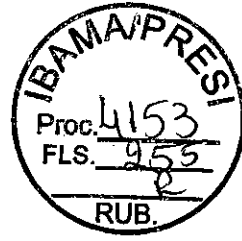

EM BRANCO

EM BRANCO

EM BRANCO

EM BRANCO

3.3.11. MV 527

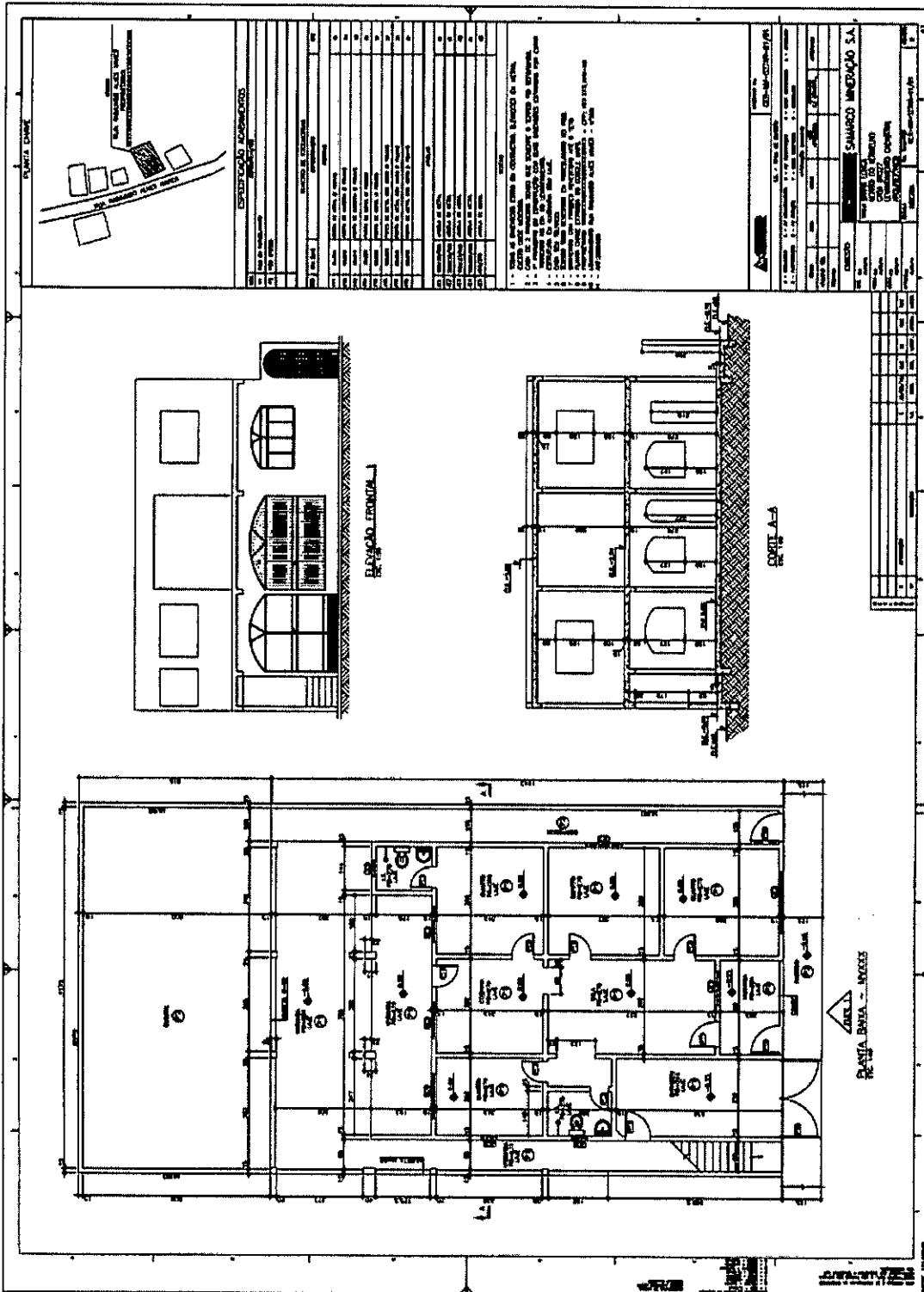
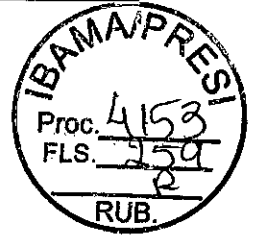

EM BRANCO

3.3.12. MV 545

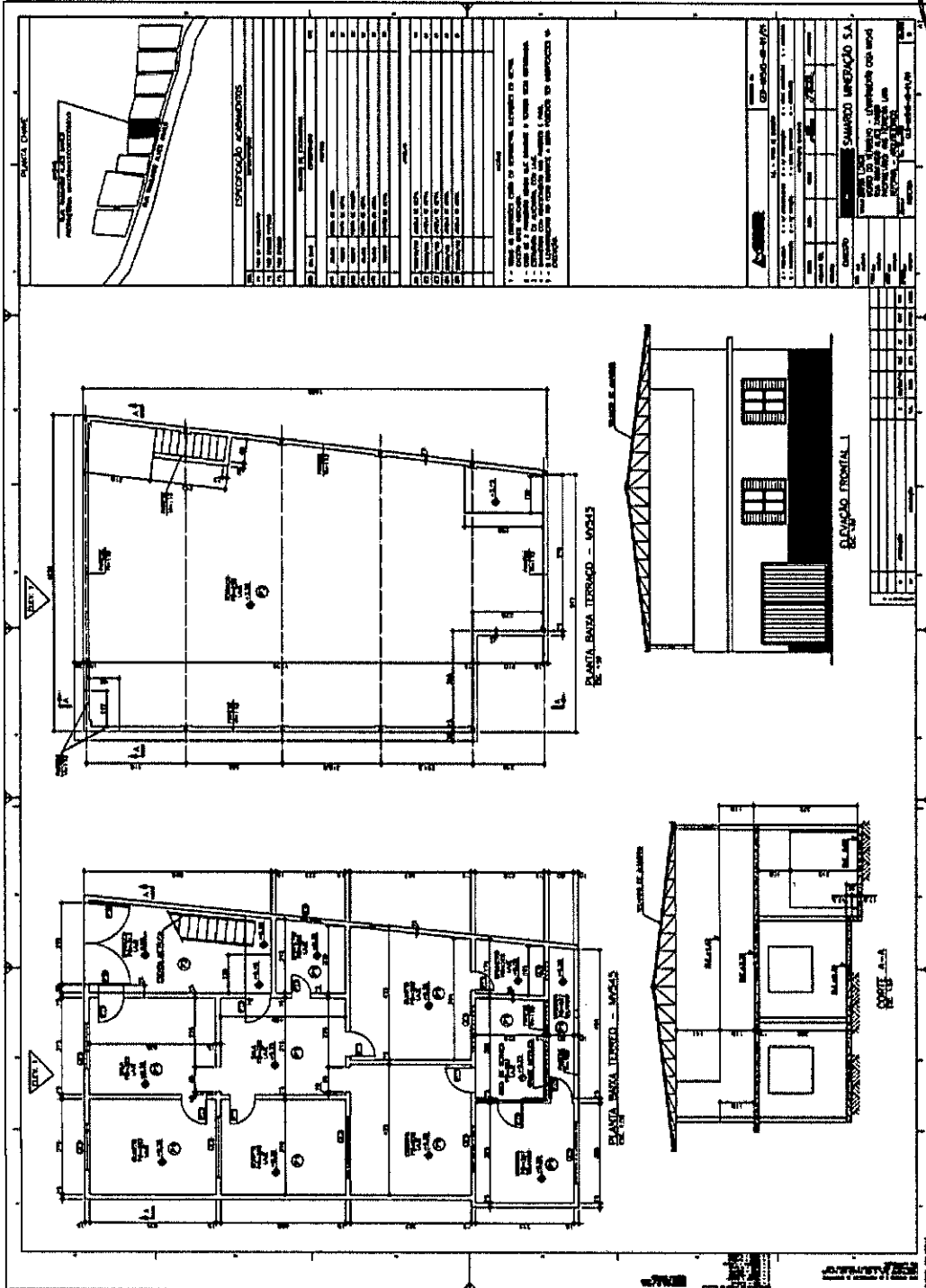
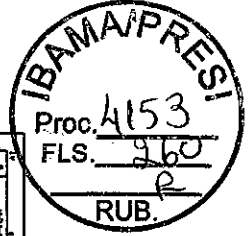

EM BRANCO

3.3.13. MV 551

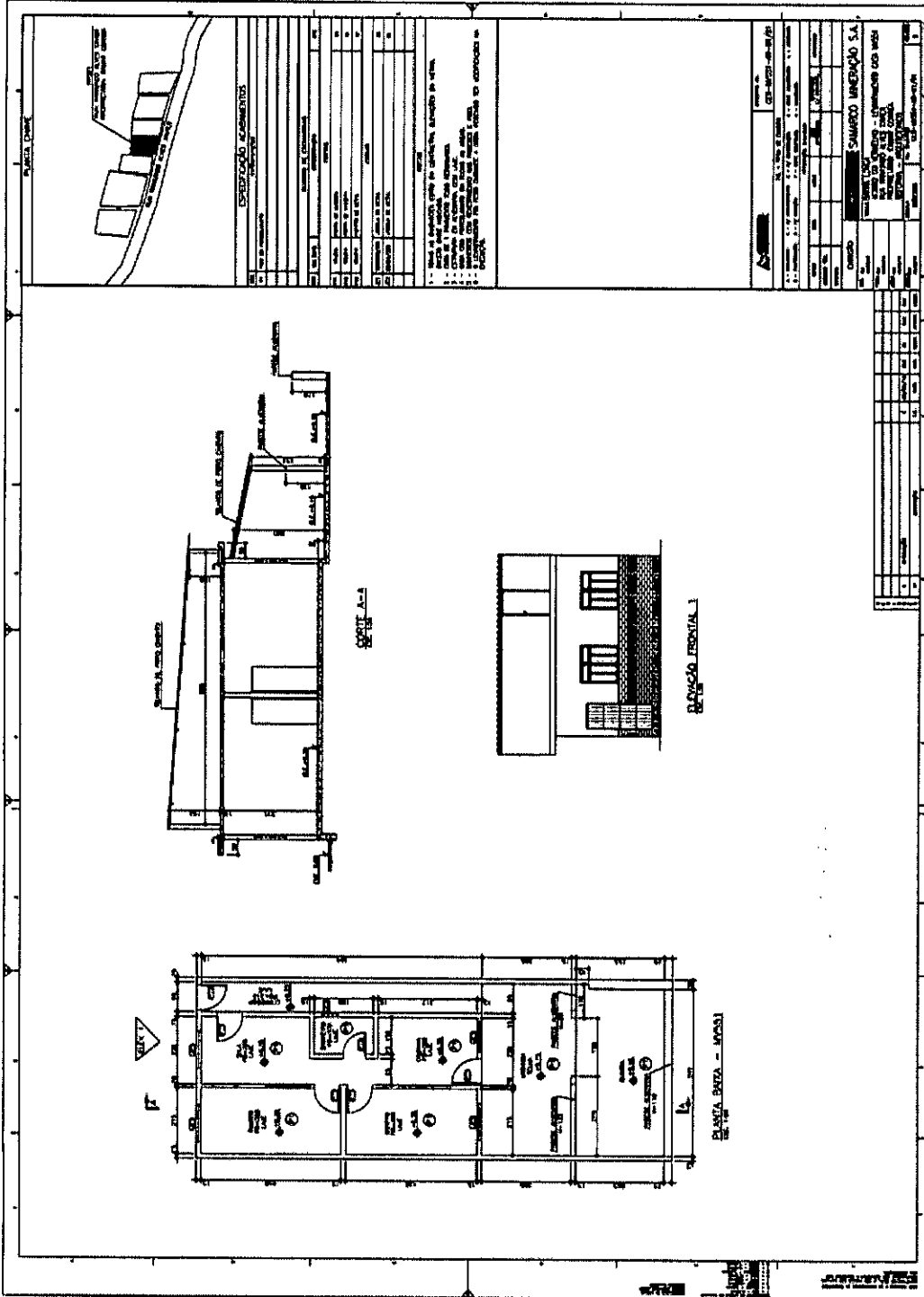
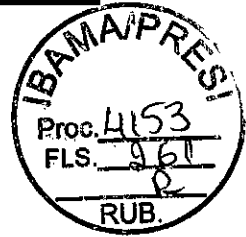

EMBRANCO

3.3.14. MV 617

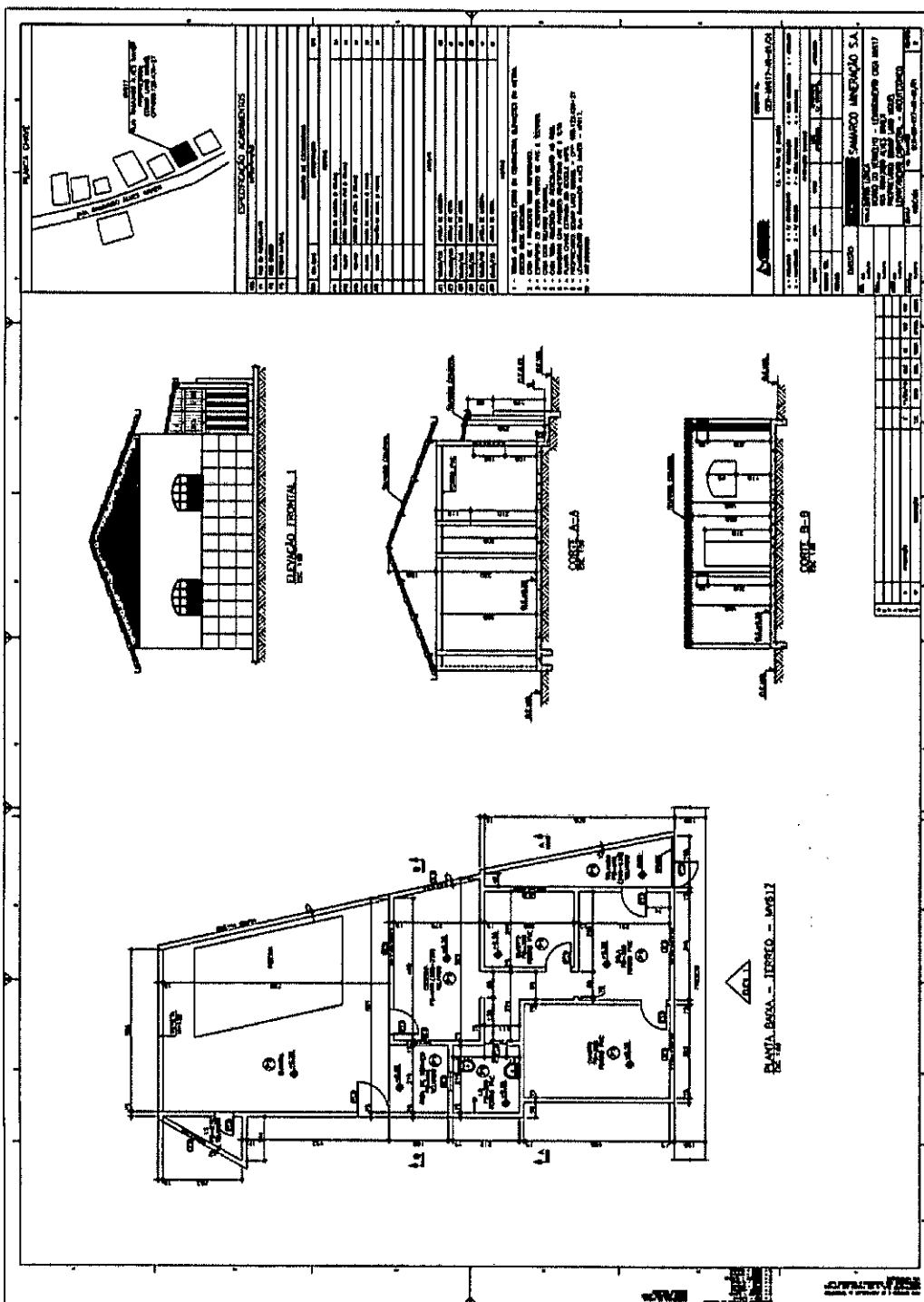
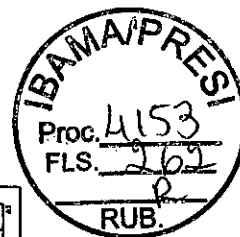

EM BRANCO

3.3.15. MV 603

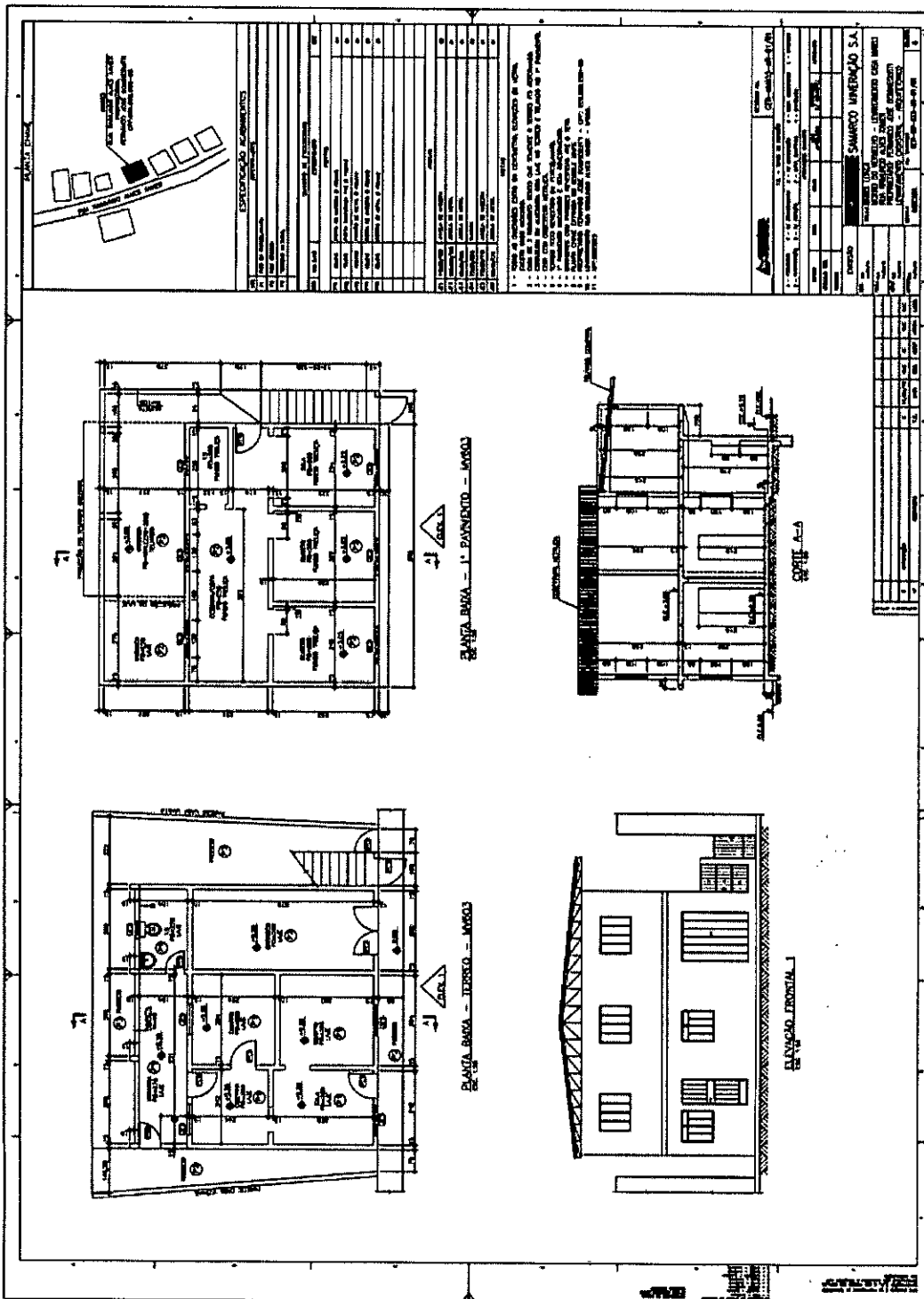
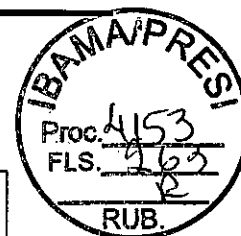

EM BRANCO

3.3.16. MV 623

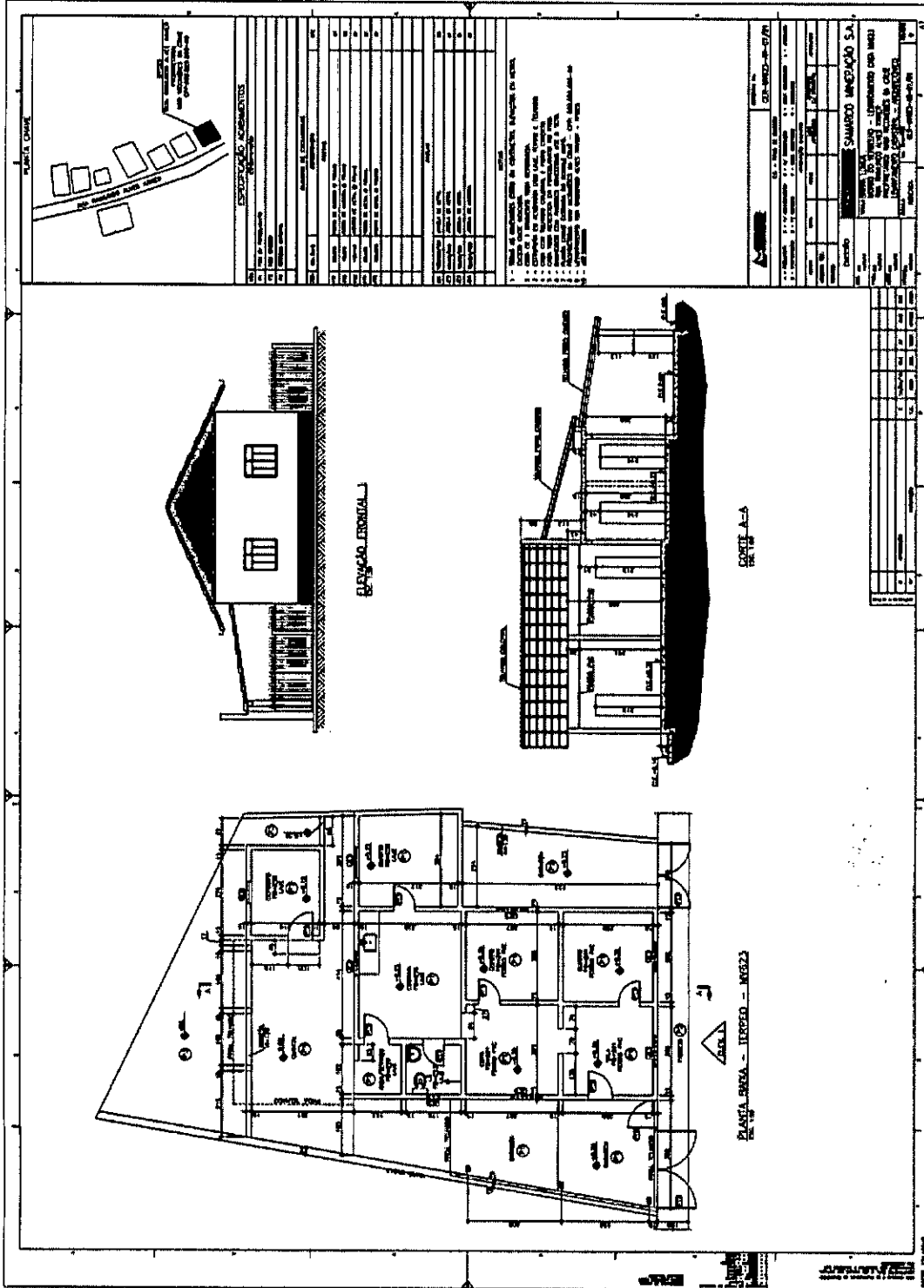
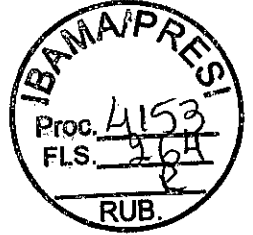

EM BRANCO

3.3.17. MV 613

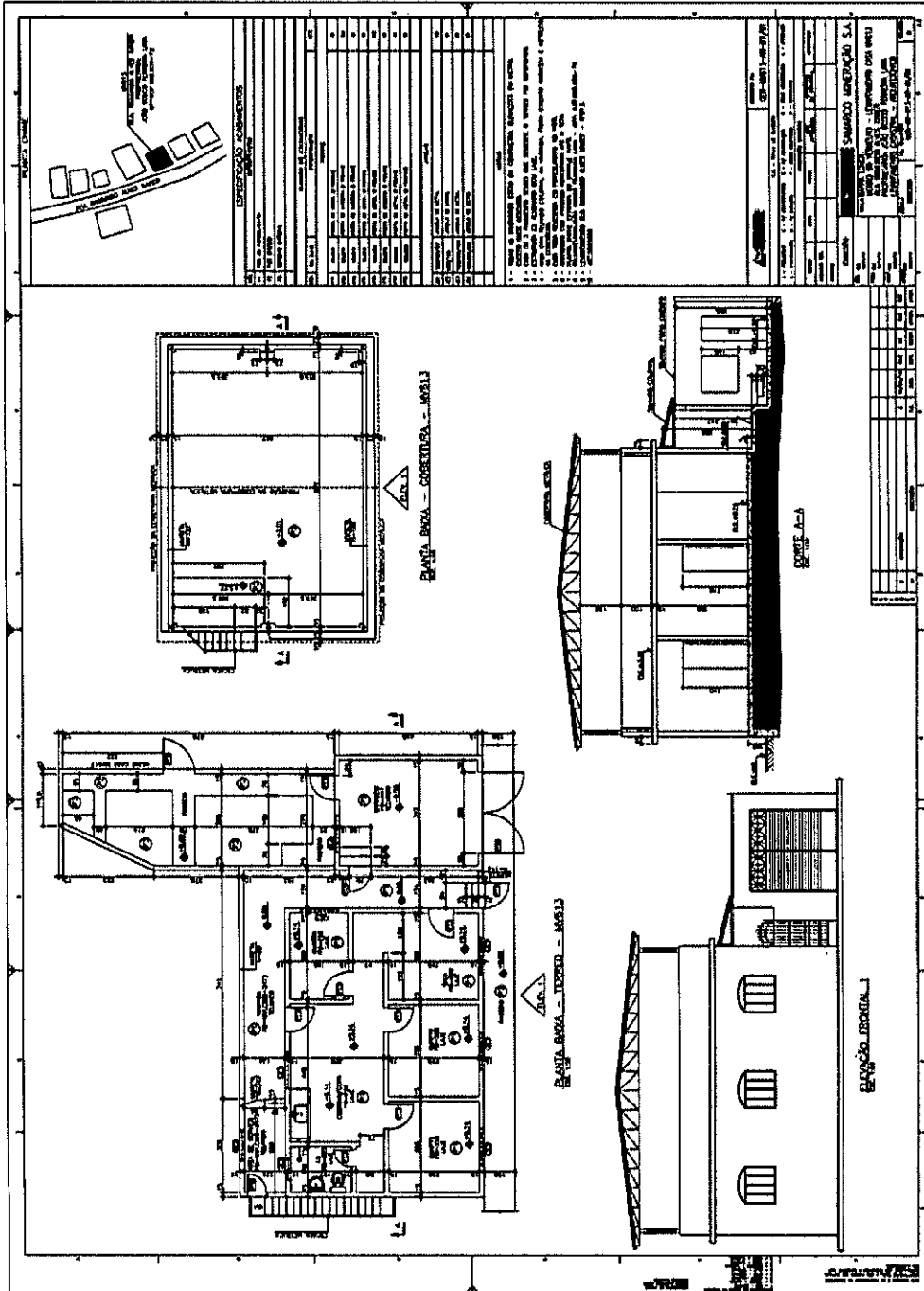
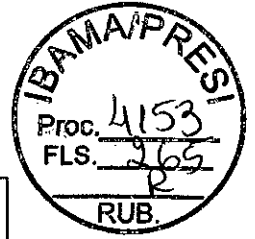

EM BRANCO

EM BRANCO



FUNDAÇÃO
renova
FUNDACION RENOVACION S.A. SUCRE

FUNDAÇÃO RENOVA

Nº

REV
0

PÁGINA
83

3.3.19.

MV 593

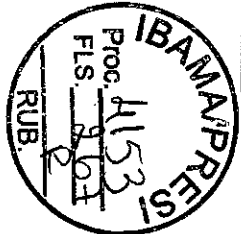
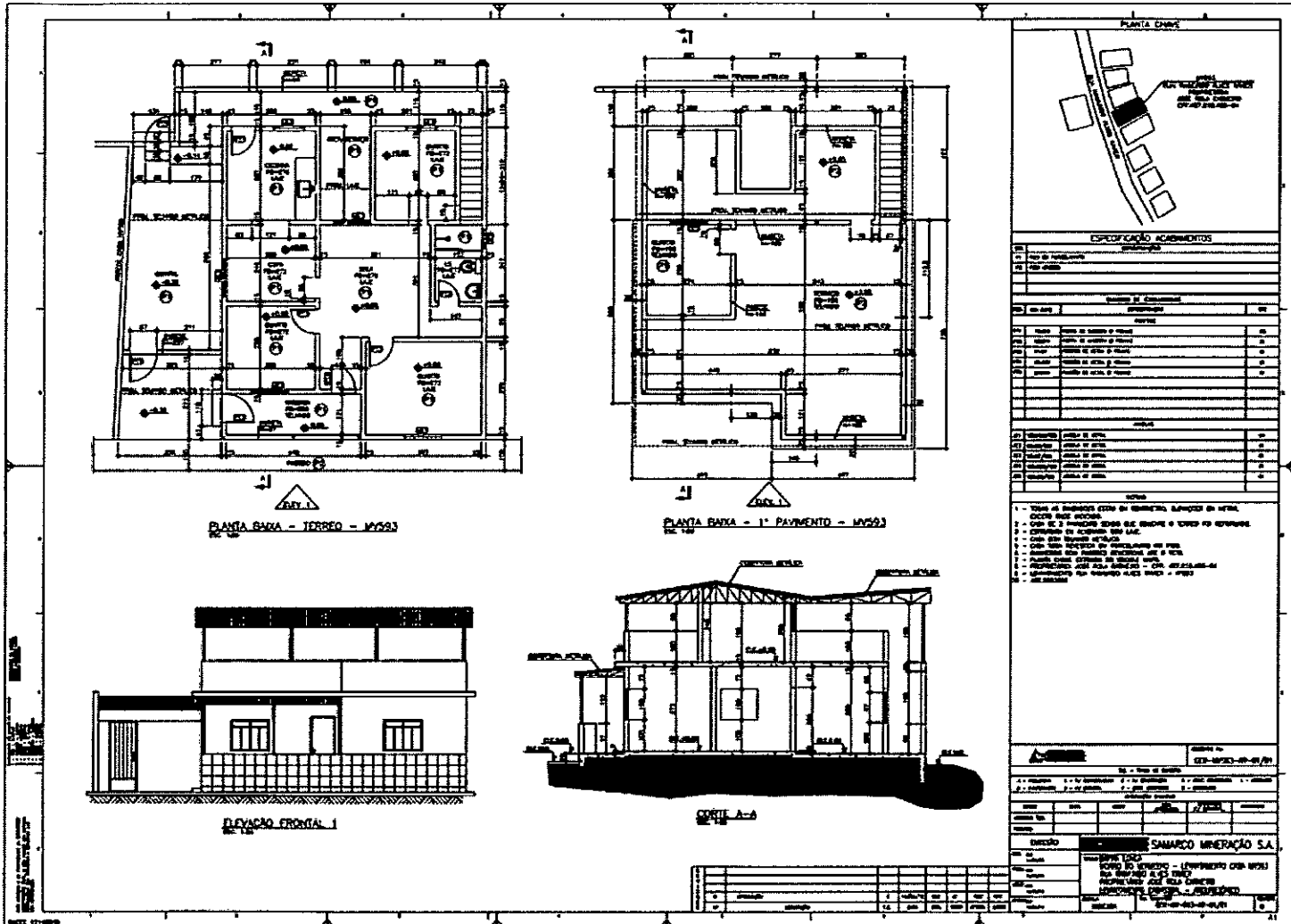

EM BRANCO

3.3.20. MV 583

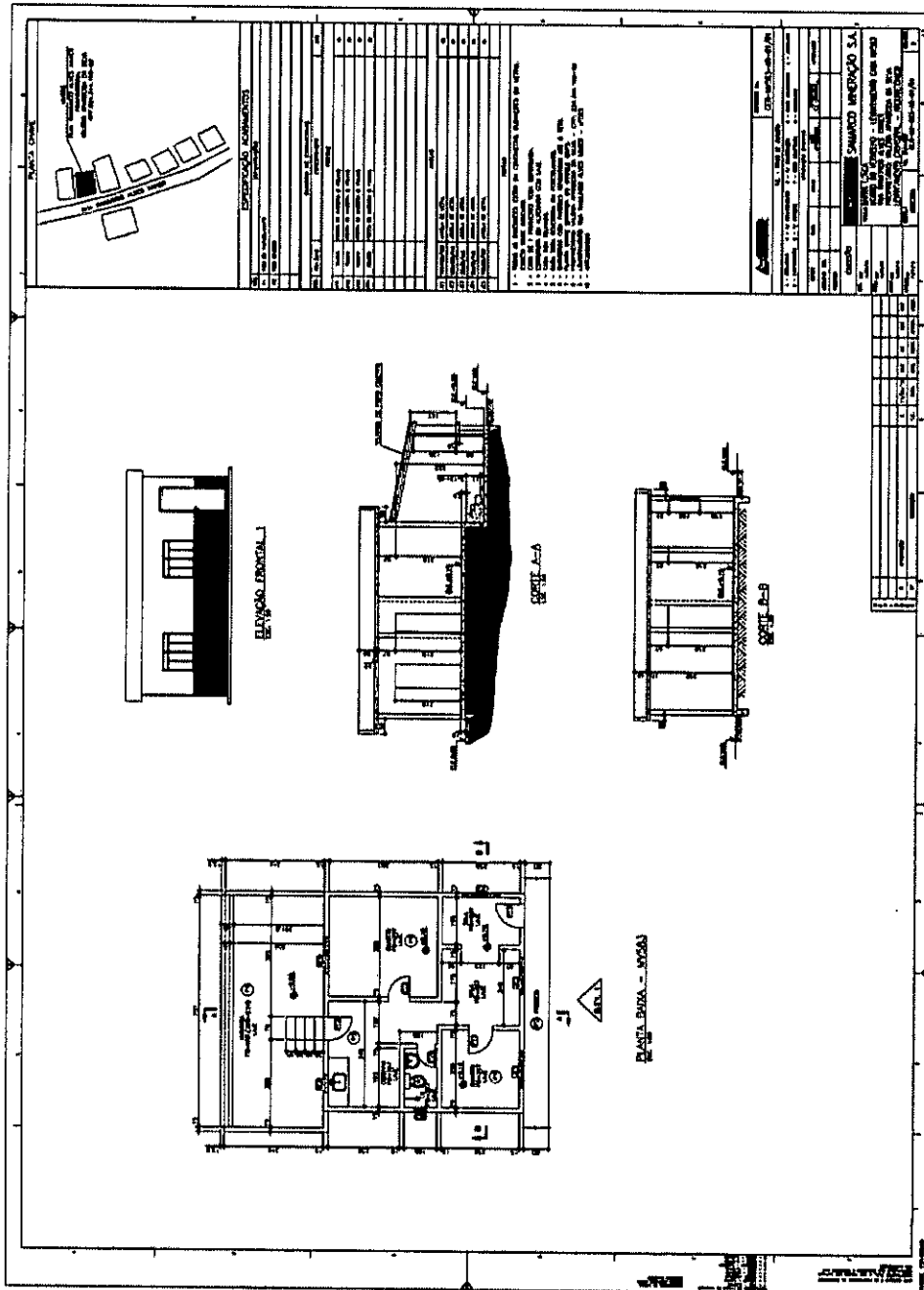
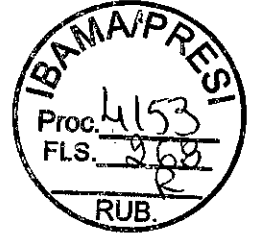

EM BRANCO



FUNDAÇÃO
RENOVA
Operadora Nacional de Investimentos

FUNDAÇÃO RENOVA

Nº

REV
0

PÁGINA
85

3.3.21.

MV 365

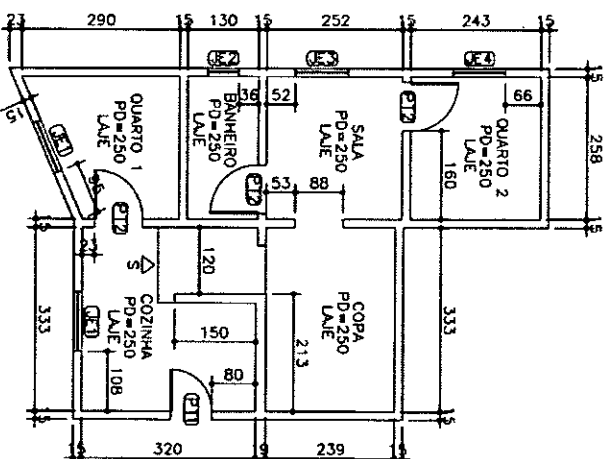
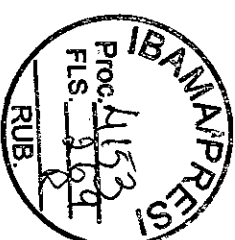

OBS.

- AZULEJO ASSENTADO NA SALA H=145
- AZULEJO ASSENTADO NA PAREDE DA JANELA DO QUARTO 2 ATE O TETO.

COD.	Dim. (cm)	ESPECIFICAÇÃO	QTE
PORTAS			
P11	76x210	PORTA DE METAL	01
P12	88x210	PORTA DE MADEIRA	03
JANELAS			
JE1	98x98/115	JANELA DE METAL	02
JE2	58x58/100	JANELA DE METAL	01
JE3	98x98/100	JANELA DE METAL	01
JE4	98x98/88	JANELA DE METAL	01



CHOCUI DE IDENTIFICAÇÃO

MV365

MEDICAO_08

RP-0108/10

EM BRANCO

3.3.22. MV 513 ESCOLA

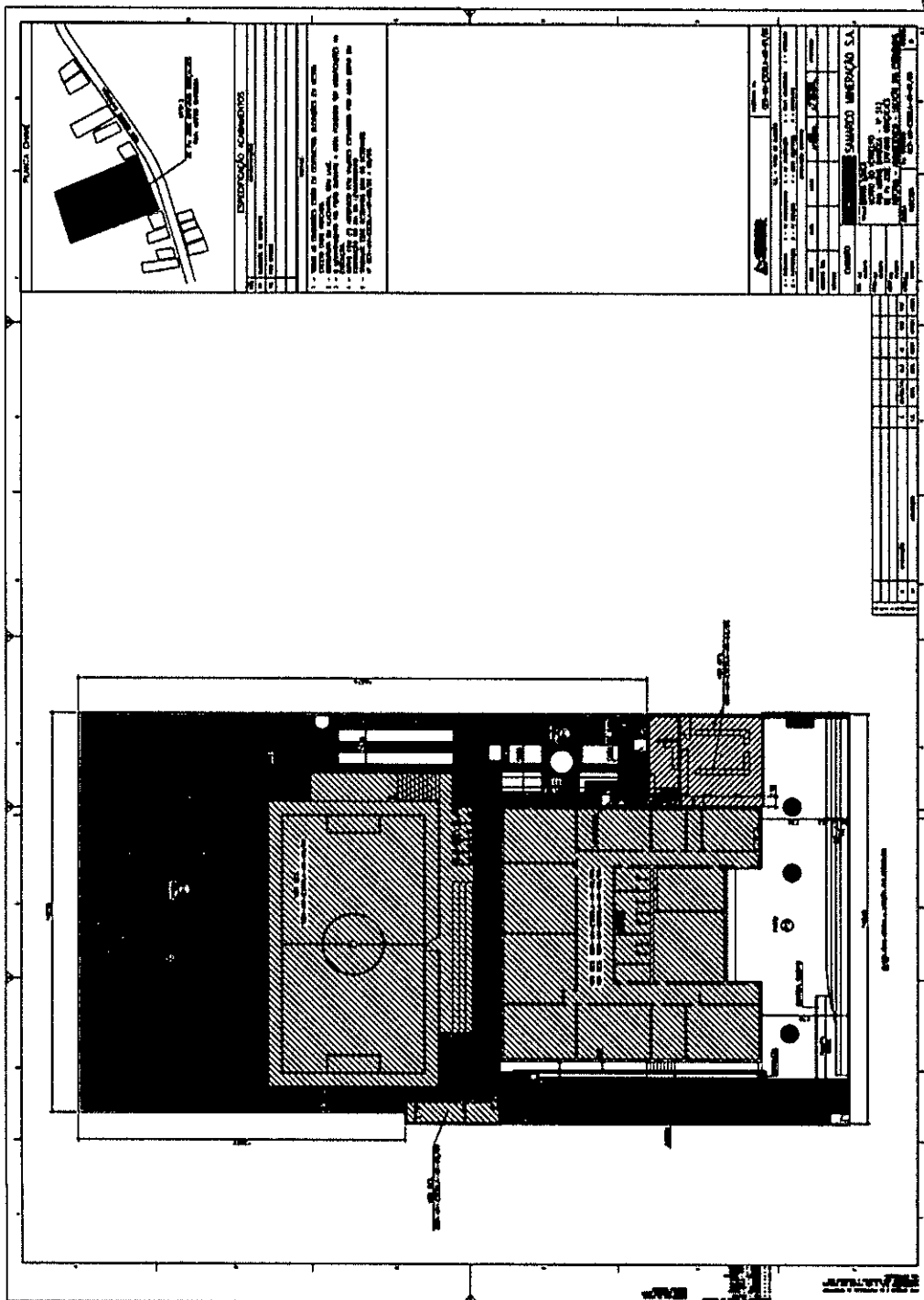
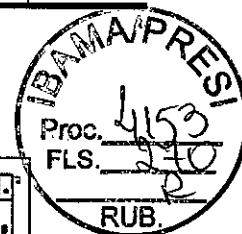

EM BRANCO

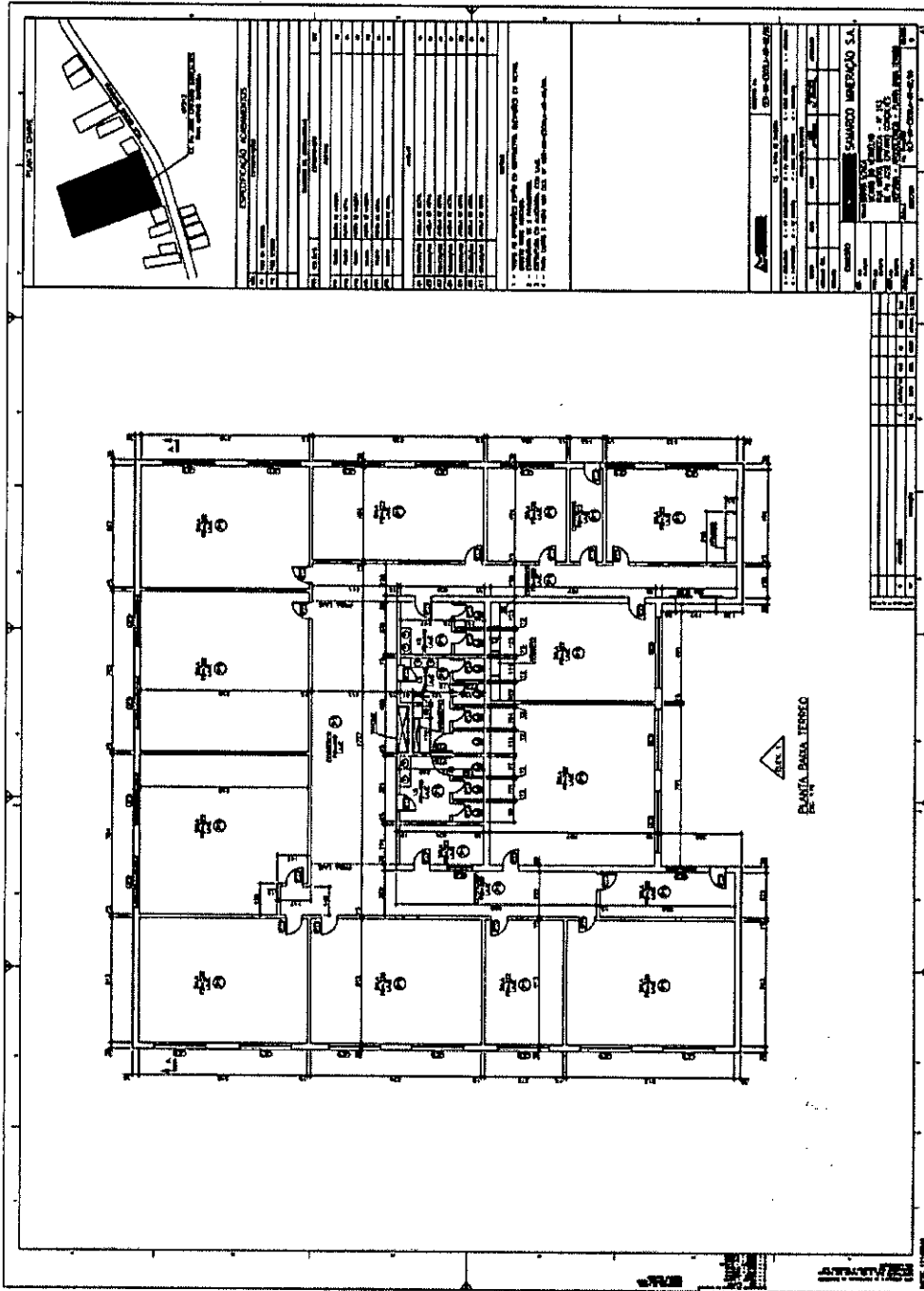
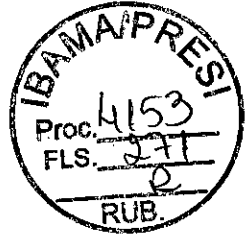

EM BRANCO

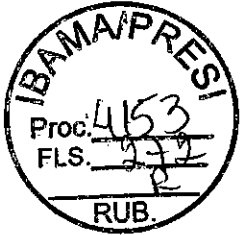
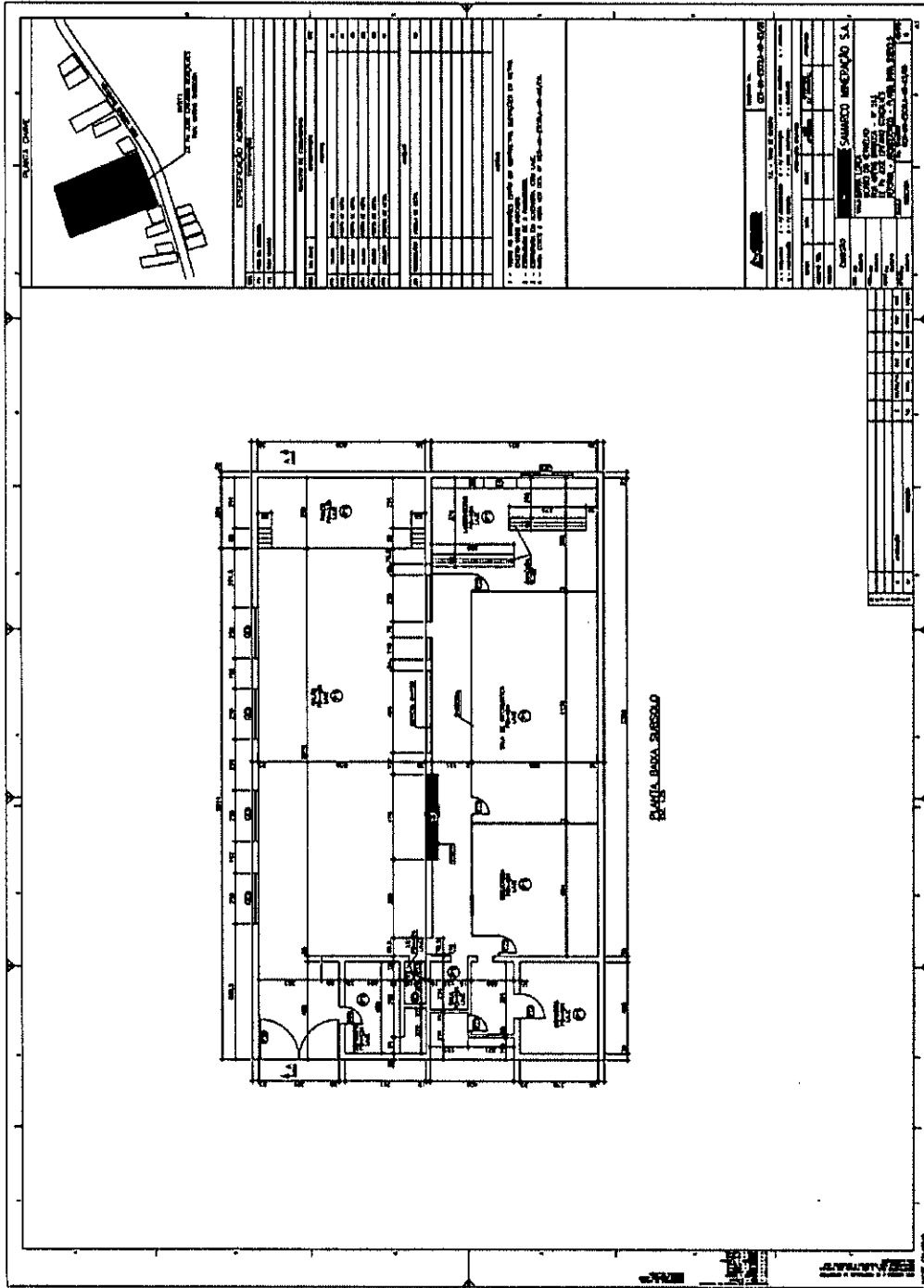

EM BRANCO

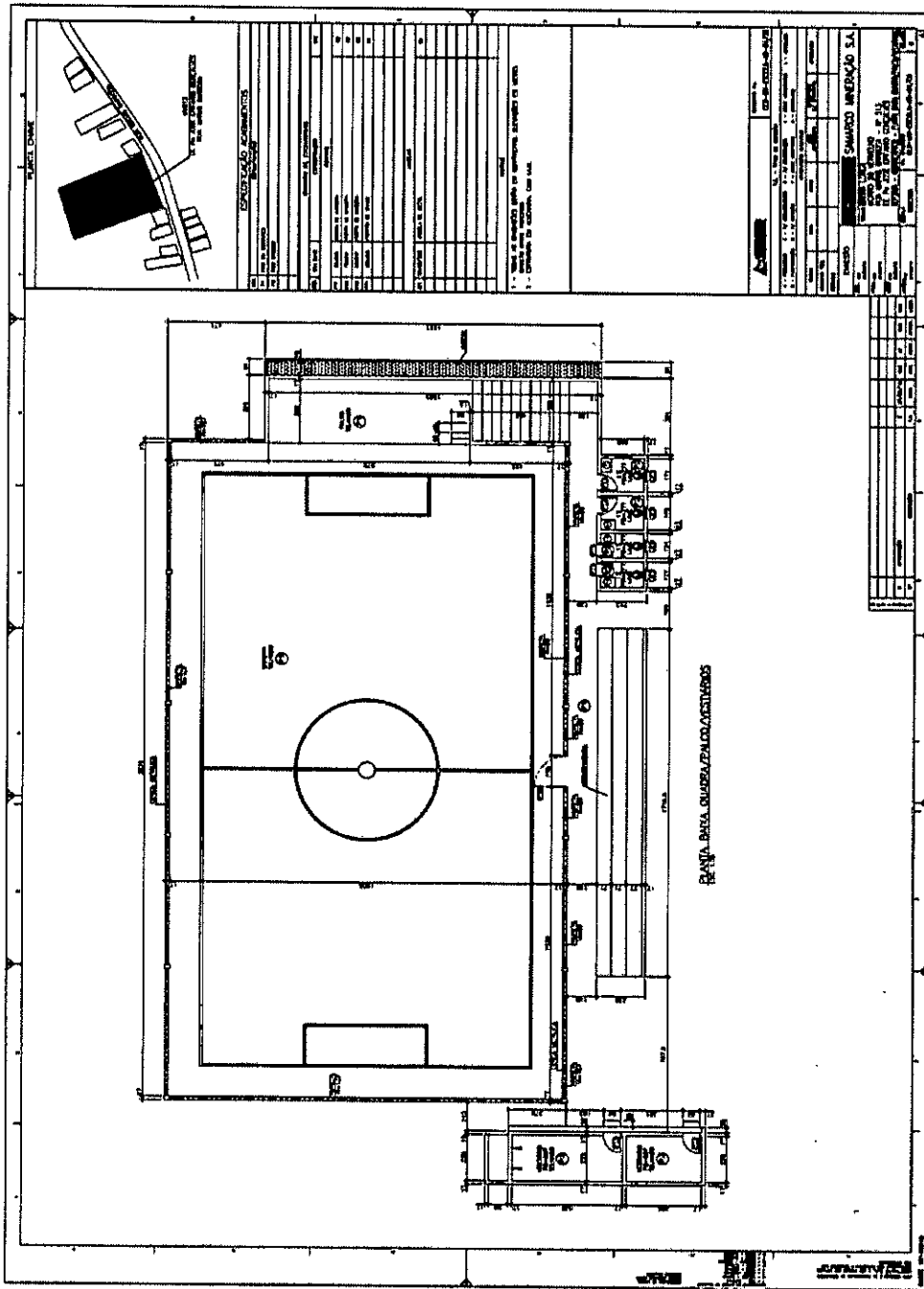
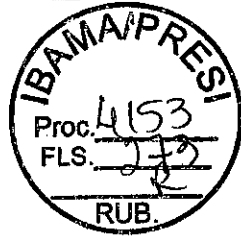

EM BRANCO

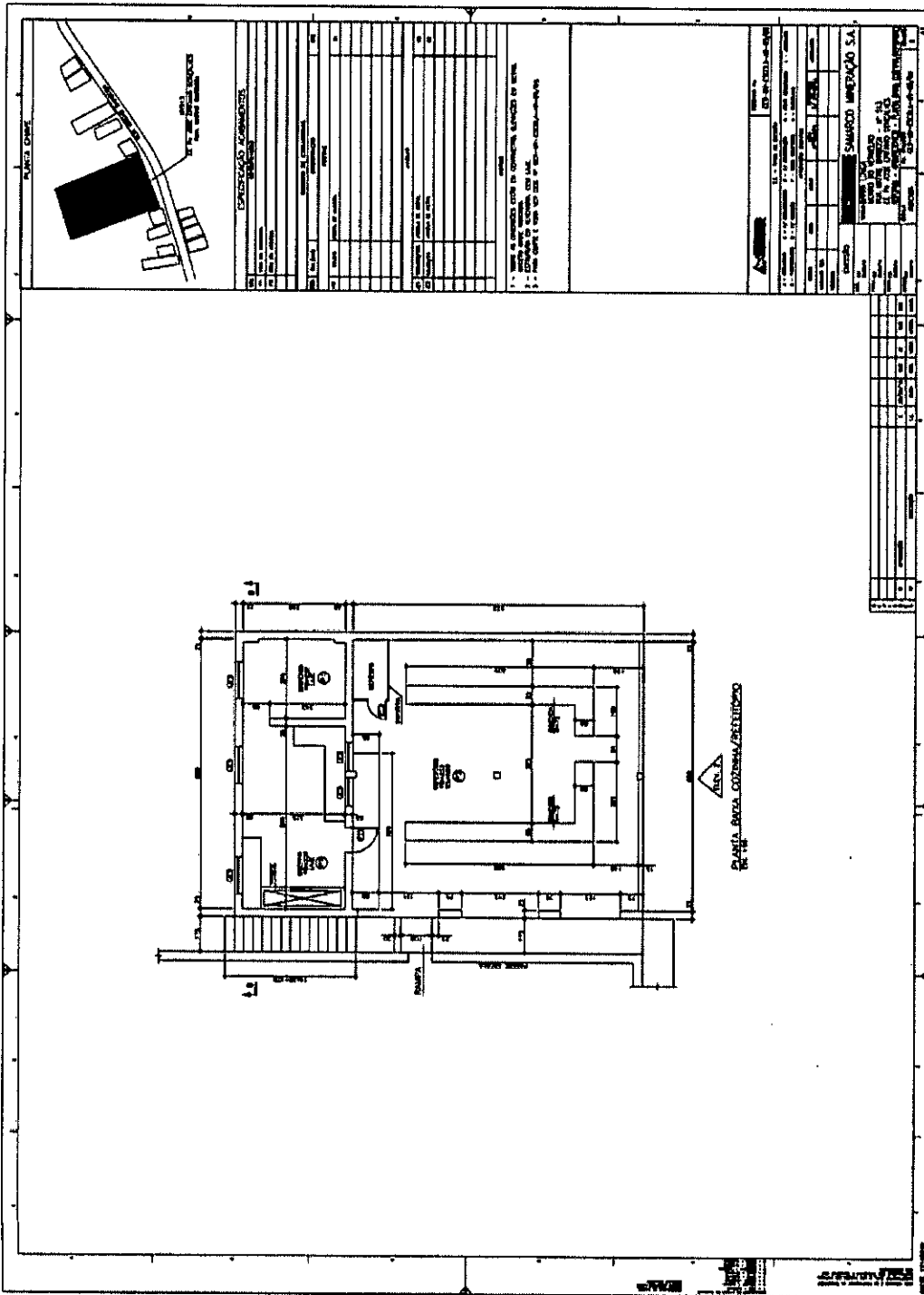
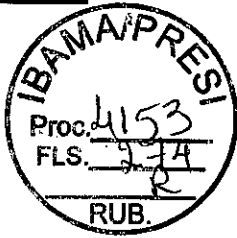

EM BRANCO

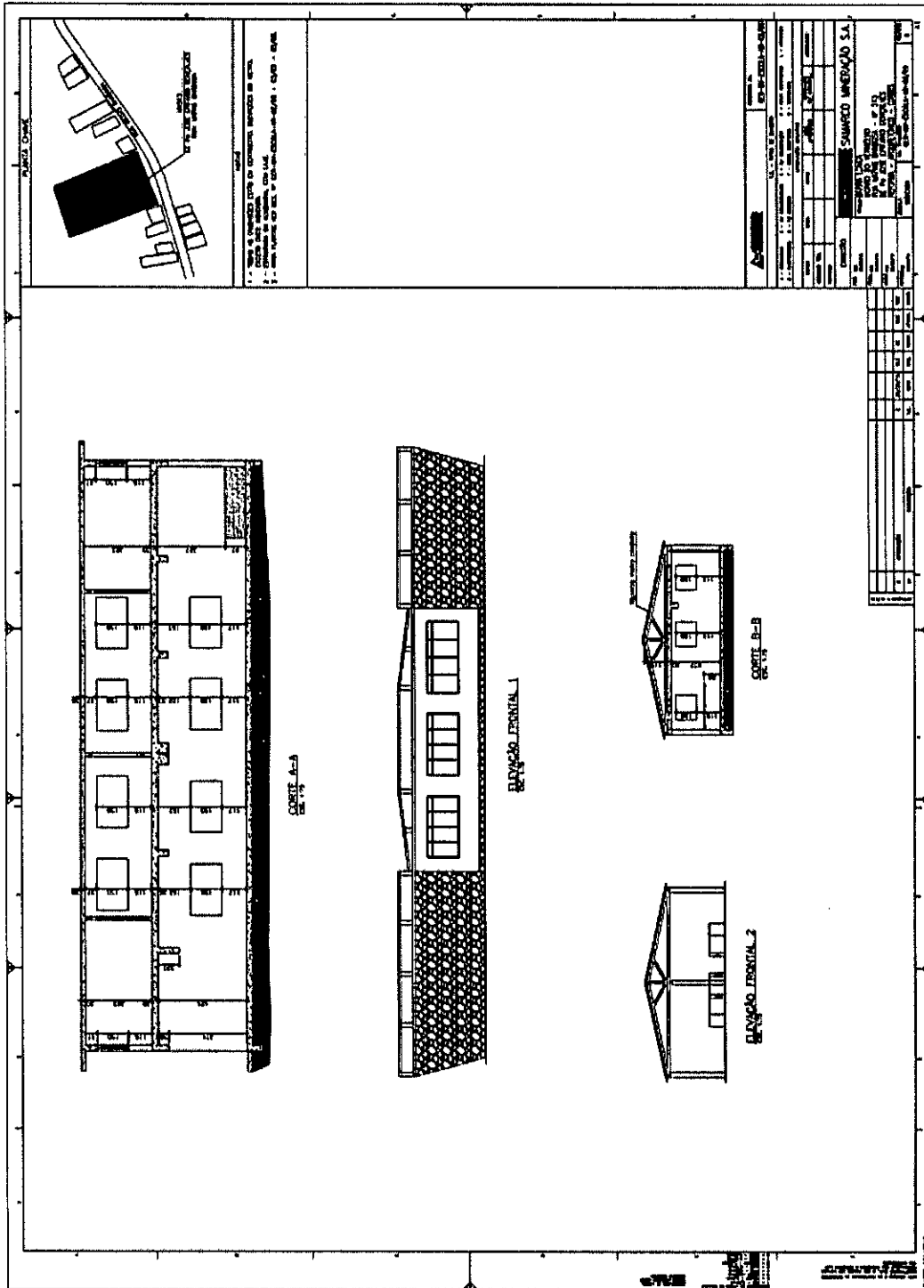
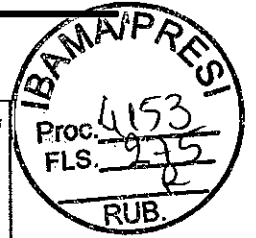

EM BRANCO

3.3.23. MV 580

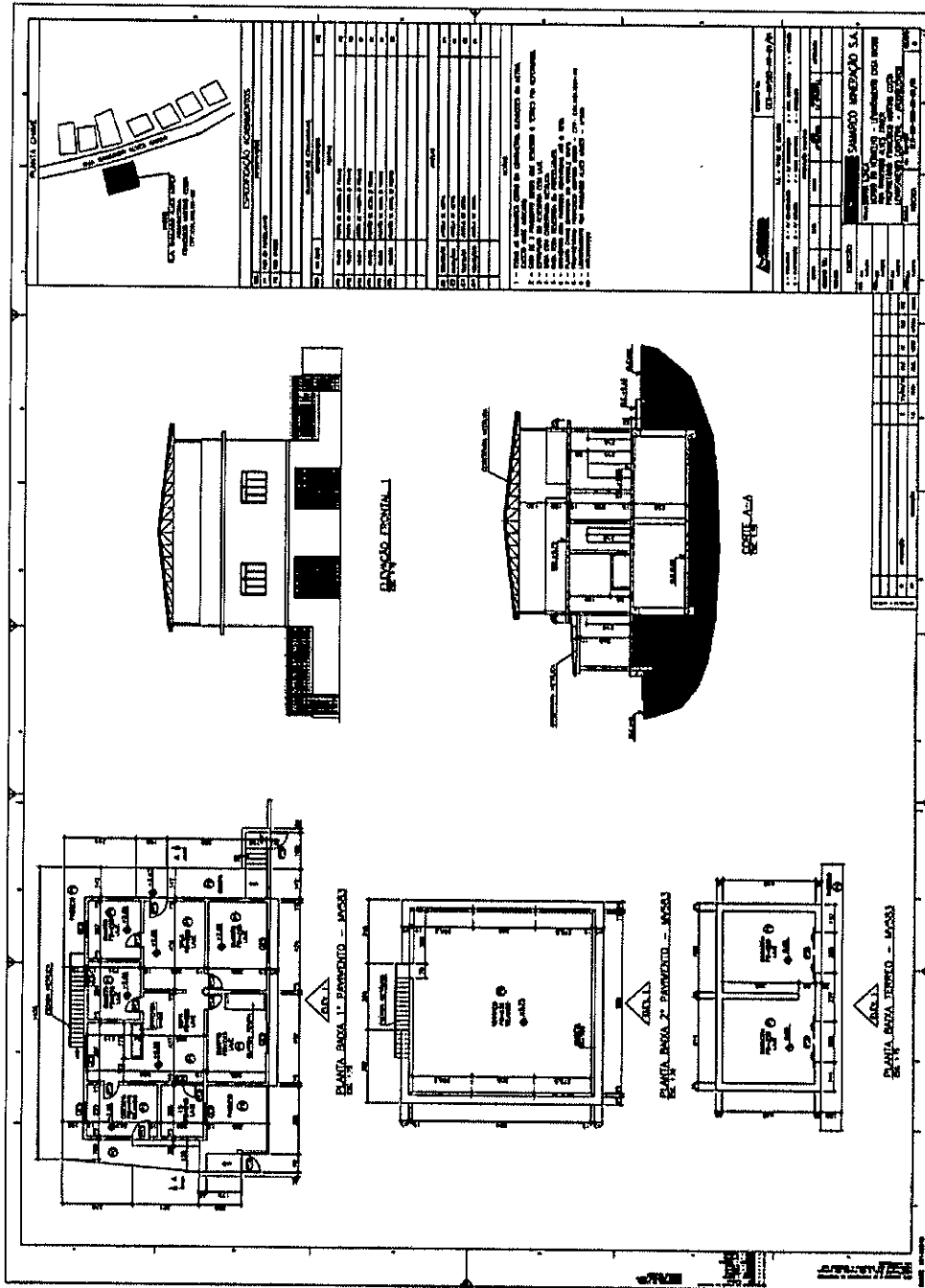
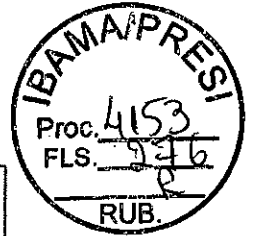

EM BRANCO



3.4. GESTEIRA

3.4.1. GE ALEMÃO

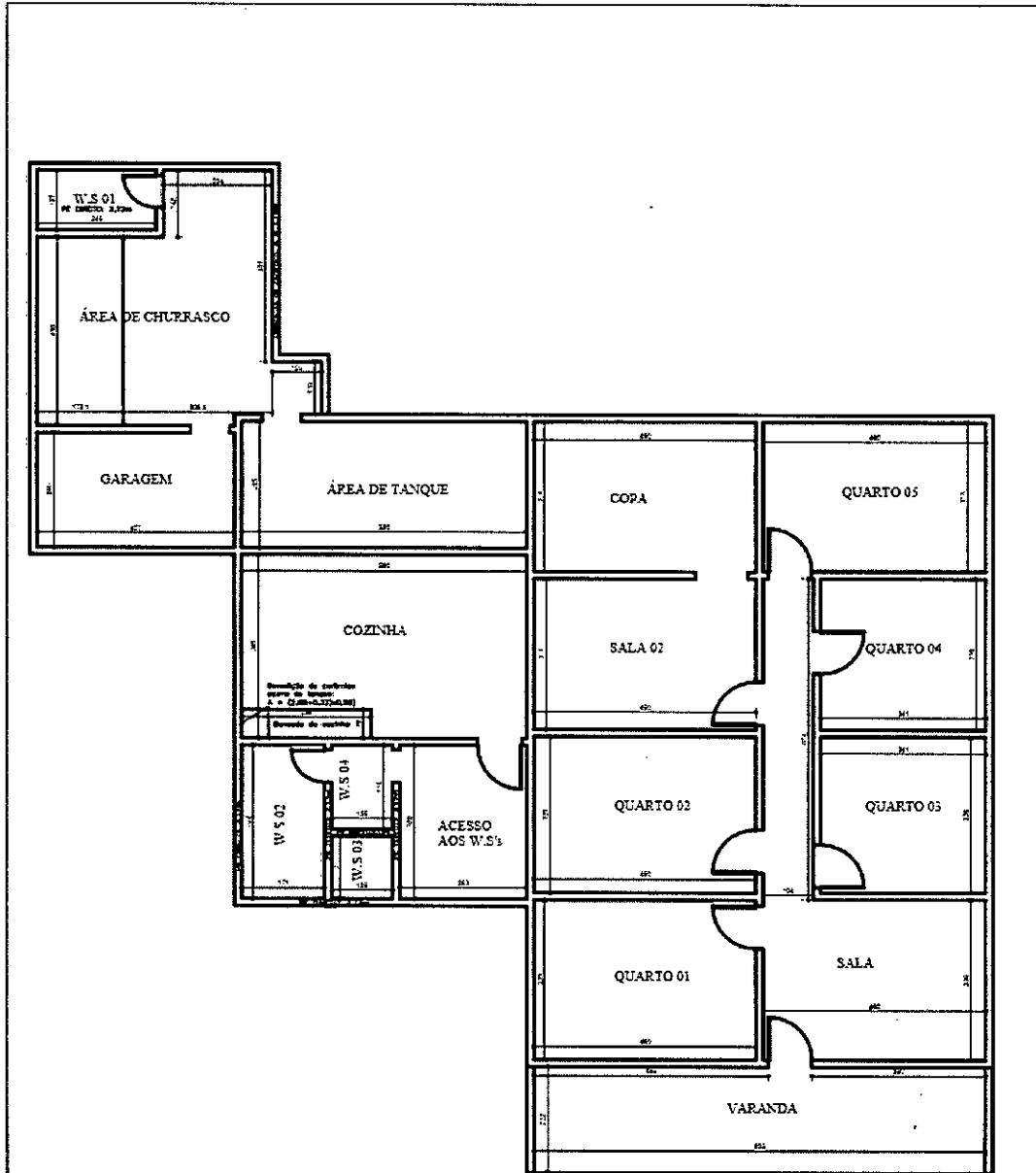
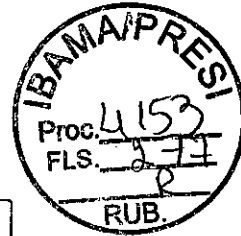

PROJETO HEXÁGONO ENGENHARIA E CONSULTORIA LTDA			
TÍTULO REFORMA DE CASAS - BARRA LONGA			
UNIDADE Casa do Alemão			
Nº DO CROQUI CROQUI 01	Nº DO RP	Nº DO ITEM	REVISÃO REV

EM BRANCO

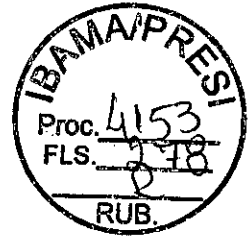

3.4.2. GE BEATRIZ HELENA

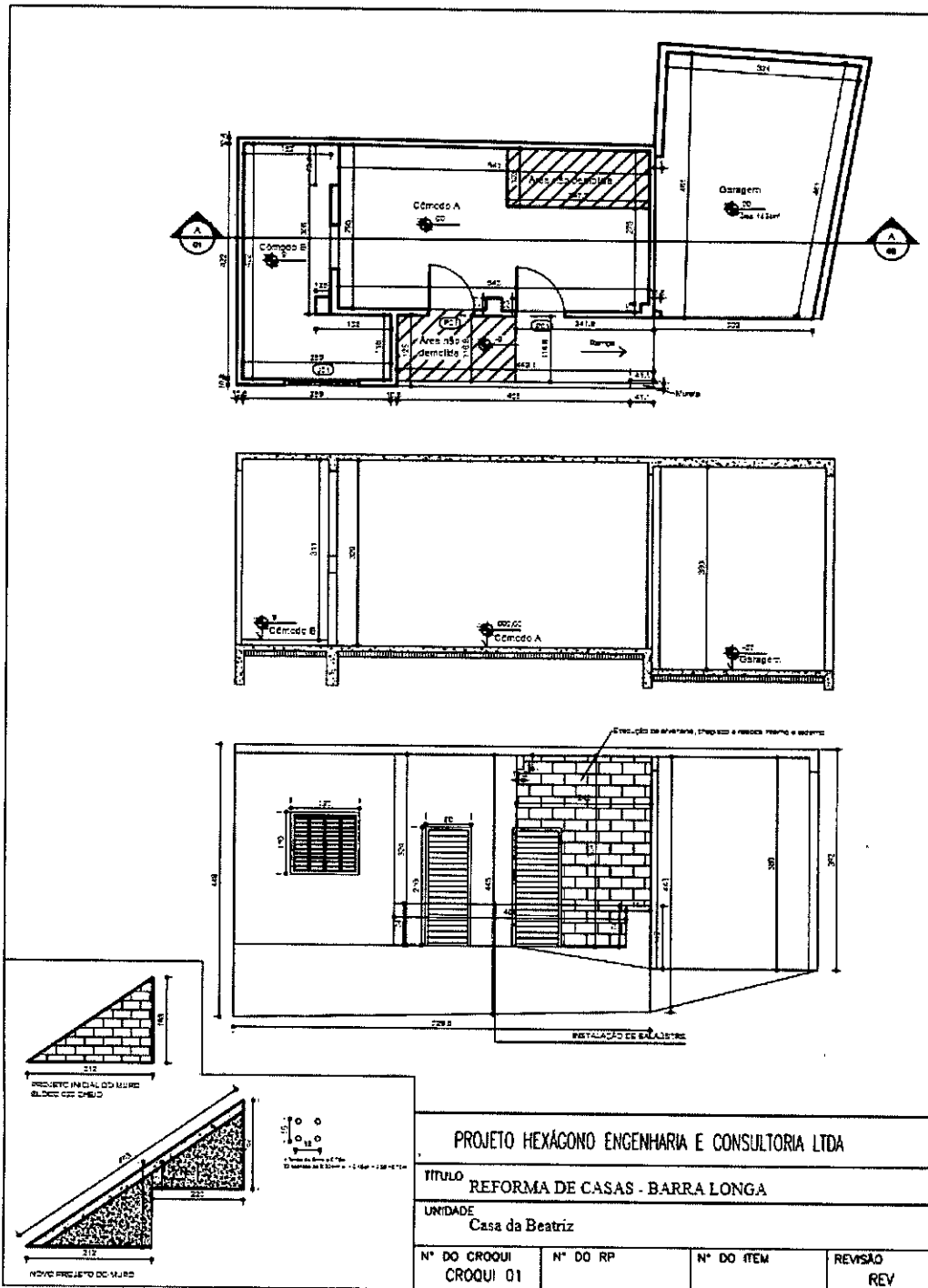

EM BRANCO

EM BRANCO

3.4.4. GE BAR PAULO HOLINO

BAR GESTEIRA

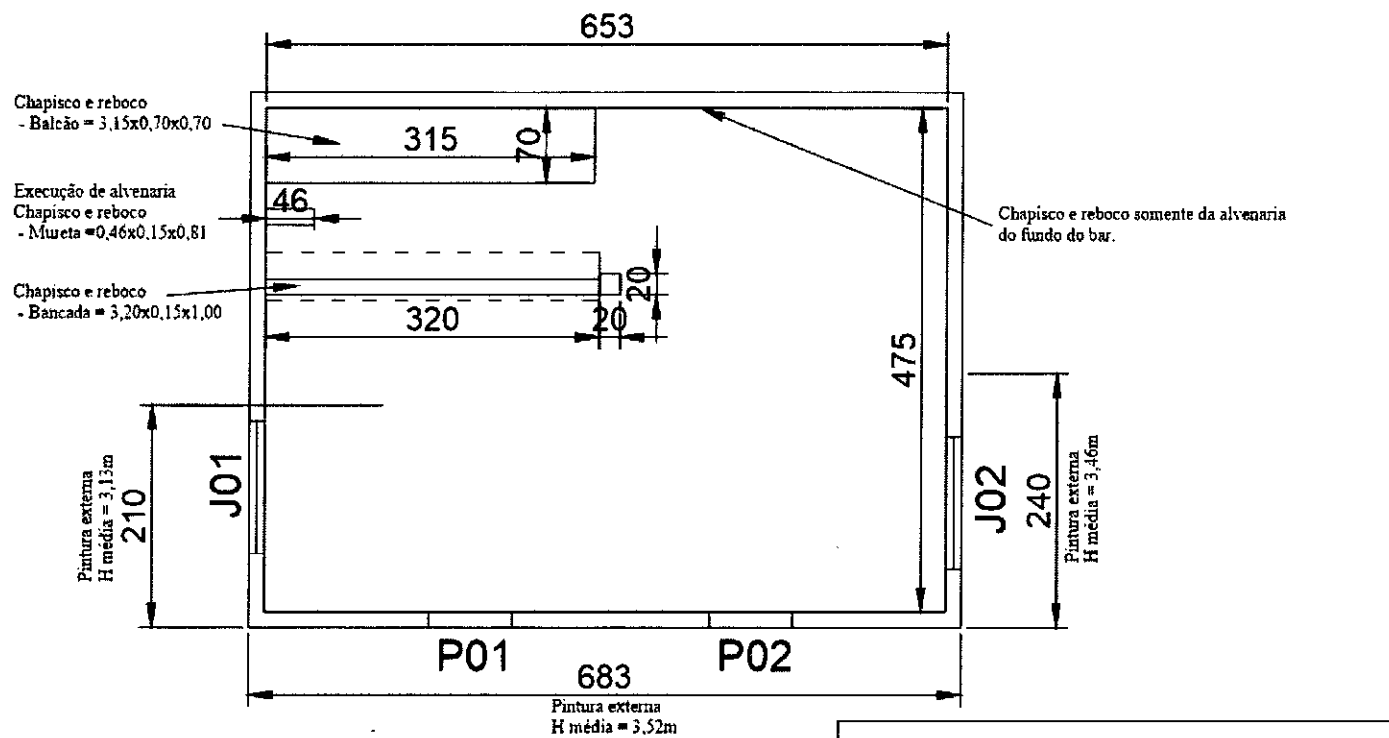

LEGENDA	
P01 = 80x210	J01 = 125x105
P02 = 80x210	J02 = 125x105
Pé Direito 3.05m	

PROJETO HEXÁGONO ENGENHARIA E CONSULTORIA LTDA			
TÍTULO REFORMA DE CASAS - BARRA LONGA			
UNIDADE BAR GESTEIRA			
Nº DO CROQUI CROQUI 01	Nº DO RP 23/02/2016	Nº DO ITEM	REVISÃO REV

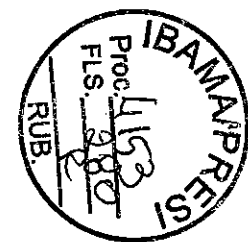

EM BRANCO



3.4.5. GE LADIR

CASA DA LADIR

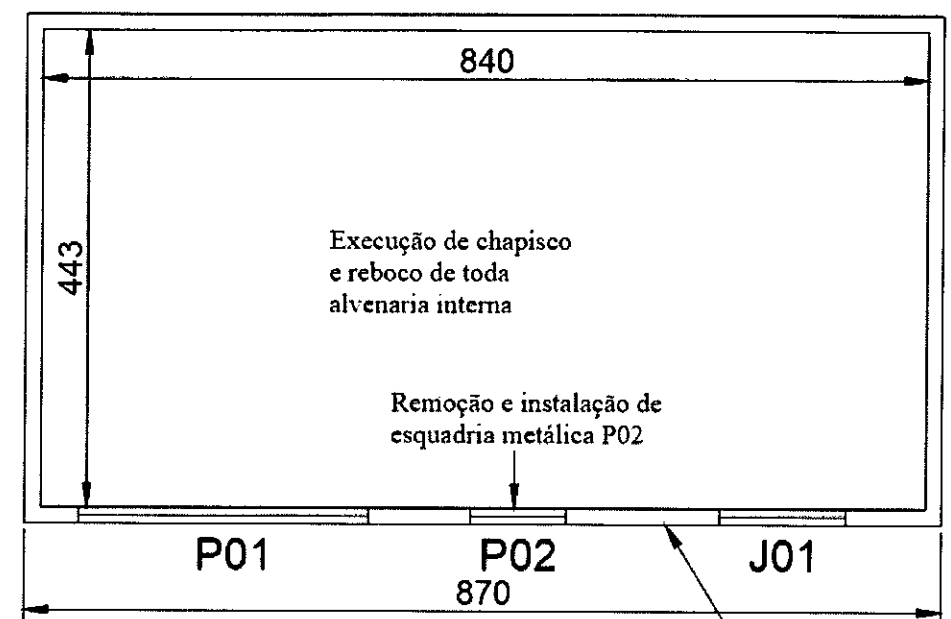

Execução de chapisco e reboco da alvenaria externa da parte da frente da casa.
h externo = 3,61m

LEGENDA	
P01 = 275x210	J01 = 120x100
P02 = 80x210	Pé Direito 3,20m

PROJETO HEXÁGONO ENGENHARIA E CONSULTORIA LTDA			
TÍTULO REFORMA DE CASAS - BARRA LONGA			
UNIDADE Casa da Ladir			
Nº DO CROQUI CROQUI 01	Nº DO RP 24/02/2016	Nº DO ITEM	REVISÃO REV

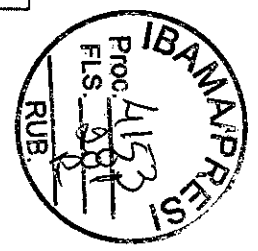

MEMBRANCO

3.4.6. GE DIRCEU

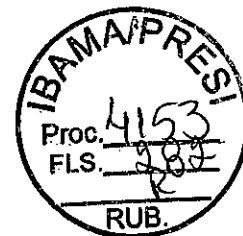

CASA DA DIRCEU

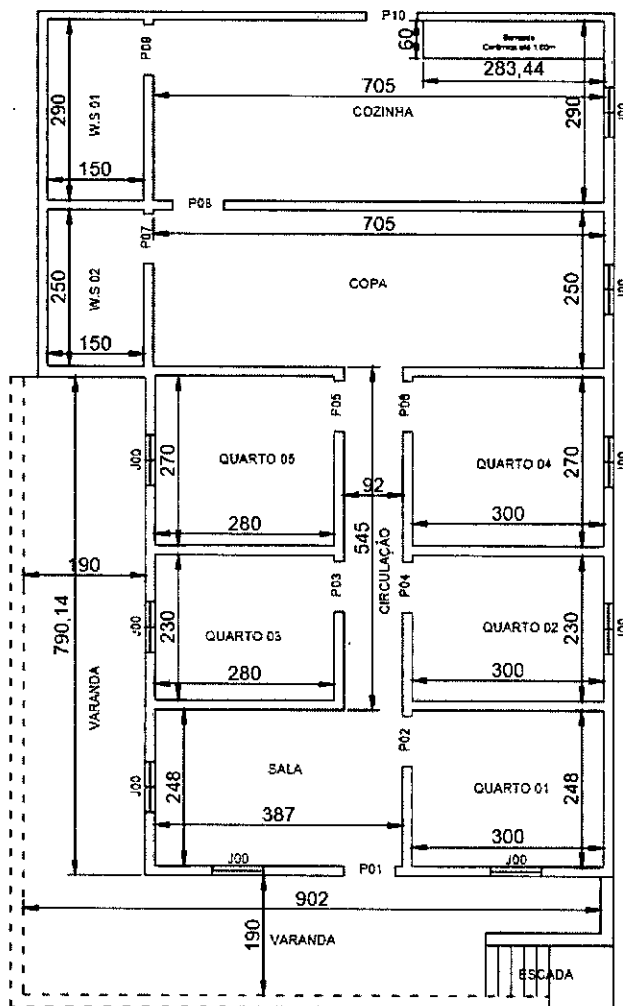

LEGENDA	
P01/P10 = 30x210	Pé Direito 2,55m
J00 = 120x100	

PROJETO HEXÁGONO ENGENHARIA E CONSULTORIA LTDA			
TÍTULO REFORMA DE CASAS - BARRA LONGA			
UNIDADE Casa da Dirceu			
Nº DO CROQUI CROQUI 01	Nº DO RP 26/02/2016	Nº DO ITEM	REVISÃO REV

FERRARINO